



# WÜRTH LOUIS AND COMPANY

## REV-A-SHELF 2026 PRODUCTS

### Table of Contents

|                                      |       |
|--------------------------------------|-------|
| Craftsman Walnut Collection .....    | 2-6   |
| 50QT Waste Container Pullouts .....  | 7     |
| 50QT Waste Bins & 35/50QT Lids ..... | 8     |
| Drip Trays.....                      | 9     |
| Wood Pilasters .....                 | 10-11 |



# CRAFTSMAN WALNUT BASE CABINET ACCESSORIES



**Craftsman Knife Organizer Pullouts**  
Walnut Solid Wood Construction w/Black Wire Accents  
& Blum Movento Soft-Close

| Item #             | MCO    | Includes     | Sale Price EA   |
|--------------------|--------|--------------|-----------------|
| RV448KBCCBCSCWN5MB | 5.25"W | (1) 1Qt. Bin | <b>\$469.09</b> |
| RV448KBCCBCSCWN8MB | 8.25"W | (1) 2Qt. Bin | <b>\$563.69</b> |



**Craftsman Utensil Org. Pullouts**  
Walnut Solid Wood Construction w/Black Wire Accents  
& Blum Movento Soft-Close

| Item #             | MCO    | Includes      | Sale Price EA   |
|--------------------|--------|---------------|-----------------|
| RV448UTCCBCSCWN5MB | 5.25"W | (4) 1Qt. Bins | <b>\$353.49</b> |
| RV448UTCCBCSCWN8MB | 8.25"W | (4) 2Qt. Bins | <b>\$412.99</b> |



**Craftsman Bakeware Org. Pullouts**  
Walnut Solid Wood Construction w/Black Wire Accents  
& Blum Movento Soft-Close

| Item #             | MCO    | Includes    | Sale Price EA   |
|--------------------|--------|-------------|-----------------|
| RV447CC-BCSCWN-5MB | 5.25"W | Adj. T-Bars | <b>\$272.09</b> |
| RV447CC-BCSCWN-8MB | 8.25"W | Adj. T-Bars | <b>\$304.59</b> |



**Craftsman Base Organizer Pullouts**  
Walnut Solid Wood Construction w/Black Wire Accents  
& Blum Movento Soft-Close

| Item #             | MCO    | Includes       | Sale Price EA   |
|--------------------|--------|----------------|-----------------|
| RV448CC-BCSCWN-5MB | 5.25"W | (1) Adj. Shelf | <b>\$366.99</b> |
| RV448CC-BCSCWN-8MB | 8.25"W | (1) Adj. Shelf | <b>\$424.29</b> |

**Offer valid: 5/15/26 - 7/10/26.** Please reference promo code **LP2365** when placing an order with Customer Service.  
For online orders, enter promo code **LP2365** in the promo code field of the shopping cart.

# CRAFTSMAN WALNUT WASTE CONTAINER PULLOUTS



**35Qt. Craftsman 1-Bin Waste Pullout**  
Walnut Solid Wood Construction w/Black Wire Accents  
& Blum Movento Soft-Close

| Item #            | MCO  | Bin           | Sale Price EA   |
|-------------------|------|---------------|-----------------|
| RV4WCCWN1535118MB | 12"W | (1) 35Qt. Blk | <b>\$350.69</b> |



**50Qt. Craftsman 1-Bin Waste Pullout**  
Walnut Solid Wood Construction w/Black Wire Accents  
& Blum Movento Soft-Close

| Item #            | MCO  | Bin           | Sale Price EA   |
|-------------------|------|---------------|-----------------|
| RV4WCCWN1550118MB | 12"W | (1) 50Qt. Blk | <b>\$362.69</b> |



**Craftsman 2-Bin Waste Pullouts**

Walnut Solid Wood Construction w/Black Wire Accents  
& Blum Movento Soft-Close

| Item #            | MCO  | Bin           | Sale Price EA   |
|-------------------|------|---------------|-----------------|
| RV4WCCWN1835218MB | 15"W | (2) 35Qt. Blk | <b>\$371.19</b> |
| RV4WCCWN1850218MB | 15"W | (2) 50Qt. Blk | <b>\$376.19</b> |



**Craftsman 4-Bin Waste Pullout**

Walnut Solid Wood Construction w/Black Wire Accents  
& Blum Movento Soft-Close

| Item #            | MCO  | Bin                      | Sale Price EA   |
|-------------------|------|--------------------------|-----------------|
| RV4WCCWN2432418MB | 21"W | (2) 32Qt /<br>(2) 8L Blk | <b>\$421.49</b> |

**Offer valid: 5/15/26 - 7/10/26.** Please reference promo code **LP2365** when placing an order with Customer Service.  
For online orders, enter promo code **LP2365** in the promo code field of the shopping cart.

# CRAFTSMAN GIRASOLO WALNUT BLIND CORNER PULLOUTS



## Craftsman Girasolo 1-Tray

Blind Corner Optimizer, Walnut w/Black Wire Accents

| Item #             | MCO  | Opening | Sale Price EA   |
|--------------------|------|---------|-----------------|
| RV4871CC-WN-12-LMB | 12"W | Left    | <b>\$276.55</b> |
| RV4871CC-WN-12-RMB | 12"W | Right   | <b>\$276.55</b> |
| RV4871CC-WN-15-LMB | 15"W | Left    | <b>\$294.48</b> |
| RV4871CC-WN-15-RMB | 15"W | Right   | <b>\$294.48</b> |
| RV4871CC-WN-18-LMB | 18"W | Left    | <b>\$300.00</b> |
| RV4871CC-WN-18-RMB | 18"W | Right   | <b>\$300.00</b> |



## Craftsman Girasolo 2-Trays

Blind Corner Optimizer, Walnut w/Black Wire Accents

| Item #            | MCO  | Opening | Sale Price EA   |
|-------------------|------|---------|-----------------|
| RV487CC-WN-12-LMB | 12"W | Left    | <b>\$513.79</b> |
| RV487CC-WN-12-RMB | 12"W | Right   | <b>\$513.79</b> |
| RV487CC-WN-15-LMB | 15"W | Left    | <b>\$542.76</b> |
| RV487CC-WN-15-RMB | 15"W | Right   | <b>\$542.76</b> |
| RV487CC-WN-18-LMB | 18"W | Left    | <b>\$548.97</b> |
| RV487CC-WN-18-RMB | 18"W | Right   | <b>\$548.97</b> |

### LEFT OPENING (blind right)

Shown with adjacent cabinet



### RIGHT OPENING (blind left)

Shown with adjacent cabinet

drawer/door cabinet

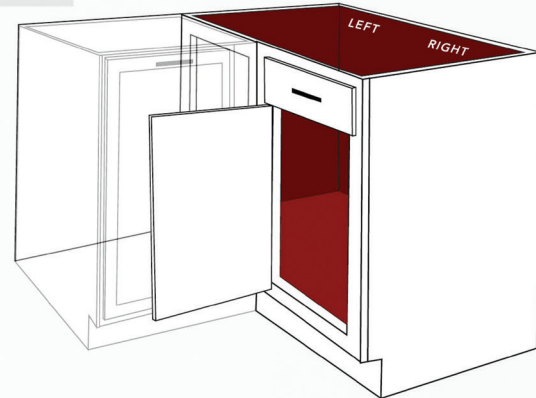
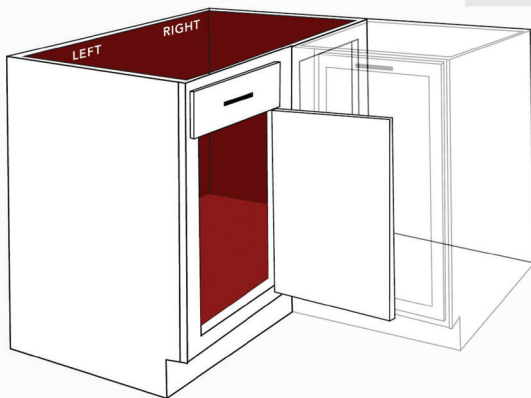

**Offer valid: 5/15/26 - 7/10/26.** Please reference promo code **LP2365** when placing an order with Customer Service.  
For online orders, enter promo code **LP2365** in the promo code field of the shopping cart.

# CRAFTSMAN WALNUT LAZY SUSANS & DRAWER INSERTS



## Craftsman Kidney Shaped Susans

Single Tray w/Swivel Bearing, Walnut w/Black Accents

| Item #             | Dimensions               | Sale Price EA   |
|--------------------|--------------------------|-----------------|
| RV4CC401-WN-28BSMB | 28"W x 26"D x 2.875"H    | <b>\$144.83</b> |
| RV4CC401-WN-32BSMB | 32"W x 29.44"D x 2.875"H | <b>\$175.17</b> |



- Silicone Non Slip Mat

## Craftsman Deep Drawer Inserts

Adjustable Dividers, Walnut w/Black Accents

| Item #            | Dimensions                 | Sale Price EA   |
|-------------------|----------------------------|-----------------|
| RV4WDIVCC-WN-24MB | 19.25"W x 19.81"D x 5.97"H | <b>\$163.45</b> |
| RV4WDIVCC-WN-30MB | 25.25"W x 19.81"D x 5.97"H | <b>\$204.83</b> |
| RV4WDIVCC-WN-36MB | 31.22"W x 19.81"D x 5.97"H | <b>\$245.52</b> |



- Silicone Non Slip Mat

## Craftsman Cutlery Tray Inserts

Walnut w/Black Accents

| Item #           | Dimensions                | Sale Price EA  |
|------------------|---------------------------|----------------|
| RV4WCTCC-WN-15MB | 10.25"W x 19.5"D x 2.34"H | <b>\$55.17</b> |
| RV4WCTCC-WN-18MB | 13.22"W x 19.5"D x 2.34"H | <b>\$65.52</b> |
| RV4WCTCC-WN-21MB | 16.22"W x 19.5"D x 2.34"H | <b>\$76.55</b> |
| RV4WCTCC-WN-24MB | 19.25"W x 19.5"D x 2.34"H | <b>\$87.59</b> |



- Silicone Non Slip Mat

## Craftsman Utensil Tray Inserts

Walnut w/Black Accents

| Item #           | Dimensions                | Sale Price EA  |
|------------------|---------------------------|----------------|
| RV4WUTCC-WN-15MB | 10.25"W x 19.5"D x 2.34"H | <b>\$49.66</b> |
| RV4WUTCC-WN-18MB | 13.22"W x 19.5"D x 2.34"H | <b>\$61.38</b> |
| RV4WUTCC-WN-21MB | 16.22"W x 19.5"D x 2.34"H | <b>\$73.79</b> |
| RV4WUTCC-WN-24MB | 19.25"W x 19.5"D x 2.34"H | <b>\$80.00</b> |

**Offer valid: 5/15/26 - 7/10/26.** Please reference promo code **LP2365** when placing an order with Customer Service.  
For online orders, enter promo code **LP2365** in the promo code field of the shopping cart.

# PAPER TOWEL DRAWERS & PRODUCE BASKETS



## Paper Towel Drawer Blum Tandem Runners

Walnut w/Blum Tandem Soft-Close

| Item #           | Designed For  | Finish | Sale Price EA   |
|------------------|---------------|--------|-----------------|
| RV4PTD-WN18HSC-1 | 18" Base Cab. | Walnut | <b>\$213.79</b> |



## Tiered Paper Towel Drawer Blum Tandem Runners

Walnut w/Blum Tandem Soft-Close & Cutters

| Item #           | Designed For  | Finish | Sale Price EA   |
|------------------|---------------|--------|-----------------|
| RV4PTD-WN18HSC-1 | 18" Base Cab. | Walnut | <b>\$262.76</b> |



## Produce Basket Pull-Out

Walnut / Stainless Steel

| Item #      | Designed For  | Finish    | Sale Price EA   |
|-------------|---------------|-----------|-----------------|
| RV4SSB-15WN | 15" Base Cab. | Walnut/SS | <b>\$157.59</b> |
| RV4SSB-18WN | 18" Base Cab. | Walnut/SS | <b>\$176.90</b> |



## Produce Basket Pull-Out

Walnut / Matte Black

| Item #         | Designed For  | Finish       | Sale Price EA   |
|----------------|---------------|--------------|-----------------|
| RV4SSB-15-WNMB | 15" Base Cab. | Walnut/M.Blk | <b>\$157.24</b> |
| RV4SSB-18-WNMB | 18" Base Cab. | Walnut/M.Blk | <b>\$175.17</b> |

**Offer valid: 5/15/26 - 7/10/26.** Please reference promo code **LP2365** when placing an order with Customer Service.  
For online orders, enter promo code **LP2365** in the promo code field of the shopping cart.

# 50QT WASTE CONTAINER PULLOUTS



## 4VLWCSC 2-Bin Waste Pullout

Birch Plywood w/Soft-Close

| Item #           | MCO    | Bin           | Sale Price EA   |
|------------------|--------|---------------|-----------------|
| RV4VLWCSC1850DM2 | 14.5"W | (2) 50Qt. Wht | <b>\$155.86</b> |



## 4WCBM 2-Bin Waste Pullout

Maple Plywood w/Rev-A-Motion Soft-Open/Soft-Close

| Item #         | MCO     | Bin              | Sale Price EA   |
|----------------|---------|------------------|-----------------|
| RV4WCBM1850DM2 | 14.25"W | (2) 50Qt. Silver | <b>\$252.41</b> |



## Craftsman 2-Bin Waste Pullout

Maple Solid Wood Construction w/Black Wire Accents & Blum Movento Soft-Close

| Item #           | MCO  | Bin           | Sale Price EA   |
|------------------|------|---------------|-----------------|
| RV4WCCC1850218MB | 15"W | (2) 50Qt. Blk | <b>\$272.41</b> |



## 4WCSC 2-Bin Waste Pullout

Maple Plywood Construction w/Black Wire Accents & Blum Movento Soft-Close

| Item #         | MCO  | Bin              | Sale Price EA   |
|----------------|------|------------------|-----------------|
| RV4WCSC1850DM2 | 15"W | (2) 50Qt. Silver | <b>\$267.24</b> |

**Offer valid: 5/15/26 - 7/10/26.** Please reference promo code **LP2365** when placing an order with Customer Service. For online orders, enter promo code **LP2365** in the promo code field of the shopping cart.

# 50QT WASTE BINS & 35/50QT LIDS



## 50Qt. Waste Bins Slimmer Design

Designed to Fit Only Rev-A-Shelf's 50Qt. Waste Pullouts

| Item #     | Size  | Color      | Sale Price EA |
|------------|-------|------------|---------------|
| RV50-11-96 | 50Qt. | White      | <b>\$7.59</b> |
| RV50-13-96 | 50Qt. | Orion Gray | <b>\$8.07</b> |
| RV50-14-96 | 50Qt. | Gray       | <b>\$8.07</b> |
| RV50-17-96 | 50Qt. | Silver     | <b>\$8.07</b> |
| RV50-18-96 | 50Qt. | Black      | <b>\$7.52</b> |

## NEW Bi-Directional Lids

Lids are Designed to Open in Either Direction

| Item #          | Designed For Bin Size | Color      | Sale Price EA  |
|-----------------|-----------------------|------------|----------------|
| RV3550-LID-11-1 | 35Qt. & 50Qt.         | White      | <b>\$10.00</b> |
| RV3550-LID-13-1 | 35Qt. & 50Qt.         | Orion Gray | <b>\$10.00</b> |
| RV3550-LID-14-1 | 35Qt. & 50Qt.         | Gray       | <b>\$10.00</b> |
| RV3550-LID-17-1 | 35Qt. & 50Qt.         | Silver     | <b>\$10.00</b> |
| RV3550-LID-18-1 | 35Qt. & 50Qt.         | Black      | <b>\$10.00</b> |
| RV3550-LID-19-1 | 35Qt. & 50Qt.         | Green      | <b>\$10.00</b> |
| RV3550-LID-22-1 | 35Qt. & 50Qt.         | Blue       | <b>\$10.00</b> |

Offer valid: 5/15/26 - 7/10/26. Please reference promo code **LP2365** when placing an order with Customer Service.

For online orders, enter promo code **LP2365** in the promo code field of the shopping cart.

# DRIP TRAYS



## Kitchen Drip Tray - Rigid

Trim-to-Fit, 23.25"Depth x 0.75"Height

| Item #           | Size   | Color | Sale Price EA  |
|------------------|--------|-------|----------------|
| RVSBDT-2730-11-1 | 28.5"W | White | <b>\$31.03</b> |
| RVSBDT-3336-11-1 | 34.5"W | White | <b>\$35.71</b> |
| RVSBDT-3942-11-1 | 40.5"W | White | <b>\$39.31</b> |



## Kitchen Drip Tray - Flexible

Trim-to-Fit, 23.25"Depth x 0.75"Height

| Item #           | Size   | Color  | Sale Price EA  |
|------------------|--------|--------|----------------|
| RVSBDF-2730-11-1 | 28.5"W | White  | <b>\$30.34</b> |
| RVSBDF-2730-15-1 | 28.5"W | Almond | <b>\$30.34</b> |
| RVSBDF-3336-11-1 | 34.5"W | White  | <b>\$35.86</b> |
| RVSBDF-3336-15-1 | 34.5"W | Almond | <b>\$35.86</b> |
| RVSBDF-3942-11-1 | 40.5"W | White  | <b>\$38.97</b> |
| RVSBDF-3942-15-1 | 40.5"W | Almond | <b>\$38.97</b> |



## Vanity Drip Tray - Rigid

Trim-to-Fit, 20.25"Depth x 0.75"Height

| Item #            | Size   | Color | Sale Price EA  |
|-------------------|--------|-------|----------------|
| RVSBVDT-2124-11-1 | 22.5"W | White | <b>\$28.28</b> |
| RVSBVDT-2730-11-1 | 28.5"W | White | <b>\$31.38</b> |
| RVSBVDT-3336-11-1 | 34.5"W | White | <b>\$35.17</b> |



## Vanity Drip Tray - Flexible

Trim-to-Fit, 20.25"Depth x 0.75"Height

| Item #             | Size   | Color  | Sale Price EA  |
|--------------------|--------|--------|----------------|
| RVSBVDTF-2124-11-1 | 22.5"W | White  | <b>\$27.93</b> |
| RVSBVDTF-2124-15-1 | 22.5"W | Almond | <b>\$27.93</b> |
| RVSBVDTF-2730-11-1 | 28.5"W | White  | <b>\$30.34</b> |
| RVSBVDTF-2730-15-1 | 28.5"W | Almond | <b>\$30.34</b> |
| RVSBVDTF-3336-11-1 | 34.5"W | White  | <b>\$34.14</b> |
| RVSBVDTF-3336-15-1 | 34.5"W | Almond | <b>\$34.14</b> |

**Offer valid: 5/15/26 - 7/10/26.** Please reference promo code **LP2365** when placing an order with Customer Service.  
For online orders, enter promo code **LP2365** in the promo code field of the shopping cart.

# PILASTERS

## 4PIL Wood Pilaster System - Sold Per Set



- Bracket adds 1/4" width to each side (1/2" overall)
- \*\* = 54.4"H Pilasters are (2) 27.2"H pilasters stacked upon each other
- (4) Brackets are needed per drawer box
- **Drawer boxes and drawer slides are not included**

| Item #          | Pilaster Size       | SET INCLUDES  |              | Designed to Build | Sale Price ST   |
|-----------------|---------------------|---------------|--------------|-------------------|-----------------|
|                 |                     | Pilasters Qty | Brackets Qty |                   |                 |
| RV4PIL-20-088-1 | 19.625"H x .875"W   | 4             | 8            | 2-Drawer System   | <b>\$49.45</b>  |
| RV4PIL-20-113-1 | 19.625"H x 1.125"W  | 4             | 8            | 2-Drawer System   | <b>\$53.79</b>  |
| RV4PIL-20-238-1 | 19.625"H x 2.375"W  | 4             | 8            | 2-Drawer System   | <b>\$66.41</b>  |
| RV4PIL-27-088-1 | 27.2"H x .875"W     | 4             | 12           | 3-Drawer System   | <b>\$58.41</b>  |
| RV4PIL-27-113-1 | 27.2"H x 1.125"W    | 4             | 12           | 3-Drawer System   | <b>\$63.38</b>  |
| RV4PIL-27-238-1 | 27.2"H x 2.375"W    | 4             | 12           | 3-Drawer System   | <b>\$83.66</b>  |
| RV4PIL-43-088-1 | 42.32"H x .875"W    | 4             | 16           | 4-Drawer System   | <b>\$100.90</b> |
| RV4PIL-43-113-1 | 42.32"H x 1.125"W   | 4             | 16           | 4-Drawer System   | <b>\$106.28</b> |
| RV4PIL-43-238-1 | 42.32"H x 2.375"W   | 4             | 16           | 4-Drawer System   | <b>\$143.03</b> |
| RV4PIL-50-088-1 | 49.88"H x .875"W    | 4             | 20           | 5-Drawer System   | <b>\$113.03</b> |
| RV4PIL-50-113-1 | 49.88"H x 1.125"W   | 4             | 20           | 5-Drawer System   | <b>\$119.24</b> |
| RV4PIL-50-238-1 | 49.88"H x 2.375"W   | 4             | 20           | 5-Drawer System   | <b>\$161.93</b> |
| RV4PIL-58-088-1 | 57.44"H x .875"W    | 4             | 24           | 6-Drawer System   | <b>\$124.48</b> |
| RV4PIL-58-113-1 | 57.44"H x 1.125"W   | 4             | 24           | 6-Drawer System   | <b>\$132.55</b> |
| RV4PIL-58-238-1 | 57.44"H x 2.375"W   | 4             | 24           | 6-Drawer System   | <b>\$180.00</b> |
| RV4PIL-54-088-1 | ** 54.4"H x .875"W  | 8             | 20           | 5-Drawer System   | <b>\$101.79</b> |
| RV4PIL-54-113-1 | ** 54.4"H x 1.125"W | 8             | 20           | 5-Drawer System   | <b>\$117.17</b> |
| RV4PIL-54-238-1 | ** 54.4"H x 2.375"W | 8             | 20           | 5-Drawer System   | <b>\$149.72</b> |

**NEW SIZE**  
**42.32"H**

**NEW SIZE**  
**49.88"H**

**NEW SIZE**  
**57.44"H**



**Offer valid: 5/15/26 - 7/10/26.** Please reference promo code **LP2365** when placing an order with Customer Service.  
For online orders, enter promo code **LP2365** in the promo code field of the shopping cart.

# PILASTERS



## 4PIL Wood Pilaster System - Sold Per Set, Minimum Order Qty 10 Sets

- Bracket adds 1/4" width to each side (1/2" overall)
- \*\* = 54.4"H Pilasters are (2) 27.2"H pilasters stacked upon each other
- (4) Brackets are needed per drawer box
- **Drawer boxes are not included**

| Item #           | Pilaster Size       | SET INCLUDES  |              | Designed to Build     | Sale Price ST   |
|------------------|---------------------|---------------|--------------|-----------------------|-----------------|
|                  |                     | Pilasters Qty | Brackets Qty |                       |                 |
| RV4PIL-20-088-10 | 19.625"H x .875"W   | 4             | 8            | (10) 2-Drawer Systems | <b>\$46.48</b>  |
| RV4PIL-20-113-10 | 19.625"H x 1.125"W  | 4             | 8            | (10) 2-Drawer Systems | <b>\$51.38</b>  |
| RV4PIL-20-238-10 | 19.625"H x 2.375"W  | 4             | 8            | (10) 2-Drawer Systems | <b>\$64.14</b>  |
| RV4PIL-27-088-10 | 27.2"H x .875"W     | 4             | 12           | (10) 3-Drawer Systems | <b>\$54.69</b>  |
| RV4PIL-27-113-10 | 27.2"H x 1.125"W    | 4             | 12           | (10) 3-Drawer Systems | <b>\$61.04</b>  |
| RV4PIL-27-238-10 | 27.2"H x 2.375"W    | 4             | 12           | (10) 3-Drawer Systems | <b>\$80.69</b>  |
| RV4PIL-54-088-10 | ** 54.4"H x .875"W  | 8             | 20           | (10) 5-Drawer Systems | <b>\$96.35</b>  |
| RV4PIL-54-113-10 | ** 54.4"H x 1.125"W | 8             | 20           | (10) 5-Drawer Systems | <b>\$112.76</b> |
| RV4PIL-54-238-10 | ** 54.4"H x 2.375"W | 8             | 20           | (10) 5-Drawer Systems | <b>\$144.14</b> |



## 4PIL Wood Pilaster Only - Sold Per Box

- Bracket sold separately

| Item #            | Pilaster Size      | Pilasters Qty | Sale Price BX   |
|-------------------|--------------------|---------------|-----------------|
| RV4PILU-20-088-40 | 19.625"H x .875"W  | 40            | <b>\$361.38</b> |
| RV4PILU-20-113-40 | 19.625"H x 1.125"W | 40            | <b>\$402.76</b> |
| RV4PILU-20-238-40 | 19.625"H x 2.375"W | 40            | <b>\$515.86</b> |
| RV4PILU-27-088-40 | 27.2"H x .875"W    | 40            | <b>\$402.76</b> |
| RV4PILU-27-113-40 | 27.2"H x 1.125"W   | 40            | <b>\$446.90</b> |
| RV4PILU-27-238-40 | 27.2"H x 2.375"W   | 40            | <b>\$620.69</b> |
| RV4PILU-43-088-20 | 42.32"H x .875"W   | 20            | <b>\$353.10</b> |
| RV4PILU-43-113-20 | 42.32"H x 1.125"W  | 20            | <b>\$380.69</b> |
| RV4PILU-43-238-20 | 42.32"H x 2.375"W  | 20            | <b>\$548.97</b> |
| RV4PILU-50-088-20 | 49.88"H x .875"W   | 20            | <b>\$393.10</b> |
| RV4PILU-50-113-20 | 49.88"H x 1.125"W  | 20            | <b>\$422.07</b> |
| RV4PILU-50-238-20 | 49.88"H x 2.375"W  | 20            | <b>\$617.93</b> |
| RV4PILU-58-088-20 | 57.44"H x .875"W   | 20            | <b>\$427.59</b> |
| RV4PILU-58-113-20 | 57.44"H x 1.125"W  | 20            | <b>\$463.45</b> |
| RV4PILU-58-238-20 | 57.44"H x 2.375"W  | 20            | <b>\$682.76</b> |

**NEW SIZE  
42.32"H**

**NEW SIZE  
49.88"H**

**NEW SIZE  
57.44"H**



## 4PIL Brackets ONLY (4 Brackets = 1 Set)

| Item #         | Designed to Hold | Brackets Qty | Sale Price ST |
|----------------|------------------|--------------|---------------|
| RV4PIL-HDW-1   | 1-Drawer         | 4            | <b>\$6.21</b> |
| RV4PIL-HDW-10  | 10-Drawers       | 40           | <b>\$5.52</b> |
| RV4PIL-HDW-160 | 160-Drawers      | 640          | <b>\$3.89</b> |

**Offer valid: 5/15/26 - 7/10/26.** Please reference promo code **LP2365** when placing an order with Customer Service.

For online orders, enter promo code **LP2365** in the promo code field of the shopping cart.



# WÜRTH LOUIS AND COMPANY

## REV-A-SHELF 2026 NEW PRODUCTS

### Würth Louis and Company

895 Columbia Street  
Brea, CA 92821  
(714) 529-1771  
(800) 422-4389  
Fax: (800) 446-9452  
[www.wurthlac.com](http://www.wurthlac.com)

Source Code: LP2365

### Other locations:

Anaheim, CA  
Benton, AR  
Boise, ID  
Denver, CO  
Grand Prairie, TX  
Houston, TX  
Huntington Park, CA

Idaho Falls, ID  
Las Vegas, NV  
Oklahoma City, OK  
Phoenix, AZ  
Portland, OR  
Post Falls, ID

Salt Lake City, UT  
San Antonio, TX  
San Marcos, CA  
St. George, UT  
Sumner, WA  
West Jordan, UT