

SECTION M - TABLE OF CONTENTS

Section M Contents:

Festool Conturo Edgebanding Systems2-3
 Doellken/Woodtape PVC Edgebanding.. 4
 PRO Veneer Sheets & Edgebanding.....5-9
 Formwood Veneer Sheets & Edgebanding..... 10-16
 Fastcap PVC/Real Wood Edgebanding 17
 Edgebanding Tools 18
 Patwin Tee Moldings.....19
 Patwin Bumper Moldings & U-Channels20

CONTURO KA 65 Edge Bander



The Perfect Edge

With the CONTURO Edge Bander, it's just as easy to apply edge banding on the job site as it is in the shop. Even if you have a large stationary edge banding machine, the CONTURO can complement your edge banding process by giving you a way to work with radii, circular pieces, bevels and small pieces.

The CONTURO offers exceptional ergonomic design, including dual speeds, and a unique patented hot melt glue adhesive system. There's no risk of burns because the glue system is thermally isolated.

Ditch the iron or hot air gun and gain the benefits of a dedicated edge banding machine without the cost associated with stationary equipment.

- Inexpensive compared to alternatives like stationary edge banding machines
- Capable of edge banding curves, circles, convex and concave radii and inside corners
- Electronically controlled precision glue distribution system for maximum adhesion
- Compact, portable, ergonomic design for easy use and flexibility
- Optional table mounting for working with small work pieces

When used in combination with the MFK 700 Edge Trimming Router, MFT/3 CONTURO Edge Banding Station and other system components of the Festool edge banding solution, you can provide your clients with exceptional results.

A
B
C
D
E
F
G
H
I
J
K
L
M
N
O
P
Q
R
S
T
U
V
W
X
Y



A
B
C
D
E
F
G
H
I
J
K
L
M
N
O
P
Q
R
S
T
U
V
W
X
Y

FESTOOL CONTURO

FESTOOL



FST574616
Edge Bander/Edge Trimming Set



Festool Conturo Edge Banding System

- With the CONTURO Edge Bander, it's just as easy to apply edge banding on the job site as it is in the shop. Even if you have a large stationary edge banding machine, the CONTURO can complement your edge banding process by giving you a way to work with radii, circular pieces, bevels and small pieces
- The CONTURO offers exceptional ergonomic design, including dual speeds, and a unique hot melt glue adhesive system. There's no risk of burns because the glue system is thermally isolated
- The CONTURO Edge Bander takes approximately 8-10 minutes to be ready to go from a cold start. That means you spend more time applying edge banding and less time waiting. Quick, simple processes for changing edge banding or adhesive make the CONTURO a highly productive machine
- With the optional CONTURO MFT/3 Table (sold separately), you can convert the CONTURO into an edge banding station. Perfect for working on small pieces that would otherwise be hard to navigate with the CONTURO in its handheld configuration. The station is also well-suited for working with beveled edges
- The CONTURO can be installed into the table in a few seconds, then removed again for a quick transition between handheld and stationary use
- Ditch the iron or hot air gun and gain the benefits of a dedicated edge banding machine without the cost associated with stationary equipment

| Item # | Description |
|-----------|---|
| FST574609 | Edge Bander complete with Support Handle / Guide Table and 4X Natural EVA Adhesive in a Systainer SYS 4 T-LOC |
| FST500177 | Edge Trimming Set includes Edge Banding Reel, Additional Roller, Edge Banding Trimmer, Scraper, StickFix Base Kit with 3x Felt Pad, 5x Polishing Felt, 20x Abrasive Sheets StickFix Brilliant 2 80 x 133 P320, Hand-Sanding Block 80 x 133 mm, 5x StickFix Sanding Cloth S 800 in a Systainer SYS 4 T-LOC |
| FST574616 | Edge Bander / Edge Trimming Set bundle. Includes all items listed In FST574609 and FST500177 |
| FST200059 | Brown Adhesive, 374° F (190° C) Heat Setting, 48/box (Sold by the box) |
| FST200060 | Black Adhesive, 374° F (190° C) Heat Setting, 48/box (Sold by the box) |
| FST499812 | Natural Adhesive, 374° F (190° C) Heat Setting, 48/box (Sold by the box) |

FESTOOL CONTURO

Festool Conturo Edgebanding System Accessories



MFK 700 EQ/B Precision Trim Router

- The perfect edge demands professional finish results and the MFK 700 EQ/B helps deliver those results through precision depth control and smooth running operation. Form edges on nearly any type of material thanks to the variable speed control which helps to prevent melting and burning of sensitive material like PVC and exotic woods
- The router base is extremely wide for improved stability in edge forming applications, working near an edge, or working on narrow stock. The MFK 700 Trim Router features depth of cut micro-adjustment with increments of 1/256th of an inch with each tick on the knob. Precision micro-adjustment means that you can dial in the perfect height for the router bit, which reduces rework and finishing
- Achieve remarkably smooth and flush edges on your workpiece in record time. Making adjustments to the MFK 700 Trim Router is quick and easy with its tool-free design. Quick router bit changes can be done with the spindle lock, which means you only need a single wrench

| Item # | Description |
|-----------|---|
| FST574456 | Precision Trim Router |
| FST499811 | 1mm Radius Router Bit, 28mm dia; 3mm cut length |
| FST499810 | 1.5mm Radius Router Bit, 28mm dia; 3mm cut length |
| FST499809 | 2mm Radius Router Bit, 28mm dia; 3mm cut length |
| FST499808 | 3mm Radius Router Bit, 28mm dia; 3mm cut length |
| FST500368 | Plane Router Bit, 28mm dia; 7mm cutting length |



MFT/3 Stationary Table

- Do you edge band a lot of small pieces or bevels? Combine the CONTURO Edge Bander with the Festool MFT/3 Work Table to process small work pieces and to edge band bevels. The CONTURO can be quickly inserted and removed from the work table without any tools. The mounting bracket has preset detents for common angles
- Applying edge banding to beveled pieces is a breeze with the CONTURO MFT/3 Table
- FST500869 set includes Table, Table Insert, Adapter Plate, Guide Plates (15x), and Cross Members. Perfect for small pieces that would otherwise be difficult to work on with the handheld CONTURO alone
- For those who already have the MFT/3 table, accessories listed below can be purchased to make your MFT/3 compatible with the CONTURO

| Item # | Description |
|-----------|---|
| FST500869 | MFT/3 CONTURO Table Set (includes table and all accessories listed below) |
| FST500366 | Table Insert |
| FST500175 | Adapter Plate |
| FST500367 | Guide Plates (15x) |

A
B
C
D
E
F
G
H
I
J
K
L
M
N
O
P
Q
R
S
T
U
V
W
X
Y

A
B
C
D
E
F
G
H
I
J
K
L
M
N
O
P
Q
R
S
T
U
V
W
X
Y

PVC EDGEBANDING



Dollken-Woodtape PVC Edgebanding



| Item # | Color |
|--|-----------------------|
| 15/16" W x .018" Thick - 600' per Roll | |
| WD1427 | Paintable |
| WD2001 | White |
| WD2002 | Classic White |
| WD2022 | Ultra White |
| WD2027 | Brite White |
| WD2114 | Almond |
| WD2416 | Black |
| WD2425 | Fog Gray |
| WD2454 | Folkstone |
| WD2478 | Storm |
| WD3096 | Nutmeg |
| WD3728 | Riveria Maple |
| WD3922 | Fusion Maple |
| WD4125 | Hard Rock Maple |
| WD4301 | Hard Rock Maple |
| WD4469 | Kensing Maple |
| WD4763 | Chocolate Peartree |
| WD5232 | Regency Walnut |
| WD5890 | Tuxedo |
| WD7925 | Designer White |
| WD8820 | Natural Maple |
| 15/16" W x .020" Thick - 600' per Roll | |
| WD2002AA | Classic White |
| WD30175AAM | Phantom Charcoal |
| WD8189E5 | Warehouse Oak |
| WD8298AA | White Ash Woodbrush |
| WD8300AA | Natural Ash Woodbrush |
| WD8707 | Walnut Heights |
| WD8711 | Studio Teak |
| 1-5/16" W x .020" Thick - 600' per Roll | |
| WD2001-1-5/16 | White |
| WD2002-1-5/16 | Classic White |
| WD2114-1-5/16 | Almond |
| WD2416-1-5/16 | Black |
| WD4125-1-5/16 | Hard Rock Maple |
| WD6403-1-5/16 | Satin Stainless |
| WD7717-1-5/16 | Brite White |

| Item # | Color |
|---|-----------------------------|
| 15/16" W x 1mm Thick - 328' per Roll | |
| WD1M2001-15/16 | White |
| WD1M2002-15/16 | Classic White |
| WD1M2114-15/16 | Almond |
| WD1M2416-15/16 | Black |
| WD1M2425-15/16 | Fog |
| WD1M2425-15/16-FE | Dove Gray Fusion Edge |
| WD1M2431-15/16 | Slate Gray |
| WD1M2454-15/16 | Folkstone |
| WD1M2477-15/16 | North Sea |
| WD1M2495-15/16 | Pepperdust |
| WD1M2495-15/16-FE | Pepperdust Fusion Edge |
| WD1M3728-15/16 | Riveria Maple |
| WD1M4125-15/16 | Hard Rock Maple |
| WD1M4763-15/16 | Chocolate Peartree |
| WD1M4901-15/16 | Hard Rock Maple |
| WD1M5890-15/16 | Tuxedo |
| WD1M5963-15/16 | Columbian Walnut |
| WD1M6403-15/16 | Satin Stainless |
| WD1M7717-15/16 | Brite White |
| WD1M8536AAM-15/16 | Rustic Oak |
| WD1M9345-15/16 | Designer White |
| 15/16" W X 2mm Thick - 328' per Roll | |
| WD2M2001-15/16 | White |
| WD2M2416-15/16 | Black |
| WD2M4125P-15/16 | Hard Rock Maple (Print) |
| WD2M3D700R-1-5/16 | Brushed Aluminum |
| WD2M2425-15/16 | Fog |
| 15/16" W x 3mm Thick - 328' per Roll | |
| WD3M2001-15/16 | White |
| WD3M2002-15/16 | Classic White |
| WD3M2114-15/16 | Almond |
| WD3M2115-15/16 | Antique White |
| WD3M2416-15/16 | Black |
| WD3M2425-15/16 | Fog Gray |
| WD3M3728W-15/16 | Riveria Maple (Woodcore) |
| WD3M4469W-15/16 | Kensington Maple (Woodcore) |
| WD3M5963P-15/16 | Columbian Walnut (Print) |
| WD3M7717-15/16 | Brite White Fusion Edge |

WOOD VENEER SHEETS

Veneer Sheets, 10mil Paper Backed



- Grade A Face
- Excellent Joinery and Precision Sanding
- FSC Available on Special Order (Not all Species Available in FSC)
- Sold by the sheet

| Species | 2' x 8' Item # | 4' x 8' Item # | 4' x 10' Item # | 8' x 4' Item # |
|---------------------------|----------------|------------------|-----------------|----------------|
| African Mahogany, Ribbon | - | PROWDMHRBAF4X8 | - | - |
| Rustic Alder Sound Tight | - | PROWDALDSND4X8 | - | - |
| Alder True Clear | - | PROWDALD4X8 | - | - |
| Anigre | - | PROWDANQTD4X8 | - | - |
| Beech, Quartered | - | PROWDSBCHQTD4X8 | - | - |
| Beech, Steamed | - | - | - | PROWDSTMB8X4 |
| Birdseye Maple | - | PROWDMPBIRD4X8 | - | - |
| Birdseye Maple, Heavy | - | PROWDBM4X8 | - | - |
| Bubinga Plain Slice Heart | - | PROWDRSAFRBUB4X8 | - | - |
| Cherry | PROWD2X8 | PROWDCR4X8 | PROWDCH4X10 | - |
| Cherry, Cross Grain | - | - | - | PROWDCHXGRN8X4 |
| Cherry, HPVA | - | PROWDCHPREM4X8 | - | - |
| Cherry, Quartered | - | PROWDCHQTR4X8 | - | - |
| Clear Pine | - | PROWDPNCLR4X8 | - | - |
| Hickory | - | PROWDHK4X8 | - | - |
| Rustic Knotty Alder | - | PROWDKALD4X8 | - | - |
| Rustic Knotty Pine | - | PROWDKP4X8 | - | - |
| Mahogany | - | PROWDMAHKAY4X8 | - | - |
| Maple | PROWDM2X8 | PROWDM4X8 | PROWDM4X10 | - |
| Maple, Cross Grain | - | - | - | PROWDMPXGR8X4 |
| Maple, HPVA | - | PROWDMPPREM4X8 | - | - |
| Maple, Quartered | - | PROWDMPQTR4X8 | - | - |
| Red Oak | PROWDRO2X8 | PROWDRO4X8 | PROWDRO4X10 | - |
| Red Oak, HPVA | - | PROWDROPREM4X8 | - | - |
| Red Oak, Quartered | - | PROWDROQTRHF4X8 | - | - |
| Red Oak, Rift | - | PROWDRO4X8 | - | - |
| Teak | - | PROWDTEAK4X8 | - | - |
| VG Fir | - | PROWDFIRVG4X8 | - | - |
| Walnut | PROWDWA2X8 | PROWDWA4X8 | - | - |
| Walnut, HPVA | - | PROWDWLPREM4X8 | - | - |
| Wenge, Quartered | - | PROWDWENQTR4X8 | - | - |
| White Ash | PROWDA2X8 | - | - | - |
| White Birch | PROWDWB2X8 | PROWDWB4X8 | - | - |
| White Birch, Rotary | - | PROWDBRWHRTY4X8 | - | - |
| White Oak | PROWDWO2X8 | PROWDWO4X8 | - | - |
| White Oak, Quartered | - | PROWDWHOKQTR4X8 | - | - |
| White Oak, Rift | - | PROWDWHOKRIFT4X8 | - | - |
| Zebrawood | - | PROWDZEBWOOD4X8 | - | - |

A
B
C
D
E
F
G
H
I
J
K
L
M
N
O
P
Q
R
S
T
U
V
W
X
Y

A EDGEBANDING AND VENEER SHEETS

B
C
D
E
F
G
H
I
J
K
L
M
N
O
P
Q
R
S
T
U
V
W
X
Y



Allwood (Wood to Wood) Veneer Sheets



- Grade A Face
- Excellent Joinery and Precision Sanding
- FSC Available on Special Order (Not all Species Available in FSC)

| Species | 4' x 8' Item # |
|-------------------|-----------------|
| Alder | PROWDWTWRALD4X8 |
| Cherry | PROWDWTWCR4X8 |
| Red Birch | PROWDPALWBR4X8 |
| Red Oak | PROWDWTWRO4X8 |
| Rustic Alder | PROWDWTWKALD4X8 |
| Sapeli, Quartered | PROWDSAPQTR4X8 |
| Walnut | PROWDPALWWL4X8 |
| White Oak | PROWDPALWHOK4X8 |
| White Maple | PROWDWTWM4X8 |



Veneer Sheets, PSA



- 3M pressure sensitive adhesive
- Grade A Face
- Excellent Joinery and Precision Sanding
- FSC Available on Special Order (Not all Species Available in FSC)

| Species | 2' x 8' Item # | 4' x 8' Item # |
|-------------|----------------|----------------|
| Cherry | PROWDPCRPS2X8 | - |
| Clear Alder | PROWDAL2X8PSA | - |
| Maple | PROWDMPS2X8 | PROWDMPS4X8 |



Melamine Paper Edgebanding, Preglued



- 50' or 250' rolls Tech Edge Melamine with EVA Hot Melt Adhesive Back
- Smooth or Textured Finish

| Color | Finish | Item # |
|------------------|----------|----------------|
| 50' Roll | | |
| Black | Smooth | PROWDPB1316S |
| White | Textured | PROWDPWHT1316S |
| 250' Roll | | |
| Black | Smooth | PROWDPB1316 |
| Light Gray | Textured | PROWDPLGR1316 |
| Hardrock Maple | Smooth | PROWDPHM1316 |
| White | Smooth | PROWDPWHT1316 |
| White | Textured | PROWDPTWHT1316 |

WOOD VENEER EDGEBOARDING



Pre-Glued Wood Veneer Edgbanding



- Backed with EVA Hot Melt Adhesive
- Staggered finger joints
- FSC Available on Special Order

| Species | 50' Roll Item # | 250' Roll Item # |
|----------------------------------|-----------------|-------------------|
| Prefinished - 13/16" Wide | | |
| Maple | - | PROWDPFMAP1316PG |
| White Birch | - | PROWDPFWB1316PG |
| Unfinished - 5/8" Wide | | |
| Maple | - | PROWDM58PG |
| Red Oak | - | PROWDRO58 |
| Unfinished - 3/4" Wide | | |
| Alder | - | PROWDALD34 |
| Ash | - | PROWDAS34 |
| Cherry | - | PROWD34 |
| Mahogany | - | PROWDMH34 |
| Maple | - | PROWDM34 |
| Walnut | - | PROWDWA34 |
| White Birch | - | PROWDWB34 |
| Unfinished - 13/16" Wide | | |
| Alder | PROWDALD1316S | PROWDALD1316 |
| Ash | - | PROWDAS1316 |
| Cherry | PROWD34S | PROWD34 |
| Douglas Fir, VG | - | PROWDVGF1316 |
| Hickory | - | PROWDHCKRY1316 |
| Maple | PROWDM1316S | PROWDM1316 |
| Pine | - | PROWDPN1316 |
| Red Oak | PROWDRO1316S | PROWDRO1316 |
| Steamed Beech | - | PROWDSTMB1316 |
| Walnut | PROWDWA1316S | PROWDWA1316 |
| White Birch | PROWDWB1316S | PROWDWB1316 |
| White Oak | - | PROWDWO1316 |
| Unfinished - 15/16" Wide | | |
| Red Oak, FSC | - | PROWDROR1516PGFSC |
| Unfinished - 7/8" Wide | | |
| Ash | - | PROWDAS78 |
| Clear Pine | - | PROWD78 |
| Maple | - | PROWDMP78 |
| Walnut | - | PROWDWAL78PG |
| Unfinished - 1-1/4" Wide | | |
| Maple | - | PROWDM114PG |

A
B
C
D
E
F
G
H
I
J
K
L
M
N
O
P
Q
R
S
T
U
V
W
X
Y

A WOOD VENEER EDGEBANDING

B
C
D
E
F
G
H
I
J
K
L
M
N
O
P
Q
R
S
T
U
V
W
X
Y



Automatic Fleece Back Wood Veneer Edgebanding



- Natural Grade A Real Wood Veneer
- 500' Rolls Fleece Back, Sanded Front
- Staggered finger joints
- Prefinished rolls feature a UV Satin clear coat, factory applied
- FSC Available on Special Order

| Species | 500' Roll Item # |
|---------------------------------|------------------|
| Unfinished - 7/8" Wide | |
| African Mahogany | PROWDAFM78A |
| Alder | PROWDALD78A |
| Ash | PROWDAS78A |
| Birch | PROWDNB78A |
| Cherry | PROWD78A |
| Clear Pine | PROWD78A |
| Douglas Fir, Vertical Grain | PROWDVGFIR78A |
| Hickory | PROWDHCKRY-78A |
| Maple | PROWDM78A |
| Red Oak | PROWDRO78A |
| Steamed Beech | PROWDSTMB78A |
| Walnut | PROWDWA78A |
| White Birch | PROWDWB78A |
| White Oak | PROWDWO78A |
| Unfinished - 15/16" Wide | |
| African Mahogany | PROWDAFM1516A |
| Alder | PROWDALD1516A |
| Cherry | PROWD78A |
| Maple | PROWDM1516A |
| Maple, FSC | PROWDM1516AFSC |
| Red Oak | PROWDRO1516A |
| Sapele, Quartered | PROWDSAPQTR1516A |
| Steamed Beech | PROWDSTMB1516A |
| Walnut | PROWDWA1516A |
| White Oak, Rift | PROWDWOR1516A |
| Red Oak, FSC | PROWDROR1516AFSC |
| Unfinished - 1-1/4" Wide | |
| Alder | PROWDALD114A |
| Red Oak, FSC | PROWDROR114AFSC |
| Unfinished - 1-3/4" Wide | |
| Maple | PROWDM134A |

| Species | 500' Roll Item # |
|----------------------------------|------------------|
| Prefinished - 5/8" Wide | |
| Maple | PROWDPFM58A |
| White Birch | PROWDPFWB58A |
| Prefinished - 7/8" Wide | |
| Cherry | PROWDPFCHRY78 |
| Maple | PROWDPFMAPL78 |
| Red Oak | PROWDPFRDOK78 |
| Walnut | PROWDPFWAL78 |
| White Birch | PROWDPFWB78A |
| Prefinished - 15/16" Wide | |
| Hickory | PROWDPFHCKRY1516 |
| Unfinished - 5/8" Wide | |
| Alder | PROWDALD58A |
| Maple | PROWDM58A |
| Unfinished - 3/4" Wide | |
| Maple | PROWDM34A |

WOOD VENEER EDGEBOARDING



Thick Solid Wood Edgbanding Rolls



- Natural Grade A Real Wood Veneer
- Sanded front
- 7/8" and 15/16" Width
- 328' Coil Roll
- 1.0mm and 1.5mm are 3-ply
- 3.0mm and 3.1mm are 6-ply

| Species | Thickness | Item # |
|--------------------|-----------|-----------------|
| 7/8" Wide | | |
| Cherry | 1mm | PROWD1MMCR78 |
| Maple | 1mm | PROWD1MMM78 |
| White Oak | 1mm | PROWD1MMWO78 |
| African Mahogany | 1.5mm | PROWD1.5MMAM78 |
| Alder | 1.5mm | PROWD1.5MMAL78 |
| Cherry | 1.5mm | PROWD1.5MMCR78 |
| Maple | 1.5mm | PROWD1.5MMM78 |
| Red Oak | 1.5mm | PROWD1.5MMRO78 |
| Walnut | 1.5mm | PROWD1.5MMWAL78 |
| White Oak | 1.5mm | PROWD1.5MMWO78 |
| Alder | 3mm | PROWD3MMAL |
| Cherry | 3mm | PROWD3MMCH78 |
| Mahogany | 3mm | PROWD3MMAH78 |
| Maple | 3mm | PROWD3MMM78 |
| Walnut | 3mm | PROWD3MMWAL78 |
| White Oak | 3mm | PROWD3MWO78 |
| Cherry | 3.1mm | PROWD3.1MMCR78 |
| Red Oak | 3.1mm | PROWD3.1MMRO78 |
| 15/16" Wide | | |
| Alder | 1mm | PROWD1MMAL1516 |
| Maple | 1mm | PROWD1MMM1516 |
| Red Birch | 1mm | PROWD1MMRB1516 |
| Walnut | 1mm | PROWD1MMWL1516 |
| White Oak, Rift | 1mm | PROWD1MMRWO1516 |

A
B
C
D
E
F
G
H
I
J
K
L
M
N
O
P
Q
R
S
T
U
V
W
X
Y

A WOOD VENEER SHEETS



Wood Veneer Sheets, 10MIL Paper Back



- Provides stability and flexibility while helping to minimize splitting, grain-raise, and glue seepage
- Tenderized to bend and wrap to a 1" radius
- Pre-sanded, machine surface sand: 150 grit
- Best to store in a climate controlled environment (Heated in winter/Air-conditioned in summer)
- Avoid exposure to sunlight
- Variation can be expected from sheet to sheet and lot to lot
- Ideal temperature for application is 70-80° F
- Ideal humidity is 35%
- Surface must be clean, dry and smooth (free of dust, grease, wax) to ensure a good bond
- Use of solvent-based adhesives are recommended and water-based adhesives are not recommended
- Veneer scrapers are recommended for hand application to allow for maximum pressure and "J" rollers are not recommended
- Adhesive should be allowed to cure for 48 hours prior to finishing
- Knotted products will be putty filled

| 4' x 8' Sheet Size, Item # | 2' x 8' Sheet Size, Item # | Species | Description | Sold In |
|----------------------------|----------------------------|--------------|-----------------------------------|--------------|
| FVALC48P | - | Alder | Clear, Grade A | By the sheet |
| FVALK48P | - | Alder | Rustic, Planked Matched | By the sheet |
| FVCH48P | FVCH28P | Cherry | Commodity Grade | By the sheet |
| FVCHQ48P | - | Cherry | Quartered, Grade A | By the sheet |
| FVFIVG48P | - | Fir, Douglas | Quarter Cut, Vertical Grain | By the sheet |
| FVHK48P | FVHK28PS | Hickory | Calico, Flat Cut, Grade A | By the sheet |
| FVKP48P | - | Knotty Pine | Planked Matched, Grade A | By the sheet |
| FVMK48P | - | Mahogany | African, Flat Cut | By the sheet |
| FVMP48P | FVMP28P | Maple | Commodity Grade | By the sheet |
| FVMPQ48P | - | Maple | Quarter Cut, Grade A | By the sheet |
| FVRO48P | FVRO28P | Red Oak | Commodity Grade | By the sheet |
| FVROQH48P | - | Red Oak | Quarter Cut, Heavy Flake | By the sheet |
| FVROR48P | - | Red Oak | Rift Cut, Grade A | By the sheet |
| FVSPQ48P | - | Sapele | Quarter Cut, Grade A | By the sheet |
| FVTK48P | - | Teak | Flat Cut, Grade A | By the sheet |
| FVWAL48P | - | Walnut | Commodity Grade | By the sheet |
| FVWALQS48P | - | Walnut | Quarter Cut, Grade A | By the sheet |
| FVWNQ48P | - | Wenge | Quarter Cut, Grade A | By the sheet |
| FVWB48P | - | White Birch | Rotary Cut | By the sheet |
| FVWO48P | FVWO28P | White Oak | Commodity Grade | By the sheet |
| FVWOP48P | - | White Oak | Flat Cut, Grade A | By the sheet |
| FVWOH48P | - | White Oak | Quarter Cut, Heavy Flake, Grade A | By the sheet |
| FVWOR48P | - | White Oak | Rift Cut, Grade A | By the sheet |

WOOD VENEER SHEETS



**Wood Veneer Sheets,
NBL Backer (No Black Line)**



- 3-ply construction is a pliable, moisture resistant sheet without the black edge associated with phenolic and foil backers
- Multi-ply construction includes an internal moisture barrier, parallel face and back grain
- Pre-sanded, machine surface sand: 150 grit, tenderized to bend and wrap a tight radius
- Ideal temperature for application is 70-80° F, ideal humidity is 35%
- Use of solvent-based adhesives are recommended and water-based adhesives are not recommended, allow to cure for 48 hours prior to finishing

| 4' x 8' Sheet Size Item # | Species | Description | Thickness | Sold In |
|---------------------------|-------------|-------------------------|--------------------------|--------------|
| FVALC48 | Alder | Clear, Grade A | .032" - .035", +/- .005" | By the sheet |
| FVALK48 | Alder | Rustic, Planked Matched | .032" - .035", +/- .005" | By the sheet |
| FVCH48 | Cherry | Flat Cut, Grade A | .032" - .035", +/- .005" | By the sheet |
| FVMK48 | Mahogany | African, Flat Cut | .032" - .035", +/- .005" | By the sheet |
| FVMP48 | Maple | Flat Cut, Grade A | .032" - .035", +/- .005" | By the sheet |
| FVRO48 | Red Oak | Flat Cut, Grade A | .032" - .035", +/- .005" | By the sheet |
| FWWAL48 | Walnut | Flat Cut, Grade A | .032" - .035", +/- .005" | By the sheet |
| FWWALQ48 | Walnut | Quarter Cut, Grade A | .032" - .035", +/- .005" | By the sheet |
| FWWA48 | White Ash | Flat Cut, Grade A | .032" - .035", +/- .005" | By the sheet |
| FWWB48 | White Birch | Rotary Cut | .032" - .035", +/- .005" | By the sheet |
| FWWOP48 | White Oak | Flat Cut, Grade A | .032" - .035", +/- .005" | By the sheet |



Wood Veneer Sheets, Duraback



- Product designed and engineered as an alternative to traditional laminate backed veneer
- Product is used in markets where solvent-based adhesive restrictions require woodworkers to use water-based glues
- Water-resistant backing offers problem free use of water-based adhesives while providing a moisture barrier, accepts almost any glue
- Pre-sanded, machine surface sand: 150 grit, easily post-formable around curves
- Ideal temperature for application is 70-80° F, ideal humidity is 35%, adhesive should be allowed to cure for 48 hours prior to finishing

| 4' x 8' Sheet Size Item # | Species | Description | Thickness | Sold In |
|---------------------------|-------------|-------------------------|--------------------------|--------------|
| FVALC48D | Alder | Clear, Grade A | .038" - .048", +/- .005" | By the sheet |
| FVALK48D | Alder | Rustic, Planked Matched | .038" - .048", +/- .005" | By the sheet |
| FVCH48D | Cherry | Flat Cut, Grade A | .038" - .048", +/- .005" | By the sheet |
| FVMP48D | Maple | Flat Cut, Grade A | .038" - .048", +/- .005" | By the sheet |
| FVRO48D | Red Oak | Flat Cut, Grade A | .038" - .048", +/- .005" | By the sheet |
| FWWAL48D | Walnut | Flat Cut, Grade A | .038" - .048", +/- .005" | By the sheet |
| FWWALQS48D | Walnut | Quarter Cut, Grade A | .038" - .048", +/- .005" | By the sheet |
| FWWBRS48D | White Birch | Rotary Cut, Grade A | .038" - .048", +/- .005" | By the sheet |
| FWWOP48D | White Oak | Flat Cut, Grade A | .038" - .048", +/- .005" | By the sheet |
| FWWORC48D | White Oak | Rift Cut, Grade A | .038" - .048", +/- .005" | By the sheet |

A
B
C
D
E
F
G
H
I
J
K
L
M
N
O
P
Q
R
S
T
U
V
W
X
Y

A WOOD VENEER SHEETS

**Wood Veneer Sheets,
2-Ply Hardwood**
FormWood
INDUSTRIES

- Perpendicular face-to-back construction w/an acrylic membrane to protect against bubbling, glue seepage & telegraphing
- Provides no unsightly edge lines, unlike phenolic-backed veneer
- Crossband construction allows 2-Ply veneer to bend on moderate curves in the horizontal or vertical direction
- Pre-sanded, machine surface sand: 150 grit
- Variation can be expected from sheet to sheet and lot to lot
- Ideal temperature for application is 70-80° F, ideal humidity is 35%
- Surface must be clean, dry and smooth (free of dust, grease, wax) to ensure a good bond
- Use of solvent-based adhesives are recommended and water-based adhesives are not recommended
- Veneer scrapers are recommended for hand application to allow for maximum pressure and "J" rollers are not recommended
- Adhesive should be allowed to cure for 48 hours prior to finishing

| 4' x 8' Sheet Size, Item # | Species | Description | Thickness | Sold In |
|----------------------------|--------------|-----------------------------|--------------------------|--------------|
| FVALC48T | Alder | Clear, Grade A | .032" - .035", +/- .005" | By the sheet |
| FVALK48T | Alder | Rustic, Planked Matched | .032" - .035", +/- .005" | By the sheet |
| FVFIRVG48T | Fir, Douglas | Quarter Cut, Vertical Grain | .032" - .035", +/- .005" | By the sheet |
| FVHK48T | Hickory | Calico, Grade A | .032" - .035", +/- .005" | By the sheet |
| FVHKR48T | Hickory | Rustic, Grade A | .032" - .035", +/- .005" | By the sheet |
| FVMPA48T | Maple | Flat Cut, Grade A | .032" - .035", +/- .005" | By the sheet |
| FVMPAQ48T | Maple | Quarter Cut, Grade A | .032" - .035", +/- .005" | By the sheet |
| FVROQH48T | Red Oak | Quarter Cut, Heavy Flake | .032" - .035", +/- .005" | By the sheet |
| FVROR48T | Red Oak | Rift Cut, Grade A | .032" - .035", +/- .005" | By the sheet |
| FVWAL48T | Walnut | Flat Cut, Grade A | .032" - .035", +/- .005" | By the sheet |
| FVWALQS48T | Walnut | Quarter Cut, Grade A | .032" - .035", +/- .005" | By the sheet |
| FVWALR48T | Walnut | Rustic, Grade A | .032" - .035", +/- .005" | By the sheet |
| FVWBR48T | White Birch | Rotary Cut | .032" - .035", +/- .005" | By the sheet |
| FVWOP48T | White Oak | Flat Cut, Grade A | .032" - .035", +/- .005" | By the sheet |
| FVWORC48T | White Oak | Rift Cut | .032" - .035", +/- .005" | By the sheet |
| FVWOH48T | White Oak | Quarter Cut Heavy Flake | .032" - .035", +/- .005" | By the sheet |

WOOD VENEER SHEETS



**Wood Veneer Sheets,
10MIL PSA Backer**



- Uses 3M® Brand PSA adhesives, peel and stick veneer provides a permanent bond to any smooth substrate
- PSA veneer can be cut and trimmed with ordinary tools, such as scissors or a utility knife
- Tenderized FormWood PSA veneer will bend to a tight radius
- Pre-sanded, machine surface sand: 150 grit
- Variation can be expected from sheet to sheet and lot to lot
- Ideal temperature for application is 70-80° F, ideal humidity is 35%
- Surface must be clean, dry and smooth (free of dust, grease, wax) to ensure a good bond
- Veneer scrapers are recommended for hand application to allow for maximum pressure and "J" rollers are not recommended
- Adhesive should be allowed to cure for 48 hours prior to finishing

| 2' x 8' Sheet Size, Per Sheet Item # | 2' x 8' Sheet Size, Bulk 4 Sheets Item # | Species | Description | Thickness |
|--|--|-------------|-------------------------|------------------|
| FVALC28PS | FVALC28PSB | Alder | Clear, Grade A | .025", +/- .005" |
| FVALK28PS | FVALK28PSB | Alder | Rustic, Planked Matched | .025", +/- .005" |
| FVCH28PS | FVCH28PSB | Cherry | Commodity Grade | .025", +/- .005" |
| FVHK28PS | - | Hickory | Calico, Grade A | .025", +/- .005" |
| FVMP28PS | FVMP28PSB | Maple | Commodity Grade | .025", +/- .005" |
| FVMPA28PS | FVMPA28PSB | Maple | Flat Cut, Grade A | .025", +/- .005" |
| FVRO28PS | - | Red Oak | Commodity Grade | .025", +/- .005" |
| FVWAL28PS | FVWAL28PSB | Walnut | Flat Cut, Grade A | .025", +/- .005" |
| FVWALQS28PS | FVWALQS28PSB | Walnut | Quarter Cut, Grade A | .025", +/- .005" |
| FVWBRS28PS | FVWBRS28PSB | White Birch | Rotary Cut, Grade A | .025", +/- .005" |
| FVWOP28PS | FVWOP28PSB | White Oak | Flat Cut, Grade A | .025", +/- .005" |
| FVWORC28PS | FVWORC28PSB | White Oak | Rift Cut, Grade A | .025", +/- .005" |

A
B
C
D
E
F
G
H
I
J
K
L
M
N
O
P
Q
R
S
T
U
V
W
X
Y

A WOOD VENEER EDGEBANDING

B
C
D
E
F
G
H
I
J
K
L
M
N
O
P
Q
R
S
T
U
V
W
X
Y



**Wood Veneer Edgebanding,
Fleece Backed Automatic, Non-Glued**



- Produced by joining individual pieces of veneer together into a continuous master roll by finger-jointing the veneer
- Rolls are laminated with a fleece, then sanded and slit to finished widths
- Finger joints are made by joining the veneer together using a die cut finger layout in the veneer and then gluing them together using joint tape
- Length of continuous veneer roll: 500 lineal feet
- Surface finish: 180 grit
- Material should be stored in plastic wrap to ensure moisture stability (reducing moisture loss)

| 15/16" x 500' Roll Item # | 7/8" x 500' Roll Item # | Species | Thickness | Sold In |
|---------------------------|-------------------------|-----------------|------------------|-------------|
| FVALD1516A | FVALD078A | Alder | .022", +/- .002" | By the roll |
| FVASH1516A | FVASH078A | Ash | .022", +/- .002" | By the roll |
| FVBEECHS1516A | FVBEECHS078A | Beech (Steamed) | .022", +/- .002" | By the roll |
| FVCHERRY1516A | FVCHERRY078A | Cherry | .022", +/- .002" | By the roll |
| - | FVFIRO78A | Fir | .022", +/- .002" | By the roll |
| FVHCKRY1516A | FVHCKRY078A | Hickory | .022", +/- .002" | By the roll |
| FVMHGNY1516A | FVMHGNY078A | Mahogany | .022", +/- .002" | By the roll |
| FVMAP1516A | FVMAPLE078A | Maple | .022", +/- .002" | By the roll |
| - | FVPINCO78A | Pine (Clear) | .022", +/- .002" | By the roll |
| FVWLNT1516A | FVWLNT078A | Walnut | .022", +/- .002" | By the roll |
| FVBIRCHW1516A | FVBIRCHW078A | White Birch | .022", +/- .002" | By the roll |
| FVWHOAK1516A | FVWHOAK078A | White Oak | .022", +/- .002" | By the roll |



**Wood Veneer Edgebanding,
Fleece Backed Pre-Finished Automatic,
Non-Glued**



- Produced by joining individual pieces of veneer together into a continuous master roll by finger-jointing the veneer
- Rolls are laminated with a fleece, then sanded and slit to finished widths
- Finger joints are made by joining the veneer together using a die cut finger layout in the veneer and then gluing them together using joint tape
- Gloss level between 20 and 30 is standard
- UV lacquer finish at 1.5 mils in coverage
- Length of continuous veneer roll: 500 lineal feet
- Material should be stored in plastic wrap to ensure moisture stability (reducing moisture loss)

| 7/8" x 500' Roll Item # | 5/8" x 500' Roll Item # | Species | Thickness | Sold In |
|-------------------------|-------------------------|-------------|------------------|-------------|
| FVPFCHERRY78A | FVPFCHERRY58A | Cherry | .020", +/- .002" | By the roll |
| FVPFMAPLE78A | FVPFMAPLE58A | Maple | .020", +/- .002" | By the roll |
| FVPFROAK78A | FVPFROAK58A | Red Oak | .020", +/- .002" | By the roll |
| FVPFWALNUT78A | FVPFWALNUT58A | Walnut | .020", +/- .002" | By the roll |
| FVPFWBIRCH78A | FVPFWBIRCH58A | White Birch | .020", +/- .002" | By the roll |

WOOD VENEER EDGEBANDING



Wood Veneer Edgebanding, Thick, Fleece Backed Automatic, Non-Glued



- Produced by joining individual pieces of veneer together into a continuous master roll by finger-jointing the veneer
- Rolls are laminated with a fleece, then sanded and slit to finished widths
- Finger joints are made by joining the veneer together using a die cut finger layout in the veneer and then gluing them together using joint tape
- Length of continuous veneer roll: 328 lineal feet
- Surface finish: 180 grit
- Material should be stored in plastic wrap to ensure moisture stability (reducing moisture loss)

| | 7/8" x 328' Roll Item # | Species | Thickness | Sold In |
|------------|-------------------------|-------------|----------------|-------------|
| 1mm | FVSWCHERRY1MM | Cherry | 1mm, +/- .002" | By the roll |
| | FVSWMAPLE1MM | Maple | 1mm, +/- .002" | By the roll |
| | FVSWROAK1MM | Red Oak | 1mm, +/- .002" | By the roll |
| | FVSWWLNT1MM | Walnut | 1mm, +/- .002" | By the roll |
| | FVSWWBIRCH1MM | White Birch | 1mm, +/- .002" | By the roll |
| | FVSWWOAK1MM | White Oak | 1mm, +/- .002" | By the roll |

| | 7/8" x 328' Roll Item # | Species | Thickness | Sold In |
|--------------|-------------------------|-------------|------------------|-------------|
| 1.5mm | FVSWCHERRY1.5MM | Cherry | 1.5mm, +/- .002" | By the roll |
| | FVSWMAPLE1.5MM | Maple | 1.5mm, +/- .002" | By the roll |
| | FVSWROAK1.5MM | Red Oak | 1.5mm, +/- .002" | By the roll |
| | FVSWLNT1.5MM | Walnut | 1.5mm, +/- .002" | By the roll |
| | FVSWBIRCHW1.5MM | White Birch | 1.5mm, +/- .002" | By the roll |

| | 7/8" x 328' Roll Item # | Species | Thickness | Sold In |
|------------|-------------------------|-------------|----------------|-------------|
| 2mm | FVSWCHERRY2MM | Cherry | 2mm, +/- .002" | By the roll |
| | FVSWMAPLE2MM | Maple | 2mm, +/- .002" | By the roll |
| | FVSWROAK2MM | Red Oak | 2mm, +/- .002" | By the roll |
| | FVSWWLNT2MM | Walnut | 2mm, +/- .002" | By the roll |
| | FVSWWBIRCH2MM | White Birch | 2mm, +/- .002" | By the roll |

| | 7/8" x 328' Roll Item # | Species | Thickness | Sold In |
|------------|-------------------------|-------------|----------------|-------------|
| 3mm | FVSWCHERRY3MM | Cherry | 3mm, +/- .002" | By the roll |
| | FVSWMAPLE3MM | Maple | 3mm, +/- .002" | By the roll |
| | FVSWROAK3MM | Red Oak | 3mm, +/- .002" | By the roll |
| | FVSWLNT3MM | Walnut | 3mm, +/- .002" | By the roll |
| | FVSWBIRCHW3MM | White Birch | 3mm, +/- .002" | By the roll |

A
B
C
D
E
F
G
H
I
J
K
L
M
N
O
P
Q
R
S
T
U
V
W
X
Y

A WOOD VENEER EDGEBANDING

**Wood Veneer Edgebanding,
Fleece Backed Pre-Glued**
FormWood
INDUSTRIES

- Produced by joining individual pieces of veneer together into a continuous master roll by finger-jointing the veneer
- Rolls are laminated with a fleece, then sanded and slit to finished widths
- Finger joints are made by joining the veneer together using a die cut finger layout in the veneer and then gluing them together using joint tape
- Length of continuous veneer roll: 250 lineal feet
- Surface finish: 180 grit
- Thickness: .034", +/- .002"
- Material should be stored in plastic wrap to ensure moisture stability (reducing moisture loss)

| 13/16" x 250' Roll Item # | 7/8" x 250' Roll Item # | Species | Sold In |
|---------------------------|-------------------------|-----------------|-------------|
| FVPGALDER1316 | FVPGALDER078 | Alder | By the roll |
| FVPGASH1316 | FVPGASH078 | Ash | By the roll |
| FVPGBEECHS1316 | FVPGBEECHS078 | Beech (Steamed) | By the roll |
| FVPGCHERRY1316 | FVPGCHERRY078 | Cherry | By the roll |
| FVPGFIR1316 | FVPGFIR078 | Fir | By the roll |
| FVPGHCKRY1316 | FVPGHCKRY078 | Hickory | By the roll |
| FVPGMHGNY1316 | FVPGMHGNY078 | Mahogany | By the roll |
| FVPGMAPLE1316 | FVPGMAPLE078 | Maple | By the roll |
| FVPGROAK1316 | FVPGROAK078 | Red Oak | By the roll |
| FVPGWLNT1316 | FVPGWLNT078 | Walnut | By the roll |
| FVPGBIRCHW1316 | FVPGBIRCHW078 | White Birch | By the roll |
| FVPGWOAK1316 | FVPGWOAK078 | White Oak | By the roll |

**Wood Veneer Edgebanding, Fleece Backed
Pre-Finished & Pre-Glued**
FormWood
INDUSTRIES

- Produced by joining individual pieces of veneer together into a continuous master roll by finger-jointing the veneer
- Rolls are laminated with a fleece, then sanded and slit to finished widths
- Finger joints are made by joining the veneer together using a die cut finger layout in the veneer and then gluing them together using joint tape
- Gloss level between 20 and 30 is standard
- UV lacquer finish at 1.5 mils in coverage
- Length of continuous veneer roll: 250 lineal feet
- Material should be stored in plastic wrap to ensure moisture stability (reducing moisture loss)

| 13/16" x 250' Roll Item # | 7/8" x 250' Roll Item # | Species | Sold In |
|---------------------------|-------------------------|-------------|-------------|
| FVPFPGCHERRY1316 | - | Cherry | By the roll |
| FVPFPGMAPLE1316 | FVPFPGMAPLE78 | Maple | By the roll |
| FVPFPGREDOAK1316 | - | Red Oak | By the roll |
| FVPFPGWALNUT1316 | - | Walnut | By the roll |
| FVPFPGWBIRCH1316 | FVPFPGWBIRCH78 | White Birch | By the roll |

PVC/REAL WOOD EDGEBOARDING

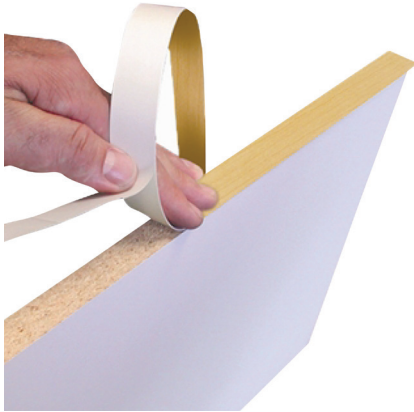

**PVC & Wood Edgebanding,
Peel & Stick**



- Made from high quality PVC and real wood veneers, easy to use
- Good for field repairs, inside and outside radii, scribe tape and many other applications
- High performance pressure sensitive acrylic adhesive on backing increases in strength as it cures
- Sold by the roll

| Color / Species | 50' Roll Item # | 250' Roll Item # | 600' Roll Item # |
|---|-------------------|--------------------|-------------------|
| Solid Color PVC, 1/2" Wide | | | |
| Black | - | FCFESP1/2-250BL | - |
| Solid Color PVC, 3/4" Wide | | | |
| Black | FCFESP3/4-50BL | - | FCFESP3/4-600BL |
| White | FCFESP3/4-50WH | - | - |
| Solid Color PVC, 15/16" Wide | | | |
| Almond | FCFESP15/16-50AL | FCFESP15/16-250AL | - |
| Antique White | FCFESP15/16-50AW | FCFESP15/16-250AW | - |
| Black | FCFESP15/16-50BL | FCFESP15/16-250BL | FCFESP15/16-600BK |
| Fog Gray | FCFESP15/16-50DG | FCFESP15/16-250DG | - |
| Light Gray | FCFESP15/16-50LG | FCFESP15/16-250LG | - |
| White | FCFESP15/16-50WH | FCFESP15/16-250WH | FCFESP15/16-600WH |
| Prefinished Real Wood, 15/16" Wide | | | |
| Maple | FCFEPW15/16-50PMP | FCFEPW15/16-250PMP | - |
| Red Oak | FCFEPW15/16-50PRO | - | - |
| Walnut | FCFEPW15/16-50PWA | FCFEPW15/16-250PWA | - |
| White Birch | FCFEPW15/16-50PWB | FCFEPW15/16-250PWB | - |
| Unfinished Real Wood, 15/16" Wide | | | |
| Alder | FCFESW15/16-50AD | FCFESW15/16-250AD | - |
| Cherry | FCFESW15/16-50CH | FCFESW15/16-250CH | - |
| Maple | FCFESW15/16-50MP | FCFESW15/16-250MP | - |
| Red Oak | FCFESW15/16-50RO | FCFESW15/16-250RO | - |
| White Birch | FCFESW15/16-50WB | - | - |
| Woodgrain PVC, 3/4" Wide | | | |
| Hardrock Maple | - | FCFEWP3/4-250HM | - |
| Woodgrain PVC, 15/16" Wide | | | |
| Hardrock Maple | FCFEWP15/16-50HM | FCFEWP15/16-250HM | FCFEWP15/16-600HM |
| Light Oak | FCFEWP15/16-50LO | FCFEWP15/16-250LO | FCFEWP15/16-600LO |
| Manitoba Maple | FCFEWP15/16-50MM | FCFEWP15/16-250MM | FCFEWP15/16-600MM |
| Natural Cherry | FCFEWP15/16-50NC | FCFEWP15/16-250NC | FCFEWP15/16-600NC |
| Natural Oak | FCFEWP15/16-50NO | FCFEWP15/16-250NO | FCFEWP15/16-600NO |

A
B
C
D
E
F
G
H
I
J
K
L
M
N
O
P
Q
R
S
T
U
V
W
X
Y

A EDGEBANDING TOOLS

PRACTICAL PRODUCTS



Double-Sided Edgebanding Trimmer

- Simultaneously trims both edges of most soft edgebanding materials
- Duplicate blades on both sides will flush or bevel trim panels from 1/2" - 1-1/2" thick
- One side can be used alone as a single-sided trimmer

| Item # | Description |
|------------|-----------------------------|
| PC-ET100 | Trimmer |
| PC-ET10ORP | Replacement Blade, Set of 6 |



Pneumatic Edgebanding Quad Trimmer



- No springs to lose when taking tool apart to trim one side of material
- Available tungsten carbide blades last 10 times longer than steel blades
- Trims both directions, both sides, top and bottom at once

| Item# | Description | Blade Type |
|-------------|-----------------------|------------------|
| FCQTRIM | Standard Trimmer | Carbon Steel |
| FCQBLADE | Replacement Blade Set | Carbon Steel |
| FCQPROTRIM | "Pro" Trimmer | Tungsten Carbide |
| FCQPROBLADE | Replacement Blade Set | Tungsten Carbide |



FC SPEEDROLLERQUAD

SpeedRoller



- Ergonomically designed with laminate rollers that can be used in any PSA application
- Non-marring rubber wheels or maximum PSI steel wheels

| Item # | Wheel/Roller Type |
|--------------------|---|
| FC SPEEDROLLERQUAD | Maximum PSI Steel, Non-Interchangeable |
| FC ROLLERPRO | 1 set Maximum PSI Steel and 1 set Non-Marring Rubber, Interchangeable |



FC ROLLERPRO

TEE MOLDINGS



Flexene Tee Moldings

- Non-toxic polyethylene is used to manufacture these "Flexene" moldings
- Fits any contour whether outside or inside curves and radii
- Product is consistently precise in dimensions, workability and color
- Design insures the installation will fit firmly and hug edges permanently
- Packing: 250 linear feet rolls, 4 rolls per box
- Sold In: Full rolls only, available any quantity



NOTE: Other colors available with minimum order 5,000' per color.

Contact Customer Service for more information.

| Item # | Description |
|----------------------------|-----------------------------------|
| Recommended Cutters | |
| AN53202 | 3 Wing Slotting Cutter, 3/32" leg |
| AN53204 | 3 Wing Slotting Cutter, 7/64" leg |
| AN47600 | Arbor, 1/4" Shank |

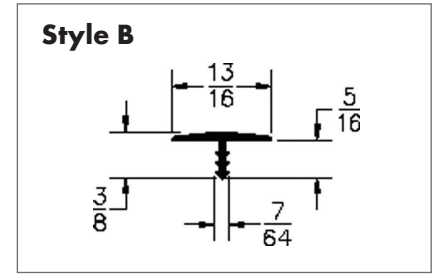
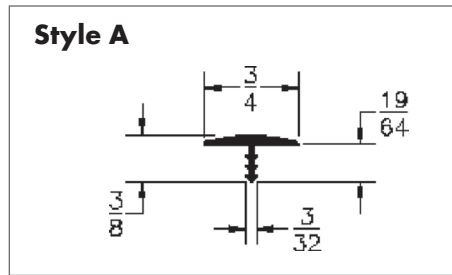

| Color | Style A - 3/4" W Item # | Style B - 13/16" W Item # |
|-----------|-------------------------|---------------------------|
| Beige | - | P500-1316AL |
| Black | P500-34BL | P500-1316BL |
| Brown | - | P500-1316BR |
| Dove Gray | - | P500-1316DG |
| White | P500-34WH | P500-1316WH |

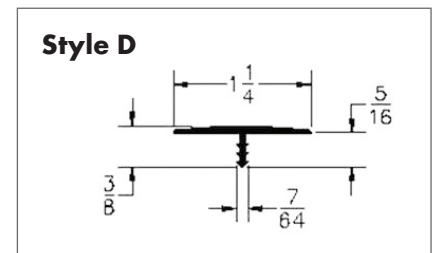
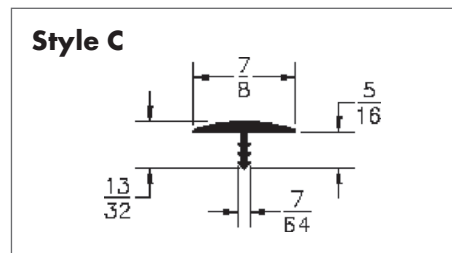

| Color | Style C - 7/8" W Item # | Style D - 1-1/4" W Item # |
|------------|-------------------------|---------------------------|
| Black | P500-78BL | P500-114BL |
| Light Gray | - | P500-114LG |
| White | P500-78WH | P500-114WH |

A
B
C
D
E
F
G
H
I
J
K
L
M
N
O
P
Q
R
S
T
U
V
W
X
Y

A BUMPER MOLDINGS & U-CHANNELS

A
B
C
D
E
F
G
H
I
J
K
L
M
N
O
P
Q
R
S
T
U
V
W
X
Y

Style A

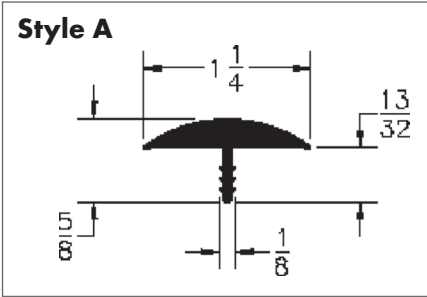

| Style A Item # | Size | Color |
|----------------|--------|-------|
| P575-114BL | 1-1/4" | Black |

Style B

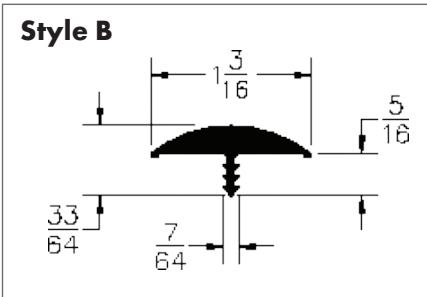

| Style B Item # | Size | Color |
|----------------|---------|-------|
| P575-1316BL | 1-3/16" | Black |

Bumper Moldings

- Specially formulated flexible PVC
- "Rubbery" plastic will not become brittle and has a self-healing effect when subject to abuse
- Designed to seat firmly and hug the edge permanently
- When a radius or curve is too small, simply notch the barbed section to maintain a firm fit
- Sold in 250' Rolls



Style C

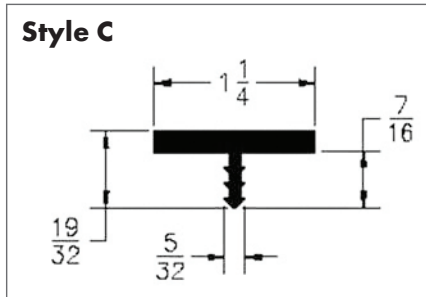

| Style C Item # | Size | Color |
|----------------|--------|-------|
| P580-114BL | 1-1/4" | Black |

Style D

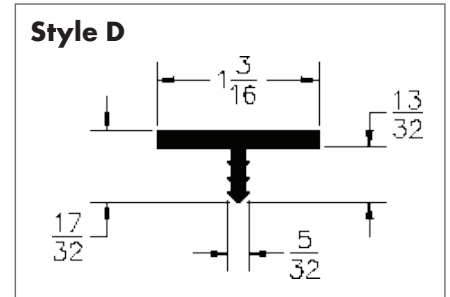

| Style D Item # | Size | Color |
|----------------|---------|-------|
| P580-1316BL | 1-3/16" | Black |

| Item # | Description |
|----------------------------|-----------------------------------|
| Recommended Cutters | |
| AN53204 | 3 Wing Slotting Cutter, 7/64" leg |
| AN47600 | Arbor, 1/4" Shank |

Style A

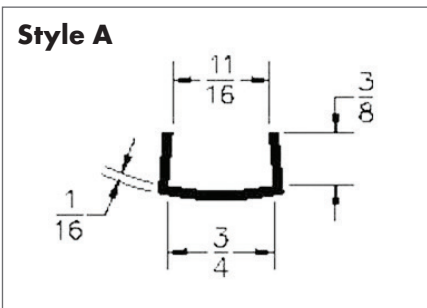

U-Channels

- Designed to finish single edges of shelves and boards
- Manufactured from a variety of resins
- Impact resistant
- Sold in 8' Strips



| Style A Item # | Size | Color |
|----------------|------|-------|
| P400-34WH | 3/4" | White |