

SECTION P - TABLE OF CONTENTS

Section P Contents:

Staples 2-3

Brad Nails.....4

Finish Nails5

Micro Brads & Micro Pins.....6

Specialty Pneumatic Fasteners.....7

Fastener Overview 8-9

Assembly Screws..... 10-16

Face Frame/Pockethole Screws 16-20

Installation and Trim Screws 21-23

Drywall Screws..... 24

Hinge, Slide & Hardware Screws 25-31

Drawer Front Adjusting Screws 31

Decorative Hardware Screws..... 32-33

Euro Screws 34

Confirmat & Connecting Screws 35

Screwdriver Bits & Accessories..... 36-38

Tite Joint Fasteners (Dogbones)..... 38-39

Covercaps and Finish Washers 40-44

Mirror and Backsplash Clips 45

Top and Desk Top Fasteners, Keyhole Fasteners 46

Mending Plates & Corner Braces..... 46-47

Keku Fasteners..... 48

Post Hangers & Panel Retaining Clips 49

Panel Hanging Clips (Z-Clips) 50-51

Wall Anchors..... 51

Dowel Pins & Rods 52

Biscuits..... 53

Titus Fittings..... 54-56



A
B
C
D
E
F
G
H
I
J
K
L
M
N
O
P
Q
R
S
T
U
V
W
X
Y



A STAPLES

B
C
D
E
F
G
H
I
J
K
L
M
N
O
P
Q
R
S
T
U
V
W
X
Y

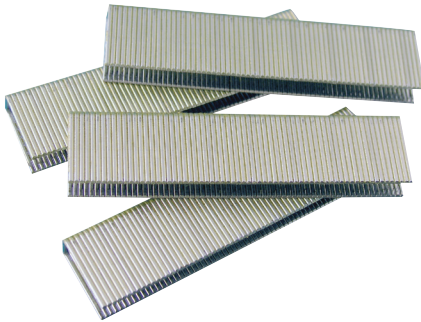

**Staples, 7/16" Medium Crown
16 Gauge**



- Applications: Furniture and case good face frames and side stiles, desk and cabinet box build up, soffit and fascia, casebacks, countertop build up, hardwood pallets, shipping crates and boxes, sash and millwork
- Sold by the box

Length	Item #	Box Qty
1"	WRS16100L	10,000
1-1/4"	WRS16125L	10,000
1-1/2"	WRS16150L	10,000
1-3/4"	WRS16175L	10,000
2"	WRS16200L	10,000

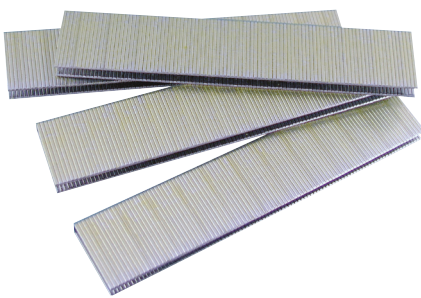

**Staples, 7/32" Crown
18 Gauge**



- Applications: Cabinet building, underlayment, moldings
- Sold by the box

Length	Item #	Box Qty
3/4"	WRS18075N	5,000
1-3/16"	WRS18119N	3,000
1-1/4"	WRS18125N	3,000

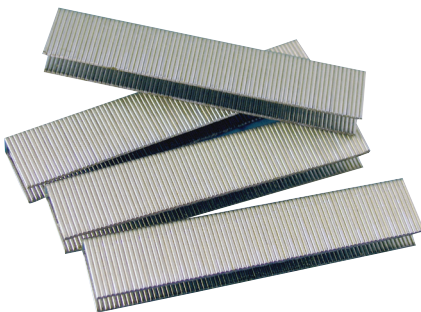

**Staples, 3/8" Crown
18 Gauge**



- Applications: Cabinetry and furniture, aluminum siding, mobile homes and RV's, and light metal to wood attachment
- Sold by the box

Length	Würth Item #	Box Qty	Senco Item # Galvanized Finish	Box Qty	Senco Item # Bright Basic Finish	Box Qty
1/2"	WRS18050M	5,000	-	-	-	-
5/8"	WRS18063M	5,000	SNCM10BABN	5,000	SNCM10BRBN	5,000
3/4"	WRS18075M	5,000	SNCM11BABN	5,000	SNCM11BRBN	5,000
1"	WRS18100M	5,000	-	-	-	-

STAPLES



**Staples, 1/4" Narrow Crown
18 Gauge**



- Applications: Casebacks, pre-hung units, paneling, interior trim, drawers underlayment, door and window casings, cabinet assembly, lattice glue blocks, moldings and cabinet box assembly
- Sold by the box

Length	Würth Item #	Box Qty	Senco Item #	Box Qty
1/2"	WRS18050KT	5,000	SNCL08BAB	10,000
5/8"	WRS18063K	5,000	SNCL10BAB	5,000
3/4"	WRS18075K	5,000	SNCL11BAB	5,000
7/8"	WRS18088K	5,000	SNCL12BAB	5,000
1"	WRS18100K	5,000	SNCL13BAB	5,000
1-1/8"	WRS18113K	5,000	SNCL14BAB	5,000
1-1/4"	WRS18125K	5,000	SNCL15BAB	5,000
1-1/2"	WRS18150K	5,000	SNCL17BAB	5,000

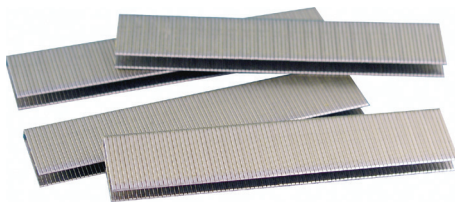

**Staples, 1/4" Crown
19 Gauge**



- Applications: Cabinets, casebacks, underlayment, molding and trim, lattice, and hardwood floors
- Sold by the box

Length	Würth Item #	Box Qty
3/4"	WRS19075R	5,000

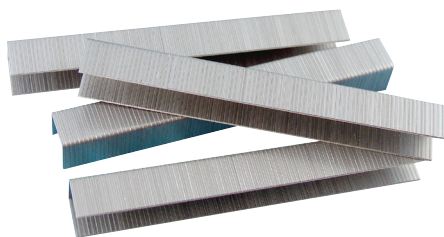

**Staples, 1/2" Crown
20 Gauge**



- Applications: Casebacks, molding, upholstery, and dust covers
- Sold by the box

Length	Senco Item #	Box Qty
3/8"	SNCF06BAA	10,000
1/2"	SNCF08BAA	10,000

LOOKING FOR A NEW STAPLE GUN?

See Section V

A BRAD NAILS

B
C
D
E
F
G
H
I
J
K
L
M
N
O
P
Q
R
S
T
U
V
W
X
Y

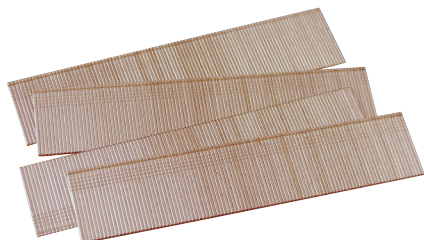

**Slight Head Brad Nails
18 Gauge**



- Applications: Cabinets, furniture, woodworking, trim, dowels and joints, cabinet door frames and panels, drawer assembly, decorative wood, and plastic pieces
- Sold by the box

Length	Würth Item #	Box Qty	Senco Item #	Box Qty
5/8"	WRN18063B	5,000	SNCA110EAA	5,000
3/4"	WRN18075B	5,000	SNCA111EAA	5,000
1"	WRN18100B	5,000	SNCA113EAA	5,000



**Brad Nails
18 Gauge**



- Applications: Carvings and ornamentals, furniture repair, cabinets and drawers, casebacks, small trim and baseboards
- Sold by the box

Length	Würth Item #	Box Qty	Senco Item #	Box Qty
1/2"	WREB812B	5,000	-	-
5/8"	WRN18063A	5,000	-	-
3/4"	WRN18075A	5,000	SNCA111EAAP	5,000
1"	WRN18100A	5,000	SNCA113EAA	5,000
1-3/16"	WRN18119A	5,000	-	-
1-1/4"	WRN18125A	5,000	SNCA115EAA	5,000
1-1/2"	WRN18150A	5,000	SNCA117EAA	5,000
1-9/16"	WRN18156A	5,000	-	-
1-5/8"	-	-	SNCA118EAA	5,000
1-3/4"	WRN18175A	5,000	-	-
2"	WRN18200A	5,000	SNCA211EAA	5,000
2-1/8"	-	-	SNCA22EAA	5,000

Mini Packs		
Length	Senco Item #	Box Qty
1"	SNCA201009	1,000
1-1/4"	SNCA201259	1,000
1-1/2"	SNCA201509	800
2"	SNCA202009	800

FINISH NAILS

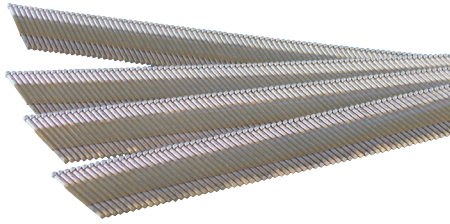

**Angled Finish Nails
15 Gauge**

- Applications: Vanities, molding and trim, dowels and joints, cabinet door frames, drawer assembly, picture frames, scribe moldings, furniture repair, carvings, ornamentals, blind pinning of upholstered and trim panels, and rattan
- Sold by the box



Length	Würth Item #	Box Qty	Senco Item #	Box Qty
1"	WRN15100E	4,000	SNCDA13EPB	5,000
1-1/4"	WRN15125E	4,000	SNCDA15EPB	4,000
1-1/2"	WRN15150E	4,000	SNCDA17EPB	4,000
1-3/4"	WRN15175E	4,000	SNCDA19EPB	4,000
2"	WRN15200E	4,000	SNCDA21EPB	4,000
2-1/4"	WRN15225E	4,000	SNCDA23EPB	4,000
2-1/2"	WRN15250E	4,000	SNCDA25EPB	3,000



**Finish Nails
16 Gauge**

- Applications: Cabinets, shelving, drawer boxes, trim and molding build-ups, and chair railings
- Sold by the box



Length	Item #	Box Qty
1"	WRN16100D	5,000
1-1/4"	WRN16125D	5,000
1-1/2"	WRN16150D	5,000
1-3/4"	WRN16175D	5,000
2"	WRN16200D	5,000
2-1/2"	WRN16250D	5,000

**LOOKING FOR A NEW
FINISH NAILER?**

See Section V



A MICRO BRADS/PINS

B
C
D
E
F
G
H
I
J
K
L
M
N
O
P
Q
R
S
T
U
V
W
X
Y

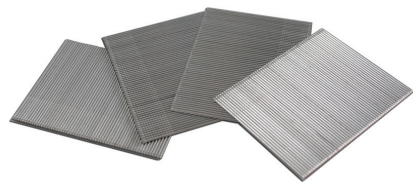

**Micro Brads
23 Gauge**

- Applications: Cabinet doors, light trim, carvings and ornamentals and picture frames
- Sold by the box



Length	Item #	Box Qty
7/8"	WRN23088B	10,000
1"	WRN23100B	10,000
1-3/16"	WRN23119B	10,000
1-3/8"	WRN23138B	10,000



**Micro Pins
23 Gauge**

- Applications: Cabinet doors, light trim, carvings and ornamentals and picture frames
- SNCA109809 Assortment Pack contains 1/2" - 1" Micro Pins
- Sold by the mini pack or box



Length	Würth Item #	Box Qty	Senco Item #	Mini pack Qty	Senco Item #	Box Qty
1/2"	WRN23050F-10	10,000	SNCA100509	2,600	-	-
5/8"	WRN23058F-10	10,000	SNCA100629	2,600	SNCCZ10EAA	10,000
3/4"	WRN23075F-10	10,000	SNCA100759	2,600	-	-
1"	WRN23100F-10	10,000	SNCA101009	2,600	SNCCZ13EAA	10,000
1-1/4"	-	-	SNCA101259	2,600	SNCCZ15EAA	10,000
1-3/8"	-	-	SNCA101379	2,600	SNCCZ16EAA	10,000
1-1/2"	-	-	-	-	SNCCZ17EAA	10,000
2"	-	-	-	-	SNCCZ21EAA	10,000
Multi Pack: 1/2", 5/8", 3/4", 1"			SNCA109809	2,500 Total	-	-

SPECIALTY PNEUMATIC FASTENERS

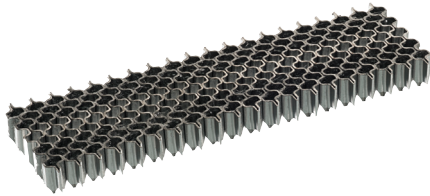

Corrugated Fasteners, 1" Crown 25 Gauge



- Applications: Butt Joints, cabinets, door and window sashes, millwork, pallets and pallet repair, crate and box assembly
- Sold by the box

Length	Item #	Box Qty
3/8"	SNCX06NRA	5,000
1/2"	SNCX08NRA	4,000

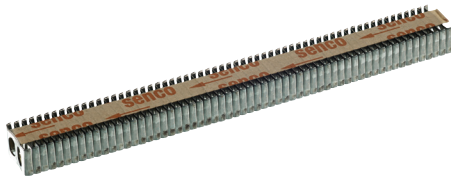

Sendlamp 7/16" Crown 25 Gauge



- Applications: Butt Joints, cabinets, curios, mirror and picture frames
- Sold by the box

Length	Item #	Box Qty
5/16"	SNCY05BFA	3,000
7/16"	SNCY07BFA	3,000
9/16"	SNCY09BFA	3,000

Visit us on our website: wurthlac.com





Shopping Cart
\$0.00

Shop By Category

Home

LEAVE THE DUST
BEHIND WITH
3M XTRACT™
ABRASIVES!



1 2 3



GOVERNMENT

CATALOGS
& LITERATURE

MACHINERY

A
B
C
D
E
F
G
H
I
J
K
L
M
N
O
P
Q
R
S
T
U
V
W
X
Y

A FASTENER OVERVIEW

B
C
D
E
F
G
H
I
J
K
L
M
N
O
P
Q
R
S
T
U
V
W
X
Y

Head Guide

Flat	Flat with Nibs (Nibs make it easier to countersink)
Bugle	Pan
Modified Pan	Truss
Modified Truss	Trim
Round Washer	Undercut

Drive Guide

Phillips-Slot
Combination/utility drive found primarily in truss head machine screws.

AW
Patented drive system that entirely eliminates spin out (cam-out) while providing greater power transfer, longer tool life, and positive engagement that a 3" screw can be held without holders.

Combo (Recex®)
Easy driving square/phillips combination drive provides higher torque and reduces spinout.
Recommended that square drive used for driving and square/phillips used for screw removal.

Square
Square drive improves engagement, reducing spin out in power driving.

Phillips
Most common drive for wood applications and drive drills.

Pozidrive
Designed to provide higher torque in hand driving operations.

Thread and Point Guide

Fine Thread General woodworking use, primarily with solid woods and hardwood. Requires pre-drilling and pre-countersinking.	
Hi-Lo Thread "All-purpose" thread. Designed for greater holding and less strip-out in all woods.	
Coarse Thread Used in particleboard and soft woods. Best results require pre-drilling and countersinking.	
Turbo Thread Virtually eliminates pre-drilling and countersinking. With features like nibs and a patented serrated tooth thread for less driving torque and reduced splitting. Recommended for real wood only - not for use in man made materials.	

ASSY® Patented "Asymmetrical / Symmetrical" thread geometry and 30° point locates screw precisely, drives fast, with 40% higher fracture torque than ordinary screws.	
ASSY® Plus Patented "ASSY" thread design plus a drill bit cutter head for clean, fast, non-splitting drive into all woods and near edges.	
Type 17 Auger Point Sharp slotted point acts as drill to eliminate pre-drilling for quicker, faster installation.	
Double Auger Fast, stress-free driving; minimizes pre-drilling in hardwoods.	
Flat Screw Point Machine screws. Used to attach decorative hardware and in RTA applications.	

FASTENER OVERVIEW

STRONGER THAN STEEL! How Strong are our screws?

Heat-treating makes our screws tough enough to drive into red oak without a pilot hole, tough enough to resist the forces trying to blow apart the driver bit recess as the screw is driven, tough enough to keep the driver bit from stripping out the recess, and tough enough to resist breakage when a load is placed on a screwed joint. Go into most hardware stores and home centers and the screws you find will be poorly heat-treated, or not heat-treated at all!

Company	Screw Size	Threads per Inch	Major Diameter	Minor Diameter	Minimum Breaking Torque (Lb. per Sq. Inch)
Würth	#5	13	.120 - .130	.080 - .086	17
Competitor A	#5	14	.122 - .128	.072 - .078	18
Competitor B	#5	13	.118 - .125	.068 - .075	16
Würth	#6	12	.140 - .150	.088 - .093	23
Competitor A	#6	13	.135 - .141	.078 - .087	18
Competitor B	#6	12	.130 - .140	.076 - .076	17
Würth (Top Mover!)	#8	10	.161 - .168	.100 - .105	38
Competitor A	#8	11	.161 - .168	.094 - .103	28
Competitor B	#8	12	.160 - .170	.092 - .102	28
Würth	#10	9	.196 - .206	.118 - .123	50
Competitor A	#10	9	.187 - .194	.110 - .119	39
Competitor B	#10	9	.188 - .198	.108 - .118	40
Würth	#12	11	.218 - .230	.135 - .140	70
Competitor A	#12	8	.225 - .230	.169 - .170	65
Competitor B	#12	9	.215 - .225	.130 - .140	62

- The information above was taken from company web sites or other published data*
- All dimensional and test data based on standard Deep Thread screws*

Würth uses only the finest quality 1018-1022 carbon steel to manufacture their fasteners. Our special heat treating process ensures maximum strength and breaking torque. All Würth Screws are manufactured to meet or exceed I.F.I. (International Fastener Institute) standards. We manufacture the majority of our fasteners in our own factories to ensure consistency and to control quality.

A ASSEMBLY SCREWS

Flat Head Square Drive, Coarse Thread Without Nibs, Regular Point



- 3/4" and 1" lengths are threaded

fully - all other sizes are threaded
2/3's from bottom of the screw

- Case hardened, Lubricated
- Uses #2 Square Drive bits
- Box quantities as shown on right
- Sold by the box



Length x Gauge	Finish	Box Qty	Item #	Quick Code	Bulk Qty	Item #	Quick Code
3/4" x 6	Lubricated	1,000	WUMS6X34FSCLT	L39215	15,000	WUMS6X34FSCLB	L39217
1" x 8	Lubricated	1,000	WUWS8X100FSCLT	L39230	10,000	WUWS8X100FSCLB	L39232
1-1/4" x 8	Lubricated	1,000	WUWS8X114FSCLT	L39235	7,500	WUWS8X114FSCLB	L39237
1-1/2" x 8	Lubricated	1,000	WUWS8X112FSCLT	L39240	5,000	WUWS8X112FSCLB	L39242
1-3/4" x 8	Lubricated	1,000	WUWS8X134FSCLT	L39250	4,000	WUWS8X134FSCLB	L39252
2" x 8	Lubricated	1,000	WUWS8X200FSCLT	L39255	3,500	WUWS8X200FSCLB	L39257
2-1/4" x 8	Lubricated	-	-	-	3,000	WUWS8X214FSCLB	L39262
2-1/2" x 8	Lubricated	1,000	WUWS8X212FSCLT	L39265	2,500	WUWS8X212FSCLB	L39267
3" x 8	Lubricated	1,000	-	-	1,500	WUWS8X300FSCLB	L39270

Flat Head Square Drive, Coarse Thread With Nibs, Type 17 Auger Point



- 1" are threaded fully - all other sizes are threaded 2/3's from bottom of the screw
- Case hardened finishes listed on right
- #2 Square Drive bits
- Box quantities as shown below
- Sold by the box, bucket or case



Size	Box			Bucket			Bulk		
	Item #	Quick Code	Box Qty	Item #	Quick Code	Bucket Qty	Item #	Quick Code	Bulk Qty
Black Oxidized Finish									
1" x 8	WUWS8X1FCSBNPT	L37100	1,000	WUWST8X100FCSTNPB	LT3712	7,000	WUWS8X1FCSBNPB	L37120	11,000
1-1/4" x 8	WUWS8X114FCSBNPT	L37140	1,000	WUWST8X114FCSTNPB	LT3716	5,000	WUWS8X114FCSBNPB	L37160	9,000
1-1/2" x 8	WUWS8X112FCSBNPT	L37180	1,000	WUWST8X112FCSTNPB	LT3720	5,000	WUWS8X112FCSBNPB	L37200	7,000
1-5/8" x 8	WUWS8X158FCSBNPT	L37220	1,000	WUWST8X158FCSTNPB	LT3724	3,500	-	-	-
1-3/4" x 8	WUWS8X134FSCBT	L37260	1,000	-	-	-	WUWS8X158FCSBNPB	L37240	5,500
2" x 8	WUWS8X2FCSBNPT	L37280	1,000	WUWST8X200FCSTNPB	LT3730	3,000	WUWS8X2FCSBNPB	L37300	4,000
2-1/4" x 8	WUWS8X214FSCBT	L37305	1,000	WUWST8X214FCSTNPB	LT3731	2,500	WUWS8X214FSCB	L37310	3,500
2-1/2" x 8	WUWS8X212FCSBNPT	L37340	1,000	WUWST8X212FCSTNPB	LT3735	2,500	WUWS8X212FCSBNPB	L37350	2,500
3" x 8	WUWS8X3FCSBNPT	L37380	1,000	WUWST8X300FCSTNPB	LT3739	2,000	WUWS8X3FCSBNPB	L37390	2,000
Zinc Finish									
1" x 8	WUWS8X1FCSZNPT	L31600	1,000	WUWST8X100FCSZNPB	LT3170	7,000	WUWS8X1FCSZNPB	L31700	11,000
1-1/4" x 8	WUWS8X114FCSZNPT	L31800	1,000	WUWST8X114FCSZNPB	LT3190	5,000	WUWS8X114FCSZNPB	L31900	9,000
1-1/2" x 8	WUWS8X112FCSZNPT	L38800	1,000	WUWST8X112FCSZNPB	LT3890	5,000	WUWS8X112FCSZNPB	L38900	7,000
1-5/8" x 8	WUWS8X158FCSZNPT	L39000	1,000	WUWST8X158FCSZNPB	LT3910	3,500	WUWS8X158FCSZNPB	L39100	5,500
1-3/4" x 8	WUWS8X134FSCZT	L39110	1,000	-	-	-	WUWS8X134FSCZB	L39120	4,800
2" x 8	WUWS8X2FCSZNPT	L39200	1,000	WUWST8X200FCSZNPB	LT3930	3,000	WUWS8X2FCSZNPB	L39300	4,000
2-1/4" x 8	WUWS8X214FCSZNPT	L39400	1,000	WUWST8X214FCSZNPB	LT3950	2,500	WUWS8X214FCSZNPB	L39500	3,500
2-1/2" x 8	WUWS8X212FCSZNPT	L39710	1,000	WUWST8X212FCSZNPB	LT3971	2,500	WUWS8X212FCSZNPB	L39715	2,500
3" x 8	WUWS8X3FCSZNPT	L39800	1,000	WUWST8X300FCSZNPB	LT3990	2,000	WUWS8X3FCSZNPB	L39900	2,000

ASSEMBLY SCREWS

Flat Head Recex (Combo Phillips & Square) Drive, Coarse Thread With or Without Nibs, Regular Point



- 1" lengths are threaded fully - all other sizes are threaded 2/3's from bottom of the screw
- Case hardened, Lubricated
- Uses #2 Square Drive bits to insert; #2 Phillips Drive bits can be used for aftermarket adjustment
- Box quantities as shown below
- Sold by the box



Without Nibs, With Regular Point



With Nibs, With Regular Point

Length x Gauge	Finish	Box Qty	Item #	Quick Code	Bulk Qty	Item #	Quick Code
Without Nibs, Regular Point							
1" x 8	Lubricated	1,000	WUWS8X100FCCLT	L38820	10,000	WUWS8X100FCCLB	L38822
1-1/4" x 8	Lubricated	1,000	WUWS8X114FCCLT	L38825	7,500	WUWS8X114FCCLB	L38827
1-1/2" x 8	Lubricated	1,000	WUWS8X112FCCLT	L38830	5,000	WUWS8X112FCCLB	L38832
1-3/4" x 8	Lubricated	-	-	-	4,000	WUWS8X134FCCLB	L38837
2" x 8	Lubricated	1,000	WUWS8X200FCCLT	L38842	3,500	WUWS8X200FCCLB	L38840
2-1/2" x 8	Lubricated	-	-	-	2,500	WUWS8X212FCCLB	L38852
3" x 8	Lubricated	-	-	-	1,500	WUWS8X300FCCLB	L38870
With Nibs, Regular Point							
1-1/4" x 8	Lubricated	1,000	WUWS8X114FCCLT	L39020	7,500	WUWS8X114FCCLB	L39022
1-1/2" x 8	Lubricated	1,000	WUWS8X112FCCLT	L39025	5,000	WUWS8X112FCCLB	L39027
1-3/4" x 8	Lubricated	1,000	WUWS8X134FCCLT	L39030	4,000	WUWS8X134FCCLB	L39032
2" x 8	Lubricated	-	-	-	3,500	WUWS8X200FCCLB	L39037
2-1/2" x 8	Lubricated	-	-	-	2,500	WUWS8X212FCCLB	L39055
3" x 8	Lubricated	-	-	-	1,500	WUWS8X300FCCLB	L39075



* #9 body with #8 head

Flat Head Recex (Combo Phillips & Square) Drive, Coarse Thread With Nibs and Double Auger Point



- Double Auger for faster, stress-free driving; minimizes pre-drilling in hardwoods
- Case hardened, Lubricated
- Uses #2 Square Drive bits to insert; #2 Phillips Drive bits can be used for aftermarket adjustment
- Box quantities as shown below
- Sold by the box

Length x Gauge	Finish	Box Qty	Item #	Bulk Qty	Item #
1-1/4" x 8	Lubricated	1,000	QS006024	9,000	QS005440
1-1/2" x 8	Lubricated	1,000	QS006025	7,000	QS005441
1-5/8" x 8	Lubricated	1,000	QS006026	5,000	QS005442
2" x 8	Lubricated	1,000	QS006027	4,000	QS005443
2-1/2" x 8	Lubricated	500	QS006029	2,500	QS005445
3" x 8	Lubricated	-	-	2,000	QS005446
1-1/4" x 8	Zinc	-	-	9,000	QS003122
1-5/8" x 8	Zinc	1000	QS005564	6000	QS003124
2" x 8	Zinc	-	-	4000	QS003125
2-1/2" x 8	Zinc	-	-	2500	QS005896
2-1/2" x 9*	Zinc	500	QS009134	2500	QS009012
3" x 8	Zinc	-	-	2000	QS005897

A
B
C
D
E
F
G
H
I
J
K
L
M
N
O
P
Q
R
S
T
U
V
W
X
Y

A ASSEMBLY SCREWS

B
C
D
E
F
G
H
I
J
K
L
M
N
O
P
Q
R
S
T
U
V
W
X
Y



Flat Head Recex (Combo Phillips & Square) Drive, Coarse Thread With Nibs and Type 17 Auger Point



- 1" lengths are threaded fully - all other sizes are threaded 2/3's from bottom of the screw
- Case hardened, finishes listed below
- Uses #2 Square Drive bits to insert; #2 Phillips Drive bits can be used for aftermarket adjustment
- Box quantities as shown below
- Sold by the box

Length x Gauge	Finish	Box Qty	Item #	Quick Code	Bulk Qty	Item #	Quick Code
1" x 8	Black	1,000	WUWS8X100FCCSBT	L36710	11,000	WUWS8X100FCCSBB	L36715
1-1/4" x 8	Black	1,000	WUWS8X114FCCSBT	L36720	9,000	WUWS8X114FCCSBB	L36725
1-1/2" x 8	Black	1,000	WUWS8X112FCCSBT	L36730	7,000	WUWS8X112FCCSBB	L36735
1-3/4" x 8	Black	1,000	WUWS8X134FCCSBT	L36750	4,800	WUWS8X134FCCSBB	L36755
2" x 8	Black	1,000	WUWS8X200FCCSBT	L36760	4,000	WUWS8X200FCCSBB	L36765
2-1/4" x 8	Black	1,000	WUWS8X214FCCSBT	L36770	3,500	WUWS8X214FCCSBB	L36775
2-1/2" x 8	Black	1,000	WUWS8X212FCCSBT	L36780	2,500	WUWS8X212FCCSBB	L36785
3" x 8	Black	1,000	WUWS8X300FCCSBT	L36790	2,000	WUWS8X300FCCSBB	L36793
1" x 8	Zinc	1,000	WUWS8X100FCCSZT	L36820	-	-	-
1-1/4" x 8	Zinc	1,000	WUWS8X114FCCSZT	L36822	9,000	WUWS8X114FCCZB	L36830
1-1/2" x 8	Zinc	1,000	WUWS8X112FCCSZT	L36835	7,000	WUWS8X112FCCZB	L36840
1-5/8" x 8	Zinc	1,000	WUWS8X158FCCSZT	L36845	5,500	WUWS8X158FCCSZB	L36850
2" x 8	Zinc	1,000	WUWS8X200FCCSZT	L36870	4,000	WUWS8X200FCCZB	L36875
2-1/4" x 8	Zinc	-	-	-	3,500	WUWS8X214FCCSZB	L36885
2-1/2" x 8	Zinc	1,000	WUWS8X212FCCSZT	L36890	2,500	WUWS8X212FCCZB	L36895
3" x 8	Zinc	-	-	-	2,000	WUWS8X300FCCZB	L36910



Turbo Thread Jars



- Our top selling Turbo Thread screw, shown at top of next page, but in convenient smaller jar quantities
- Flip up handle plastic jar is convenient to move around the shop or jobsite
- Sold by the jar

Length x Gauge	Finish	Jar Qty	Item #
1-1/4" x 8	Lubricated	500	WU32550-JAR
1-1/2" x 8	Lubricated	500	WU32950-JAR
2" x 8	Lubricated	250	WU33350-JAR
2-1/2" x 8	Lubricated	250	WU33750-JAR

FREE 2" DRIVE BIT IN EACH JAR!

ASSEMBLY SCREWS

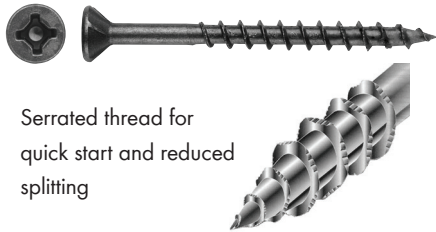

Serrated thread for quick start and reduced splitting

Flat Head Recex (Combo Phillips & Square) Drive, Turbo Thread w/Nibs, Regular Point



- Patented serrated tooth turbo thread allows for quick starting, reduced splitting and less drive torque
- Use in all wood working applications: assembly, face frame, slides, hinges and hardware
- 3/4" and 1" lengths are threaded fully - all other sizes are threaded 2/3's from bottom of the screw
- Case hardened, Lubricated
- Uses #2 Square Drive bits to insert; #2 Phillips Drive bits used for aftermarket adjustment
- Box quantities as shown below • Sold by the box

Length x Gauge	Finish	Box Qty	Item #	Quick Code	Bulk Qty	Item #	Quick Code
3/4" x 8	Lubricated	-	-	-	15,000	WUWS8X34FZCLNCB	L31950
1" x 8	Lubricated	1,000	WUWS8X1FZCLNCT	L32000	10,000	WUWS8X1FZCLNCB	L32100
1-1/8" x 8	Lubricated	1,000	WUWS8X118FZCLNCT	L32200	8,000	WUWS8X118FZCLNCB	L32300
1-1/4" x 8	Lubricated	1,000	WUWS8X114FZCLNCT	L32400	7,500	WUWS8X114FZCLNCB	L32500
1-3/8" x 8	Lubricated	1,000	WUWS8X138FZCLNCT	L32600	-	-	-
1-1/2" x 8	Lubricated	1,000	WUWS8X112FZCLNCT	L32800	5,000	WUWS8X112FZCLNCB	L32900
1-3/4" x 8	Lubricated	1,000	WUWS8X134FZCLNCT	L33000	4,000	WUWS8X134FZCLNCB	L33100
2" x 8	Lubricated	1,000	WUWS8X2FZCLNCT	L33200	3,500	WUWS8X2FZCLNCB	L33300
2-1/4" x 8	Lubricated	1,000	WUWS8X214FZCLNCT	L33400	-	WUWS8X214FZCLNCB	L33500
2-1/2" x 8	Lubricated	1,000	WUWS8X212FZCLNCT	L33600	2,500	WUWS8X212FZCLNCB	L33700
2-3/4" x 8	Lubricated	1,000	WUWS8X234FZCLNCT	L33800	2,000	WUWS8X234FZCLNCB	L33900
3" x 8	Lubricated	1,000	WUWS8X3FZCLNCT	L34000	1,500	WUWS8X3FZCLNCB	L34100

Flat Head Phillips Drive Screws, Coarse Thread Without Nibs, Regular Point



- 3/4" and 1" lengths are threaded fully - all other sizes are threaded 2/3's from bottom of the screw
- Case hardened, finishes listed below
- Uses #2 Phillips Drive bits
- Box quantities as shown below • Sold by the box



Length x Gauge	Finish	Box Qty	Item #	Quick Code	Bulk Qty	Item #	Quick Code
3/4" x 6	Lubricated	1,000	WUMS6X34FPCFLT	L38720	15,000	WUMS6X34FPCFLB	L38710
1" x 8	Lubricated	1,000	WUWS8X100FPCFLT	L38730	10,000	WUWS8X100FPCFLB	L38732
1-1/4" x 8	Lubricated	-	-	-	7,500	WUWS8X114FPCFLB	L38738
1-1/2" x 8	Lubricated	-	-	-	5,000	WUWS8X200FPCFLB	L38742
2" x 8	Lubricated	1,000	WUWS8X200FPCFLT	L38750	-	-	-
4" x 10	Lubricated	-	-	-	1,000	WUWS10X400FPCFLB	L37400
3/4" x 6	Black	1,000	WUMS8X34FPCBT	L38330	-	-	-
1-1/4" x 8	Black	1,000	WUWS8X114FPCBT	L38350	-	-	-
1-1/2" x 8	Black	1,000	WUWS8X112FPCBT	L38360	-	-	-
1-5/8" x 8	Black	-	-	-	5,500	WUWS8X158FPCBB	L38375
1-3/4" x 8	Black	-	-	-	4,800	WUWS8X134FPCBB	L38385
2" x 8	Black	-	-	-	4,000	WUWS8X200FPCBB	L38395
2-1/2" x 8	Black	-	-	-	2,500	WUWS8X212FPCBB	L38415
3" x 8	Black	1,000	WUWS8X300FPCBT	L38425	-	-	-

A ASSEMBLY SCREWS

B
C
D
E
F
G
H
I
J
K
L
M
N
O
P
Q
R
S
T
U
V
W
X
Y



**Flat Head Phillips Drive,
Coarse Thread With Nibs,
Type 17 Auger Point**



- 1" lengths are threaded fully - all other sizes are threaded 2/3's from bottom of the screw
- Case hardened, finishes listed below
- Uses #2 Phillips Drive bits
- Box quantities as shown below
- Sold by the box, bucket or case

Size	Box			Bucket			Bulk		
	Item #	Quick Code	Box Qty	Item #	Quick Code	Bucket Qty	Item #	Quick Code	Bulk Qty
Black Oxidized Finish									
1" x 8	WUWS8X1FCBNPT	L34200	1,000	WUWS8X100FPCSBP	LT34220	7,000	WUWS8X1FCBNPB	L34220	11,000
1-1/4" x 8	WUWS8X114FCBNPT	L34240	1,000	WUWST8X114FCBNPB	LT3426	5,000	WUWS8X114FCBNPB	L34260	9,000
1-1/2" x 8	WUWS8X112FCBNPT	L34280	1,000	WUWST8X112FCBNPB	LT3430	5,000	WUWS8X112FCBNPB	L34300	7,000
1-5/8" x 8	WUWS8X158FCBNPT	L34320	1,000	WUWST8X158FCBNPB	LT3434	3,500	WUWS8X158FCBNPB	L34340	5,500
1-3/4" x 8	WUWS8X134FPCSBT	L34350	1,000	-	-	-	WUWS8X134FPCSB	L34360	4,800
2" x 8	WUWS8X2FCBNPT	L34400	1,000	WUWST8X200FCBNPB	LT3442	3,000	WUWS8X2FCBNPB	L34420	4,000
2-1/4" x 8	-	-	-	WUWST8X214FCBNPB	LT3446	2,500	WUWS8X214FCBNPB	L34460	3,500
2-1/2" x 8	WUWS8X212FCBNPT	L34480	1,000	WUWST8X212FCBNPB	LT3450	2,500	WUWS8X212FCBNPB	L34500	2,500
3" x 8	WUWS8X3FCBNPT	L34560	-	WUWST8X300FCBNPB	LT3458	2,000	WUWS8X3FCBNPB	L34580	2,000
Zinc Finish									
1" x 8	WUWS8X1FCPZNP	L30000	1,000	WUWST8X100FCPZNPB	LT3010	7,000	WUWS8X1FCPZNPB	L30100	11,000
1-1/4" x 8	WUWS8X114FCPZNP	L30200	1,000	WUWST8X114FCPZNPB	LT3030	5,000	WUWS8X114FCPZNPB	L30300	9,000
1-1/2" x 8	WUWS8X112FCPZNP	L30400	1,000	WUWST8X112FCPZNPB	LT3050	5,000	WUWS8X112FCPZNPB	L30500	7,000
1-5/8" x 8	WUWS8X158FCPZNP	L30600	1,000	WUWST8X158FCPZNPB	LT3070	3,500	WUWS8X158FCPZNPB	L30700	5,500
1-3/4" x 8	WUWS8X134FPCSZT	L30795	1,000	-	-	-	WU30798	L30798	4,800
2" x 8	WUWS8X2FCPZNP	L30800	1,000	WUWST8X200FCPZNPB	LT3090	3,000	WUWS8X2FCPZNPB	L30900	4,000
2-1/4" x 8	WUWS8X214FCPZNP	L31000	1,000	WUWS8X214FPCSZP	LT3110	2,500	WUWS8X214FCPZNPB	L31100	3,500
2-1/2" x 8	WUWS8X212FCPZNP	L31200	1,000	WUWST8X212FCPZNPB	LT3130	2,500	WUWS8X212FCPZNPB	L31300	2,500
3" x 8	WUWS8X3FCPZNP	L31400	1,000	WUWST8X300FCPZNPB	LT3150	2,000	WUWS8X3FCPZNPB	L31500	2,000

ASSEMBLY SCREWS



ASSY: Without Nibs, With Sharp 30° Point



Ecofast ASSY: With Nibs, With Sharp 30° Point



ASSY Plus: With Nibs, With Type 2 Drill Point

Flat Head AW® Drive, ASSY Thread With or Without Nibs, Sharp 30° Point or Drill Point



- Patented high tech ASSY thread design provides faster driving and 40% stronger hold
- Patented AW drive system delivers superior torque while virtually eliminating cam-out
- All screw boxes are packaged with one AW insert drive bit
- Thin, lubricated shank reduces wood splitting
- Case hardened, Zinc
- Box quantities as shown below
- Sold by the box

Bit included in each box!

Length x Gauge	Finish	Box Qty	ASSY No Nibs, Sharp 30° Point	Ecofast ASSY w/Nibs Sharp 30° Point	ASSY Plus w/Nibs Type 2 Drill Point
5/8" x 6	Zinc	1,000	WR017043516	-	-
3/4" x 6	Zinc	1,000	WR017043520	-	-
1" x 8	Zinc	1,000	-	WR017014025	WR0165914025
1-3/16" x 8	Zinc	500	-	WR017014030	WR016510430
1-3/8" x 8	Zinc	500	-	WR017014035	WR016510435
1-9/16" x 8	Zinc	500	-	WR017014040	WR016511440
1-3/4" x 8	Zinc	500	-	WR017014045	WR016511445
2" x 8	Zinc	500	-	WR017014050	WR016510450
2-3/8" x 8	Zinc	250	-	WR017014060	WR016510460
2-3/4" x 8	Zinc	250	-	WR017014070	WR016510470
3-1/8" x 9	Zinc	200	-	-	WR0165104580



Turbo Thread Jars



- Our top selling Turbo Thread screw, shown at top of next page, but in convenient smaller jar quantities
- Flip up handle plastic jar is convenient to move around the shop or jobsite
- Sold by the jar

Length x Gauge	Finish	Jar Qty	Item #
1" x 8	Lubricated	500	WU34750-JAR
1-1/4" x 8	Lubricated	500	WU35150-JAR
1-1/2" x 8	Lubricated	500	WU35550-JAR
2" x 8	Lubricated	250	WU35950-JAR
2-1/2" x 8	Lubricated	125	WU36350-JAR
3" x 8	Lubricated	125	WU36705-JAR

FREE 2" DRIVE BIT IN EACH JAR!

A
B
C
D
E
F
G
H
I
J
K
L
M
N
O
P
Q
R
S
T
U
V
W
X
Y

A ASSEMBLY AND FACE FRAME SCREWS

B
C
D
E
F
G
H
I
J
K
L
M
N
O
P
Q
R
S
T
U
V
W
X
Y



Serrated thread for quick start and reduced splitting

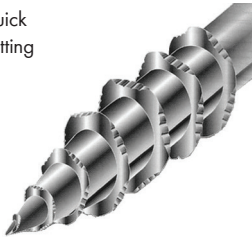

Washer Head Recex (Combo Phillips & Square) Drive Turbo Thread, Regular Point



- Round Washerhead typically used in soft woods to prevent head from sinking into wood
- Patented serrated tooth turbo thread allows for quick starting, reduced splitting, and less drive torque. Used in all woodworking applications: assembly, face frame, slides, hinges and hardware
- 1" lengths are threaded fully - all other sizes are threaded 2/3's from bottom of the screw
- Case hardened, Lubricated
- Uses #2 Square Drive bits to insert; #2 Phillips Drive bits can be used for aftermarket adjustment
- Box quantities as shown below
- Sold by the box

Length x Gauge	Finish	Box Qty	Item #	Quick Code	Bulk Qty	Item #	Quick Code
1" x 8	Lubricated	1,000	WUWS8X1WZCLCT	L34600	8,000	WUWS8X1WZCLCB	L34700
1-1/8" x 8	Lubricated	1,000	WUWS8X118WZCLCT	L34800	6,000	WUWS8X118WZCLCB	L34900
1-1/4" x 8	Lubricated	1,000	WUWS8X114WZCLCT	L35000	6,500	WUWS8X114WZCLCB	L35100
1-3/8" x 8	Lubricated	1,000	WUWS8X138WZCLCT	L35200	5,000	WUWS8X138WZCLCB	L35300
1-1/2" x 8	Lubricated	1,000	WUWS8X112WZCLCT	L35400	5,000	WUWS8X112WZCLCB	L35500
1-3/4" x 8	Lubricated	1,000	WUWS8X134WZCLCT	L35600	-	-	-
2" x 8	Lubricated	1,000	WUWS8X2WZCLCT	L35800	3,000	WUWS8X2WZCLCB	L35900
2-1/4" x 8	Lubricated	1,000	WUWS8X214WZCLCT	L36000	-	-	-
2-1/2" x 8	Lubricated	1,000	WUWS8X212WZCLCT	L36200	2,000	WUWS8X212WZCLCB	L36300
2-3/4" x 8	Lubricated	-	-	-	1,500	WUWS8X234WZCLCB	L36500
3" x 8	Lubricated	1,000	WUWS8X3WZCLCT	L36600	1,500	WUWS8X3WZCLCB	L36700



Modified Pan Head, Square Drive Fine Thread, Type 17 Auger Point



- For hardwoods such as Oak and Maple
- Case hardened, Black
- Uses #2 Square Drive bits
- Box quantities as shown below
- Sold by the box



Length x Gauge	Finish	Box Qty	Item #	Quick Code	Bulk Qty	Item #	Quick Code
1-1/4" x 6	Black	1,000	QS003655	-	8,000	QS002722	-
1-1/2" x 6	Black	1,000	QS003656	-	7,000	QS002724	-
1-1/4" x 7	Black	1,000	WUFF7X114LSSLPT	L16000	7,500	WUFF7X114LSSLPB	L16100
1-1/2" x 7	Black	1,000	WUFF7X112LSSLPT	L16200	6,000	WUFF7X112LSSLPB	L16300

FACE FRAME/POCKETHOLE SCREWS

A
B
C
D
E
F
G
H
I
J
K
L
M
N
O
P
Q
R
S
T
U
V
W
X
Y



Modified Pan Head, Square Drive Fine Thread Double Auger Point



- Minimizes pre-drilling in even the hardest woods
- Case hardened, Lubricated
- Uses #2 Square Drive bits
- Box quantities as shown below
- Sold by the box

Length x Gauge	Std Box Qty	Item #	Bulk Box Qty	Item #
1-1/4" x 6	1,000	QS005706	8,000	QS004082
1-1/2" x 6	1,000	QS005707	7,000	QS005215



Modified Pan Head, Square Drive Hi-Lo Thread, Type 17 Auger Point



- All purpose screw with Hi-Lo thread for greater holding power and less strip out in hardwoods, medium woods, and softwoods
- Case hardened, Lubricated
- Uses #2 Square Drive bits
- Box quantities as shown below
- Sold by the box

Length x Gauge	Finish	Box Qty	Item #	Quick Code	Bulk Qty	Item #	Quick Code
1-1/4" x 7	Lubricated	1,000	WUFF7X114LHCLPT	L15000	7,500	WUFF7X114LHCLPB	L15100
1-1/2" x 7	Lubricated	1,000	WUFF7X112LHCLPT	L15200	6,000	WUFF7X112LHCLPB	L15300



Modified Pan Head, Square Drive Coarse Thread Extra Long Type 17 Auger Point



- Features an extra long aggressive cutting point that cuts through the toughest materials
- Elongated cutting flute reduces splitting and cracking
- Case hardened, Lubricated
- Uses #2 Square Drive bits
- Box quantities as shown below
- Sold by the box

**OUR TOP SELLING
POCKETMASTER SCREW!**

Length x Gauge	Finish	Box Qty	Item #	Quick Code	Bulk Qty	Item #	Quick Code
1-1/4" x 7	Lubricated	1,000	WUFF7X114LCSLPT	L17000	7,500	WUFF7X114LCSLPB	L17100
1-1/2" x 7	Lubricated	1,000	WUFF7X112LCSLPT	L17200	6,000	WUFF7X112LCSLPB	L17300

A FACE FRAME / POKETHOLE SCREWS

B
C
D
E
F
G
H
I
J
K
L
M
N
O
P
Q
R
S
T
U
V
W
X
Y



PocketMaster Jars



- Our top selling Face Frame screw, shown at the bottom of previous page, but in convenient smaller jar quantities
- Flip up handle plastic jar is convenient to move around the shop or jobsite
- Sold by the jar

Length x Gauge	Finish	Jar Qty	Item #
1-1/4" x 7	Lubricated	500	WU17150-JAR
1-1/2" x 7	Lubricated	500	WU17350-JAR

FREE 2" DRIVE BIT IN EACH JAR!



Pan Head Square or Phillips Drive, Fine Thread Type 17 Auger Point



- Standard fine thread for hardwoods such as Oak and Maple
- Case hardened, Black
- Uses #2 Square or Phillips Drive bits
- Box quantities as shown below
- Sold by the box

Length x Gauge	Finish	Box Qty	Item #	Quick Code	Bulk Qty	Item #	Quick Code
Square Drive							
1-1/4" x 6	Black	1,000	WUFF6X114PSSBPT	L12500	10,000	WUFF6X114PSCSBB	L12520
1-1/2" x 6	Black	1,000	WUFF6X112PSSBPT	L12800	8,500	WUFF6X112PSSBPB	L12820
Phillips Drive							
1-1/4" x 6	Black	1,000	WUFF6X114PSPBPT	L10200	10,000	WUFF6X114PSPBPB	L18000



Pan Head Square or Phillips Drive, Coarse Thread Type 17 Auger Point



- Excellent holding in softwoods, MDF and particleboard
- Case hardened, finishes listed below
- Uses #2 Square or Phillips Drive bits
- Box quantities as shown below
- Sold by the box

Length x Gauge	Finish	Box Qty	Item #	Quick Code	Bulk Qty	Item #	Quick Code
Square Drive							
1-1/4" x 6	Black	1,000	WUFF6X114PCSBPT	L12400	10,000	WUFF6X114PCSBPB	L12600
1-1/2" x 6	Black	1,000	WUFF6X112PCSBPT	L12700	8,500	WUFF6X112PCSBPB	L12900
1-1/4" x 7	Black	1,000	WUFF7X114PCSBPT	L12000	7,500	WUFF7X114PCSBPB	L12100
1-1/2" x 7	Black	1,000	WUFF7X112PCSBPT	L12200	6,000	WUFF7X112PCSBPB	L12300
Phillips Drive							
1-1/4" x 6	Lubricated	1,000	WUFF6X114PSPEPT	L10000	10,000	WUFF6X114PSPEPB	L10100

FACE FRAME / POKETHOLE SCREWS



Square Drive



Combo Phillips/Square Drive

Round Washer Head Square or Recex (Combo Phillips & Square) Drive, Coarse Thread, Type 17 Auger Point



- Excellent holding in soft woods, MDF, and particleboard
- Round washer head prevents crushing into the bottom of the face frame hole
- Case hardened, finishes listed below
- Uses #2 Square Drive bits • Box quantities as shown below • Sold by the box

Length x Gauge	Finish	Box Qty	Item #	Quick Code	Bulk Qty	Item #	Quick Code
Square Drive							
1-1/4" x 8	Lubricated	1,000	QS007844	-	8,000	QS004547	-
1-1/2" x 8	Lubricated	1,000	QS009157	-	7,000	QS010032	-
Combo Phillips & Square Drive							
1-1/4" x 8	Black	1,000	WUFF8X114RWCCSBT	L18500	7,000	WUBWRP08114F2F	L18520
1-1/2" x 8	Black	1,000	WUFF8X112FWCCSBT	L18600	5,000	WUFF8X112RWCCSBB	L18620



Round Washer Head Square Drive Fine Thread Type 17 Auger Point



- Standard fine thread for hardwoods such as Oak and Maple
- Prevents the head from crushing into the bottom of the face frame hole
- Case hardened, Black
- Uses #2 Square Drive bits
- Box quantities as shown below • Sold by the box

Length x Gauge	Finish	Box Qty	Item #	Quick Code	Bulk Qty	Item #	Quick Code
1-1/4" x 7	Black	1,000	WUFF7X114RWCSBT	L18705	8,000	WUFF7X114RWCSBB	L18700



Round Washer Square Drive, Fine Thread Type 17 Auger Point



- Standard fine thread for hardwoods such as oak, maple, walnut, cherry, hickory, etc.
- Large washer head provides a superior hold in the bottom of the pocket and prevents the screw from being overdriven
- Case Hardened, Zinc
- Uses #2 Square Drive Bits • Box quantities as shown below • Sold by the box

For Kreg Jigs, Accessories, see Section U
For Kreg Machinery, see Section W

1-1/4" L x 7 Gauge		1-1/2" L x 7 Gauge	
Item #	Box Qty	Item #	Box Qty
KRSMLF125-100	100	KRSMLF150-100	100
KRSMLF125-500	500	KRSMLF150-500	500
KRSMLF125-1200	1,200	KRSMLF150-1200	1,200
KRSMLF125-5000	5,000	-	-

A FACE FRAME / POKETHOLE SCREWS

B
C
D
E
F
G
H
I
J
K
L
M
N
O
P
Q
R
S
T
U
V
W
X
Y



**Round Washer Square Drive, Coarse Thread
Type 17 Auger Point**



For Kreg Jigs, Accessories, see Section U
For Kreg Machinery, see Section W

- Coarse thread for soft woods and composites, Plywood, MDF, Pine, etc.
- Large washer head provides a superior hold in the bottom of the pocket and prevents the screw from being overdriven
- Case Hardened, Zinc finish
- Uses #2 Square Drive Bits
- Box quantities as shown below
- Sold by the box

1" L x 8 Gauge		1-1/4" L x 8 Gauge		1-1/2" L x 8 Gauge		2" L x 8 Gauge		2-1/2" L x 8 Gauge	
Item #	Box Qty	Item #	Box Qty	Item #	Box Qty	Item #	Box Qty	Item #	Box Qty
KRSML-C1-100	100	KRSML-C125-100	100	KRSML-C150-100	100	KRSML-C2-50	50	KRSML-C250-50	50
-	-	KRSML-C125-250	250	-	-	-	-	KRSML-C250-125	125
KRSML-C1-500	500	KRSML-C125-500	500	KRSML-C150-500	500	KRSML-C2-250	250	KRSML-C250-250	250
KRSML-C1-1200	1,200	KRSML-C125-1200	1,200	KRSML-C150-1200	1,200	KRSML-C2-3000	3,000	KRSML-C250-2000	2,000
-	-	KRSML-C125-5000	5,000	-	-	-	-	-	-



**Modified Pan Square Drive, Coarse Thread
Type 17 Auger Point**



For Kreg Jigs, Accessories, see Section U
For Kreg Machinery, see Section W

- Case Hardened, Zinc finish
- Uses #2 Square Drive Bits
- Box quantities as shown below
- Sold by the box

1" L x 6 Gauge			
Item #	Box Qty	Item #	Box Qty
KRSPS-C1-100	100	KRSPS-C1-500	500
KRSPS-C1-250	250	KRSPS-C1-1200	1,200



**Modified Pan Square Drive, Fine Thread
Type 17 Auger Point**



For Kreg Jigs, Accessories, see Section U
For Kreg Machinery, see Section W

- Standard fine thread for hardwoods such as oak, maple, walnut, cherry, hickory, etc.
- Case Hardened, Zinc finish
- Uses #2 Square Drive Bits
- Box quantities as shown below
- Sold by the box

3/4" L x 6 Gauge		1" L x 6 Gauge		1-1/4" L x 6 Gauge		1-1/2" L x 6 Gauge	
Item #	Box Qty	Item #	Box Qty	Item #	Box Qty	Item #	Box Qty
KRSPS-F075-100	100	KRSPS-F1-100	100	KRSPS-F125-100	100	KRSPS-F150-100	100
KRSPS-F075-500	500	KRSPS-F1-500	500	KRSPS-F125-500	500	KRSPS-F150-500	500
KRSPS-F075-1200	1,200	KRSPS-F1-1200	1,200	KRSPS-F125-1200	1,200	KRSPS-F150-1200	1,200

INSTALLATION SCREWS



Washer Head Recex (Combo Phillips & Square) Drive, Quickcutter Thread Type 17 Auger Point



- Case hardened, Zinc
- Uses #2 Square Drive bits to insert & #2 Phillips Drive bits for aftermarket adjustment
- Box quantities as shown below
- Sold by the box

Length x Gauge	Box Qty	Item #	Bulk Qty	Item #
Zinc With Zinc Head				
2-1/2" x 10	500	QS008335	1,500	QS007927
3" x 10	500	QS008337	1,500	QS007935
3-1/2" x 10	500	QS008343	1,000	QS007936
4" x 10	-	-	1,000	QS007937
Zinc With White Head				
2-1/2" x 10	-	-	1,500	QS008010
3" x 10	500	QS008345	1,500	QS008011
4" x 10	-	-	1,000	QS008013



Washer Head Recex (Combo Phillips & Square Drive), Coarse Thread Regular Point



- Case hardened, finishes listed below
- Uses #2 Square drive bit to insert & #2 Phillips Drive bit for aftermarket adjustment
- Box quantities as shown below
- Sold by the box

Length x Gauge	Finish	Box Qty	Item #	Quick Code	Bulk Qty	Item #	Quick Code
Regular Point, .375" Diameter Head							
2-1/2" x 8	Black	-	-	-	2,000	WUWS8X212WCCBB	L38990
3" x 8	Black	-	-	-	1,500	WUWS8X300WCCBB	L38995
1-1/8" x 8	Zinc	-	-	-	6,500	WUWS8X118WCCZB	L82600
2-1/2" x 8	Zinc	-	-	-	2,000	WUWS8X212WCCZB	L39770
3" x 8	Zinc	-	-	-	1,500	WUWS8X300WCCZB	L39785
Regular Point, .443" Diameter Head							
2-1/2" X 10	Zinc	500	WUWS10X212WCCZ500	L39350	1,500	WUWS10X212WCCZB	L39360
3" X 10	Zinc	500	WUWS10X300WCCZ500	L39370	1,500	WUWS10X300WCCZB	L30995
3-1/2" X 10	Zinc	800	WUWS10X312WCCZ800	L39385	-	-	-
2-1/2" X 10	Zinc w/ White Head	-	-	-	1,500	WUWS10X212WCCZWB	L39320
3" X 10	Zinc w/ White Head	-	-	-	1,000	WUWS10X300WCCZWT	L39335

A
B
C
D
E
F
G
H
I
J
K
L
M
N
O
P
Q
R
S
T
U
V
W
X
Y

A INSTALLATION SCREWS

B
C
D
E
F
G
H
I
J
K
L
M
N
O
P
Q
R
S
T
U
V
W
X
Y



Truss Head Phillips Drive, Fine Thread (2/3 Thread) Needle Point



For use with Metal Studs

- #8 gauge needle point for light metal studs and sheetmetal
- Large truss head provides large bearing surface and hides rough screw hole edges
- Case hardened, finishes listed below
- Uses #2 Phillips Drive bits
- Box quantities as shown below • Sold by the box

Length x Gauge	Finish	Box Qty	Item #	Quick Code
2-1/2" x 8	Zinc with White Head	2,000	WUWS8X214TPFNPB	L39140
2-1/2" x 8	Zinc with Zinc Head	2,000	WUWS8X212TPFNZB	L39160



Truss Head Phillips Drive, Fine Thread (Full Thread) #2 Drill Point



For use with Metal Studs

- #2 drill point for use on heavier gauge metal studs. Eliminates the need for pilot hole/pre drilling studs
- Large truss head provides large bearing surface and hides rough edges
- Case hardened, finishes listed below
- Uses #3 Phillips Drive bits
- Box quantities as shown below • Sold by the box

Length x Gauge	Finish	Box Qty	Item #	Quick Code	Bulk Qty	Item #	Quick Code
2-1/2" x 10	Zinc with White Head	500	WUWS10X212TPFDP500	L39180	-	-	-
2-1/2" x 10	Zinc with Zinc Head	-	-	-	2,000	WUWS10X212TPFDZB	L39185



Truss Head, Coarse Thread (1/2 Thread) Needle Point



For use with Wood Studs

- Deep thread for secure fastening to wood studs
- Large truss head provides large bearing surface and hides rough edges
- 1/2" head allows cabinet to "float" for final adjustment
- Case hardened, finishes listed below
- Uses #3 Phillips Drive bits
- Box quantities as shown below • Sold by the box

Length x Gauge	Finish	Box Qty	Item #	Quick Code	Bulk Qty	Item #	Quick Code
Phillips Drive							
2-1/2" x 10	Zinc with Sand Head	500	WUWS10X212TPCNP500	L37020	-	-	
3" x 10	Zinc with Sand Head	500	WUWS10X300TPCNP500	L37060	1,000	WUWS10X300TPCNPT	L37065
3" x 10	Zinc with White Head	-	-		1,000	WUWS10X300TPCNZT	L37055
2-1/2" x 10	Zinc with Zinc Head	-	-		1,500	WUWS10X212TPCNZB	L37045
3" x 10	Zinc with Zinc Head	100	WUWS10X3RCPZPH	L38300	500	WUWS10X300TPCNZ500	L37075
Recex (Combo Phillips & Square Drive)							
2-1/2" x 10	Zinc with White Head	-	-	-	1,000	WUWS10X212WCSWPT	L38600

INSTALLATION/TRIM SCREWS

A
B
C
D
E
F
G
H
I
J
K
L
M
N
O
P
Q
R
S
T
U
V
W
X
Y



Oversized Flat Head Drive, Coarse Thread, Type 17 Auger Point



- Fastcap PowerHead Screws for wood or metal studs
- Head diameter of 9/16" (.5625")
- Case hardened, finishes listed below
- Uses #2 Square or Torx drive bits
- Box quantities as shown below
- Sold by the box

Length x Gauge	Finish	Box Qty	Item #	Bulk Qty	Item #
Square Drive, Wood Studs					
2-1/2" x 8	Black	150	FCPHBL2.5-150PC	-	-
3" x 8	Black	150	FCPHBL3-150PC	1,500	FCPHBL3-1500
1-1/4" x 8	Zinc	200	FCPH1.25-200SQ	-	-
2-1/2" x 8	Zinc	150	FCPHZ2.5-150PC	1,500	FCPHZ2.5-1500PC
3" x 8	Zinc	150	FCPHZ3-150PC	-	-
Torx Drive, Wood Studs					
1-1/4" x 8	Zinc	200	FCPH1.25-200PC	2,000	FCPH1.25-2000PC
2" x 8	Zinc	200	FCPH2-200PC	-	-
2-1/2" x 8	Zinc	150	FCPH2.5-150PC	1,500	FCPH2.5-1500PC
3" x 8*	Zinc	150	FCPH3-150PC	1,500	FCPH3-1500PC
3-1/2" x 8	Zinc	100	FCPH3.5-100PC	-	-
4" x 8	Zinc	100	FCPH4-100PC	1,000	FCPH4-1000PC
Square Drive, Metal Studs					
3" x 8	Zinc	150	FCPHZ8ME3-150PC	1,500	FCPHZ8ME3-1500PC

*3" x 8 Torx also available in 50 pack:
FCPH3-50PC



Trim-It Screws, Square Drive, Twinfast Thread, Sharp Point



- Normally used for fastening trim moldings or jams
- Extremely small head (7/32") is hardly seen; can be countersunk and puttied over
- Type "A" point is very sharp and eliminates pre-drilling in most materials
- Case hardened, Black
- #6 screws use #1 Square Drive bits; #8 screws use #2 Square Drive bits
- Box quantities as shown below
- Sold by the box

Length x Gauge	Finish	Box Qty	Item #	Quick Code	Bulk Qty	Item #	Quick Code
1-5/8" x 6	Black	100	WUDW6X158TSSBH	L24000	1,000	WUWS6X158TFSBT	L24010
2-1/4" x 6	Black	100	WUDW6X214TSSBH	L24100	1,000	WUWS6X214TFSBT	L24120
3" x 8	Black	100	WUWS8X300TFSBH	L24200	-	-	-

A DRYWALL SCREWS

B
C
D
E
F
G
H
I
J
K
L
M
N
O
P
Q
R
S
T
U
V
W
X
Y



**Bugle Head Phillips Drive,
Coarse Thread, Sharp Point**



- Fully threaded
- Case hardened, Black
- Uses #2 Phillips Drive bits
- Box quantities as shown on right
- Sold by the box

Length x Gauge	Finish	Box Qty	Item #	Quick Code	Bulk Qty	Item #	Quick Code
1" x 7	Black	1,000	WUDW7X1BCPBT	L19000	10,000	WUDW7X1BCPBB	L19010
1-1/8" x 7	Black	-	-	-	10,000	WUDW7X118BPCBB	L19110
1-1/4" x 7	Black	1,000	WUDW7X114BCPBT	L19200	8,000	WUDW7X114BCPBB	L19210
1-1/2" x 7	Black	1,000	WUDW7X112BCPBT	L20400	6,000	WUDW7X112BCPBB	L20500
1-5/8" x 7	Black	1,000	WUDW7X158BCPBT	L19300	5,000	WUDW7X158BCPBB	L19310
2" x 7	Black	-	-	-	3,500	WUDW7X2BCPBB	L19410
2-1/4" x 7	Black	1,000	WUDW7X214BCPBT	L19500	3,000	WUDW7X214BCPBB	L19510
2-1/2" x 8	Black	1,000	WUDW8X212BCPBT	L21000	2,500	WUDW8X212BCPBB	L21100
3" x 8	Black	-	WUDW8X3BCPBT	L21300	2,000	WUDW8X3BCPBB	L21400
4" x 10	Black	1,000	WUDW10X400BCBT	L29340	-	-	-



**Bugle Head Phillips Drive
Coarse Thread, Sharp Point**



- #2 Phillips Drive, Coarse Thread
- Used for fastening a combination of woods, metals, plastics, fiberglass and more
- Bugle head design countersinks neatly into drywall and eliminates unsightly head pops
- Manufactured in an ISO 9001 factory from 1022 case hardened steel and feature rolled threads for exceptional strength and holding power
- Box quantities as shown below • Sold by the box

**FREE 1-1/2" X #2
PHILLIPS INSERT BIT
INCLUDED IN
EACH 5 LB BOX!**

Length x Gauge	Finish	Approx Box Qty (5 lb Box)	Item #	Approx Box Qty (1/4 Keg)	Item #
1" x 6	Black	1,770	THD1DWC5	10,000	THD1DWCK
1-1/4" x 6	Black	1,425	THD114DWC5	8,000	THD114DWCK
1-5/8" x 6	Black	1,175	THD158DWC5	-	-
2-1/2" x 8	Black	570	THD212DWC5	2,500	THD212DWCK
3" x 8	Black	465	THD3DWC5	2,000	THD3DWCK



**Bugle Head Phillips Drive,
Fine Thread, Sharp Point**



- Fully threaded the length of the screw
- Case hardened, Black
- Uses #2 Phillips Drive bits
- Box quantities as shown below • Sold by the box

Length x Gauge	Finish	Box Qty	Item #	Quick Code
1-1/4" x 7	Black	8,000	WUDW7X114BPFBB	L29200
1-5/8" x 7	Black	5,000	WUDW7X158BPFBB	L29220

HINGE, SLIDE & HARDWARE SCREWS

A
B
C
D
E
F
G
H
I
J
K
L
M
N
O
P
Q
R
S
T
U
V
W
X
Y



Truss Head Phillips Drive, Coarse Thread Type 17 Auger Point



- Large truss head reduces sinking of head in soft woods
- Designed to prevent splitting in hardwoods when attached into or near the edge of material
- Case hardened, finishes listed below
- Uses #2 Phillips Drive bits
- Box quantities as shown below
- Sold by the box

Length x Gauge	Finish	Box Qty	Item #	Quick Code	Bulk Qty	Item #	Quick Code
5/8" x 8	Zinc	1,000	WUMS8X58TPCSZT	L58120	10,000	WUMS8X58TPCSZB	L58130
3/4" x 8	Zinc	1,000	WUMS8X34TPCSZT	L58140	10,000	WUMS8X34TPCSZB	L58150
5/8" x 8	Antique English	1,000	WUMS8X58TPCSAT	L59120	10,000	WUMS8X58TPCSAB	L59130



Truss Head Recex (Combo Phillips & Square) Drive Coarse Thread, Extra Long Type 17 Auger Point



- Extra long aggressive cutting point that cuts through the toughest materials
- Elongated cutting flute greatly reduces splitting and cracking
- Case hardened, Zinc
- Uses #2 Square Drive bits for insertion and #2 Phillips Drive bits for aftermarket adjustment
- Box quantities as shown below
- Sold by the box

Length x Gauge	Finish	Box Qty	Item #	Quick Code	Bulk Qty	Item #	Quick Code
3/4" x 8	Zinc	1,000	WUMS8X34TCCEZT	L59000	12,000	WUMS8X34TCCEZB	L59050



.366" Diameter Head

Truss Head (Combo Phillips & Square) Drive, Coarse Thread, Regular Point



- Case hardened, Zinc
- Uses #2 Square Drive bits for insertion and #2 Phillips Drive bits for aftermarket adjustment
- Box quantities as shown below
- Sold by the box

Length x Gauge	Finish	Box Qty	Item #	Quick Code	Bulk Qty	Item #	Quick Code
7/16" x 8	Zinc	1,000	WUMS8X716LTCCZ6T	L44120	5,000	WUMS8X716LTCCZB	L44125

A HINGE, SLIDE & HARDWARE SCREWS



.366" Diameter Head

Truss Head Low Profile Phillips Drive Coarse Thread, Regular Point



- Low Truss Head screw for use on ball bearing slides
- Case hardened, finishes listed below
- Uses #2 Phillips Drive bits
- Box quantities as shown below
- Sold by the box

Length x Gauge	Finish	Box Qty	Item #	Quick Code	Bulk Qty	Item #	Quick Code
7/16" x 8	Zinc	1,000	WUMS8X716RSPZT	L46000	5,000	WUMS8X716TPCW	L46005
7/16" x 8	Zinc	-	-	-	14,000	WUMS8X716RSPZB	L46010
7/16" x 8	Black	1,000	-	-	5,000	WUMS8X716LTPCBB	L46150
7/16" x 8	White	1,000	WUMS8X716RSPWT	L46200	-	-	-



Type 17 Auger Point

Modified Truss Phillips Drive Fine or Coarse Thread, Regular or Type 17 Auger Point



- Uses #2 Phillips Drive bits
- Case hardened, finishes listed below
- Box quantities as shown below
- Sold by the box



Regular Point

Length x Gauge	Finish	Box Qty	Item #	Quick Code	Bulk Qty	Item #	Quick Code
Type 17 Auger Point, Coarse Thread							
3/4" x 8	Nickel	1,000	WUMS8X34MCPNPT	L46300	-	-	-
Regular Point, Coarse Thread							
1/2" x 8	Zinc	1,000	WUMS8X12CSPZT	L46750	5,000	WUMS8X12WPCZB	L46790
Regular Point, Fine Thread							
1/2" x 8	Zinc	1,000	WUMS8X12MSPZT	L46700	-	-	-

HINGE, SLIDE & HARDWARE SCREWS

Flat Head Phillips Drive, Chipboard Thread, Sharp Point

Length x Gauge	Finish	Box Qty	Item #	Quick Code	Bulk Qty	Item #	Quick Code
5/8" x 6	Nickel	1,000	WUMS6X58FSPNT	L52100	-	-	-
3/4" x 6	Nickel	1,000	WUMS6X34FSPNT	L52000	-	-	-
1/2" x 5	Zinc	100	WUMS5X12FPFZH	L40205	1,000	WUMS5X12FSPZT	L40200
1/2" x 6	Zinc	100	-	-	1,000	WUMS6X12FSPZT	L41100
5/8" x 5	Zinc	100	WUMS5X58FPFH	L40505	1,000	WUMS5X58FSPZT	L40500
5/8" x 6	Zinc	100	WUMS6X58FPFZH	L41210	1,000	WUMS6X58FSPZT	L41900
5/8" x 6	Zinc	-	-	-	30,000	WUMS6X58FSPZB	L41200
5/8" x 8	Zinc	100	-	-	1,000	WUMS8X58FSPZT	L41800
3/4" x 6	Zinc	100	WUMS6X34FPFZH	L41410	1,000	WUMS6X34FSPZT	L41400
3/4" x 8	Zinc	-	-	-	1,000	WUMS8X34FPZT	L41950
5/8" x 5	Black	1,000	WUMS8X58FSPBT	L41700	-	-	-
1/2" x 5	Bright Brass	-	-	-	1,000	WUMS5X12FSPRT	L40400
5/8" x 5	Bright Brass	-	-	-	1,000	WUMS5X58FSPRT	L40700
5/8" x 6	Bright Brass	-	-	-	1,000	WUMS6X58FSPBT	L41350
5/8" x 5	Antique English	100	WUMS5X58FPFAH	L40605	1,000	WUMS5X58FSPQT	L40600
5/8" x 6	Antique English	100	-	-	1,000	WUMS6X58FSPQT	L41300



- Steel wood screws in short sizes for hinges, KD fittings, piano hinges and small assembly
- Holds in both hardwoods and softwoods
- Chipboard screws are similar to coarse thread screws with just one additional thread
- Case hardened, finishes listed on left
- Uses #2 Phillips Drive bits
- Sold by the box



Flat Head Phillips Drive, Coarse Thread, Regular Point

Length x Gauge	Finish	Box Qty	Item #	Quick Code	Bulk Qty	Item #	Quick Code
1/2" x 6	Antique English	-	-	-	18,000	WUMS6X12FCPQT	L42000
5/8" x 6	Antique Brass	1,000	WUMS6X58FCPQT	L42200	-	-	-
1/2" x 5	Zinc	1,000	WUMS5X12FPCZT	L42075	5,000	WUMS5X12FPCZB	L42050
5/8" x 5	Zinc	1,000	WUMS5X58FPCZT	L42080	5,000	WUMS5X58FPCZB	L42070
1/2" x 6	Zinc	1,000	WUMS6X12FPCZT	L42100	5,000	WUMS6X12FPCZB	L42150
5/8" x 6	Zinc	1,000	WUMS6X58FPCZT	L42300	5,000	WUMS6X58FPCZ5B	L42390
5/8" x 6	Zinc	-	-	-	30,000	WUMS6X58FPCZB	L42400
3/4" x 6	Zinc	1,000	WUMS6X34FPCZT	L42500	5,000	WUMS6X34FPCZB	L43150
1" x 6	Zinc	1,000	WUMS6X1FSPZT	L38120	-	-	-
3/4" x 8*	Zinc	1,000	QS005790	-	12,000	QS000128	-
5/8" x 5	Nickel	-	-	-	32,000	WUMS5X58FCPNB	L54100
1/2" x 6	Nickel	1,000	WUMS6X12FCPNT	L54200	5,000	WUMS6X12FCPNB	L54300
5/8" x 6	Nickel	1,000	WUMS6X58FCPNT	L54375	5,000	WUMS6X58FCPN5B	L54380
5/8" x 6	Nickel	-	-	-	30,000	WUMS6X58FCPNB	L54400
3/4" x 6	Nickel	1,000	WUMS6X34FCPNT	L54680	5,000	WUMS6X34FCPNB	L54690
3/4" x 6	Nickel	-	-	-	24,000	WUMS6X34FCPNB	L54700
1" x 6	Nickel	1,000	WUMS6X1FCPNT	L54900	-	-	-
5/8" x 7	Nickel	1,000	WUMS7X58CPNT	L46800	24,000	WUMS7X58CPNB	L46900
5/8" x 7*	Nickel	100	QS004991	-	5,000	QS005901	-
3/4" x 7	Nickel	1,000	WUMS7X34FCPNT	L43700	5,000	WUMS7X34FCPNB	L43750



- Case hardened, finishes listed below
- Uses #2 Phillips Drive bits
- Box quantities as shown on left
- Sold by the box



A HINGE, SLIDE & HARDWARE SCREWS

**Flat Head Phillips Drive,
Coarse Thread, Type 17 Auger Point**

- Case hardened, Zinc
- Uses #2 Phillips Drive bits
- Box quantities as shown below
- Sold by the box

Length x Gauge	Finish	Box Qty	Item #	Quick Code	Bulk Qty	Item #	Quick Code
5/8" x 6	Zinc	1,000	WUMS6X58FCPZPT	L43000	5,000	WUMS6X58FPCSZB	L43020
3/4" x 6	Zinc	1,000	WUMS6X34FPCSZT	L43100	5,000	WR1LFXP06034S2Z-2	L54765

**Square Drive, Coarse Thread
Regular or Type 17 Auger Point**

- Case hardened, finishes listed below
- Uses #2 Square Drive bits
- Box quantities as shown below
- Sold by the box

Length x Gauge	Finish	Box Qty	Item #	Quick Code	Bulk Qty	Item #	Quick Code
Regular Point							
1/2" x 6	Zinc	1,000	WUMS6X12FSCZT	L53100	-	-	-
Type 17 Auger Point							
5/8" x 6	Zinc	1,000	WUMS6X58FSZT	L53250	30,000	WUMS6X58FSSZPB	L53200
3/4" x 6	Zinc	1,000	WUMS6X34FSPZPT	L53400	-	-	-

**Flat Head Recex (Combo Phillips/
Square Drive) Coarse Thread,
Regular Point**

- Case hardened, Zinc
- Uses #2 Phillips Drive bits for insertion and #2 Phillips Drive bits for aftermarket adjustment
- Box quantities as shown below
- Sold by the box

Length x Gauge	Finish	Box Qty	Item #	Quick Code	Bulk Qty	Item #	Quick Code
1/2" x 6	Zinc	1,000	WUMS6X12FCCZT	L39080	-	-	-
5/8" x 6	Zinc	1,000	WUMS6X58FCCZT	L39090	15,000	WUMS6X58FCCZB	L39085

HINGE, SLIDE & HARDWARE SCREWS

A
B
C
D
E
F
G
H
I
J
K
L
M
N
O
P
Q
R
S
T
U
V
W
X
Y



**Flat or Round Head Phillips Drive
Coarse Thread, Sharp Point**



- Case hardened, Nickel
- Uses #2 Phillips Drive bits
- Box quantities as shown below
- Sold by the box

Head Type	Length x Gauge	Finish	Box Qty	Item #
Flat	5/8" x 6	Nickel	500	G81001-43
Flat	3/4" x 6	Nickel	500	G6X34FHNI



**Undercut Flat Head Phillips Drive,
Coarse Thread, Regular Point**



- Undercut head sits flush in the recessed hole of European drawer slides
- Case hardened, finishes listed below
- Uses #2 Phillips Drive bits
- Box quantities as shown below
- Sold by the box

Length x Gauge	Finish	Box Qty	Item #	Quick Code	Bulk Qty	Item #	Quick Code
1/2" x 6	Zinc	1,000	WUMS6X12CPBCZT	L43250	33,000	-	-
5/8" x 6	Zinc	1,000	WUMS6X58CPBCZT	L43420	30,000	WUMS6X58UPCAB	L43440



**Pan Head, Fine or Chipboard
Thread, Regular Point**



- Steel wood screws in short sizes for hinges, KD fittings and small assembly
- Holds in both hardwoods and softwoods
- Chipboard screws are similar to coarse thread screws with just one additional thread
- Case hardened, finishes listed below
- Uses #2 Phillips Drive bits
- Box quantities as shown below
- Sold by the box

Length x Gauge	Finish	Box Qty	Item #	Quick Code
Fine Thread				
1/2" x 6	Zinc	1,000	WUMS6X12TPFAZT	L44060
1/2" x 8	Zinc	1,000	WUMS8X12TPFAZT	L44130
5/8" x 6	Zinc	1,000	WUMS6X58TPFAZT	L44165
Chipboard Thread				
1/2" x 6	Antique Brass	1,000	WUMS6X12PSPQT	L45200
1/2" x 6	Zinc	1,000	WUMS6X12PSPZT	L45300

A HINGE, SLIDE & HARDWARE SCREWS

Regular Point



Type 17 Auger Point

**Pan Head Phillips Drive,
Coarse Thread Regular or
Type 17 Auger Point**

- Edge application screws are designed to prevent splitting in hardwoods when hardware is attached into or near the edge of the material
- Used with European style face frame hinges, pin and pivot hinges, or with catches and latches
- Case hardened, finishes listed below
- Uses #2 Phillips Drive bits
- Box quantities as shown below
- Sold by the box

Length x Gauge	Finish	Box Qty	Item #	Quick Code	Bulk Qty	Item #	Quick Code
Regular Point							
5/8" x 8	Antique Brass	1,000	WUMS8X58PCPQT	L45500	-	-	-
5/8" x 10	Nickel	1,000	WUMS10X58PCPNT	L45600	-	-	-
3/4" x 10	Nickel	1,000	WUMS10X34PCPNT	L45800	9,000	WUMS10X34PCPNB	L45700
1" x 10	Nickel	1,000	WUMS10X100PCPNT	L45810	-	-	-
Type 17 Auger Point							
5/8" x 10	Nickel	1,000	WUMS10X58PPCSZT	L45630	-	-	-
3/4" x 10	Nickel	1,000	WUMS10X34PPCSNT	L45820	9,000	WUMS10X34PCPZPB	L45830
5/8" x 6	Antique English	1,000	WUMS6X58PPCSAT	L45330	-	-	-
1/2" x 6	Zinc	1,000	WUMS6X12PCPZPT	L45230	-	-	-
5/8" x 6	Zinc	1,000	WUMS6X58PPCSZT	L45340	-	-	-
5/8" x 8	Zinc	1,000	WUMS8X58PPCSZT	L45560	15,000	WUMS8X58PPCSZB	L45570
3/4" x 8	Zinc	1,000	WUMS8X34PCPZPT	L46500	10,000	WUMS8X34PPCSZB	L46520

**Washer Head Recex
(Combo Phillips & Square) Drive
Coarse Thread Type 17 Auger Point**

- Edge application screws prevent splitting in hardwoods when hardware is attached into or near the edge of the material. Used with European style face frame hinges, pin and pivot hinges, or with catches and latches
- Case hardened, finishes listed below
- Uses #2 Square Drive bits for insertion and #2 Phillips Drive bits for aftermarket adjustment
- Box quantities as shown below
- Sold by the box

Length x Gauge	Finish	Box Qty	Item #	Quick Code	Bulk Qty	Item #	Quick Code
3/4" x 8	Lubricated	1,000	WUM8X34SRWCCSPT	L39390	-	-	-
3/4" x 8	Zinc	1,000	WUMS8X34RWCCSZT	L55500	10,000	WUMS8X34RWCCSZB	L55550

HINGE, SLIDE & HARDWARE SCREWS



Oval Head Phillips Drive, Fine Thread, Sharp Point



- Oval head countersinks like flat head with slightly rounded head
- Steel wood screws in short sizes for hinges, KD fittings and small assembly
- Case hardened, finishes listed below
- Uses #2 Phillips Drive bits
- Box quantities as shown below
- Sold by the box

Length x Gauge	Finish	Box Qty	Item #	Quick Code
5/8" x 5	Zinc	1,000	WUMS5X58OPFSZT	L50050



Phillips Drive, Type 17 Auger Point



Recex Drive, Type 17 Auger Point

Modified Washer Head Phillips or Recex (Combo Phillips & Square) Drive, Coarse Thread Type 17 Auger Drive, Drawer Front Adjusting Screw

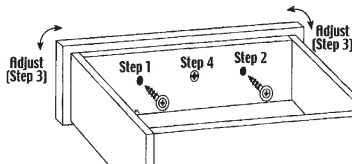

1. Drill oversize 5/16" hole in drawer box.
2. Attach drawer front.
3. Adjust drawer front.
4. Fix drawer front with knob or pull screws.

- 1/2" diameter washer head screw
- Uses #2 Phillips or Square Drive bits
- Case Hardened, Zinc
- Box quantities as shown below
- Sold by the box

Length x Gauge	Box Qty	Item #	Quick Code	Box Qty	Item #	Quick Code	Box Qty	Item #	Quick Code
Phillips Drive									
7/8" x 8	-	-	-	-	WUDF8X78MCPZT	L80000	-	-	-
1" x 8	100	WUDF8X1MCPZH	L80110	1,000	WUDF8X1MCPZT	L80330	7,000	WUDF8X100MWPCSZB	L80340
1-1/8" x 8	-	-	-	-	WUDF8X118MCPZT	L80450	6,500	WUDF8X118MWPCSZB	L80760
1-1/4" x 8	100	WUDF8X114MCPZH	L81810	1,000	WUDF8X114MCPZT	L80750	6,500	WUDF8X114MWPCZB	L80930
1-1/2" x 8	-	-	-	-	WUDF8X112MCPZT	L81010	-	-	-
Recex (Combo Phillips & Square) Drive									
1" x 8	-	-	-	1,000	WUDF8X100MWCCSZT	L81200	7,000	WUDF8X100MWCCSZB	L81300
1-1/8" x 8	-	-	-	1,000	WUDF8X118MWCCSZT	L81500	6,500	WUDF8X118MCPZB	L81600
1-1/4" x 8	-	-	-	1,000	WUDF8X114MWCCSZT	L81800	6,500	WU8114S2ZB	L81900
Phillips Drive - Quickscrews									
7/8" x 8	1,000	QS009147	-	-	-	-	-	-	-
1-1/8" x 8	1,000	QS009149	-	6,000	QS009024	-	-	-	-
1-1/4 x 8*	-	-	-	6,000	QS004103	-	-	-	-
Recex (Combo Phillips & Square Drive) - Quickscrews									
1-1/8" x 8	-	-	-	6,000	QS012626	-	-	-	-
1-1/4" x 8	1,000	QS012671	-	6,000	QS012627	-	-	-	-

*Standard Point, not Type 17

A
B
C
D
E
F
G
H
I
J
K
L
M
N
O
P
Q
R
S
T
U
V
W
X
Y

A DECORATIVE HARDWARE SCREWS

B
C
D
E
F
G
H
I
J
K
L
M
N
O
P
Q
R
S
T
U
V
W
X
Y



**M4 Thread Machine Screws,
Combo Phillips/Slotted Drive**



- For use with M4 threaded visual hardware
- For surface mounted knobs and pulls it is recommended that the screw length be 6mm (1/4") greater than the material thickness
- Uses #2 Phillips Drive bit
- Box quantities as shown below
- Sold by the box

Length	Finish	Box Qty	Item #	Quick Code
7/8" (22mm)	Zinc	100	WUMS4X22RSPZH	L48340
1" (25mm)	Zinc	100	WUMS4X25RSPZH	L48400
1-3/16" (30mm)	Zinc	100	WUMS4X30M4BZ100	L48450
1-3/8" (35mm)	Zinc	100	WUMS4X35RSPZH	L48500
1-5/8" (39mm)	Zinc	100	WUMS4X39RSPZH	L48600



**M4 Thread (Breakaway), Machine
Screws Combo Phillips/Slotted Drive**



- For use with M4 threaded visual hardware
- 45mm long with break-a-ways at 19mm, 25mm, 32mm, and 38mm
- Uses #2 Phillips Drive bit
- Box quantities as shown below
- Sold by the box

Length	Finish	Box Qty	Item #	Quick Code
1-3/4" (45mm)	Zinc	100	WUMS4X45RBPZH	L48900



**LOOKING FOR HELP WITH
QUICK & EASY INSTALLATION
OF DECORATIVE HARDWARE?
See True Position Jigs in Section U**



DECORATIVE HARDWARE SCREWS

A
B
C
D
E
F
G
H
I
J
K
L
M
N
O
P
Q
R
S
T
U
V
W
X
Y



**8-32 Thread Machine Screws
Combo Phillips/Slotted Drive**



- For surface mounted knobs and pulls screw length should be 1/4" greater than the material thickness
- Uses #2 Phillips Drive bit
- Box quantities as shown below
- Sold by the box

Length	Finish	Box Qty	Item #	Quick Code	Bulk Qty	Item #	Quick Code
1/2"	Zinc	100	WUMS832X12RSPZH	L47000	1,000	WUMS832X12RSPZT	L47120
5/8"	Zinc	100	-	-	1,000	WUMS832X58RSPZT	L46950
3/4"	Zinc	100	WUMS832X34RSPZH	L47100	1,000	WUMS832X34RSPZT	L47130
7/8"	Zinc	100	WUMS832X78RSPZH	L47200	1,000	WUMS832X78RSPZT	L47220
1"	Zinc	100	WUMS832X1RSPZH	L47300	1,000	WUMS832X1RSPZT	L47320
1-1/8"	Zinc	100	WUMS832X118RSPZH	L47400	1,000	WUMS832X118RSPZT	L47420
1-1/4"	Zinc	100	WUMS832X114RSPZH	L47500	1,000	WUMS832X114RSPZT	L47520
1-3/8"	Zinc	100	WUMS832X138RSPZH	L47600	1,000	WUMS832X138RSPZT	L47620
1-1/2"	Zinc	100	WUMS832X112RSPZH	L47700	1,000	WUMS832X112RSPZT	L47720
1-5/8"	Zinc	100	WUMS832X158RSPZH	L47800	1,000	WUMS832X158RSPZT	L47820
1-3/4"	Zinc	100	WUMS832X134RSPZH	L47900	1,000	WUMS832X134RSPZT	L47920
2"	Zinc	100	WUMS832X2RSPZH	L48000	1,000	WUMS832X2RSPZT	L48020



**8-32 Thread (Breakaway)
Combo Phillips/Slotted Drive**



- For use with 8-32 thread visual hardware
- 1-3/4" long with break-a-ways at 3/4", 1", 1-1/4" and 1-1/2"
- Uses #2 Phillips Drive bit
- Box quantities as shown below
- Sold by the box

Length	Finish	Box Qty	Item #	Quick Code	Bulk Qty	Item #	Quick Code
1-3/4"	Zinc	100	WUMS832X134RBPZH	L48700	1,000	WUMS832X134RBPZT	L48720

A EURO SCREWS



**Flat Head, Pozidrive,
7.2mm Head Diameter**



- Case hardened, Nickel
- Uses #2 Pozidrive bits
- Box quantities as shown below
- Sold by the box

Length	Finish	Box Qty	Item #	Quick Code
7.5mm	Nickel	1,000	WUES7.2X75FSZENT	L59920
10mm	Nickel	1,000	WUES5X10FSZNT	L60000
11.5mm	Nickel	1,000	WUES5X115FSZNT	L60100
13mm	Nickel	1,000	WUES5X13FSZNT	L60200
14.5mm	Nickel	1,000	WUES5X145FSZNT	L60300
20mm	Nickel	1,000	WUES7.2X20FSZENT	L60420
25mm	Nickel	1,000	WUES7.2X25FSZENH	L60520



#2 Phillips Drive

**Flat Head, #2 Phillips or
Square Drive, 7.5mm Head Diameter**



- Case hardened, Nickel
- Box quantities as shown below
- Sold by the box



#2 Square Drive

Length	Finish	Box Qty	Item #	Quick Code
#2 Phillips Drive				
13mm	Nickel	1,000	WUES7.5X13FPENT	L60260
#2 Square Drive				
13mm	Nickel	1,000	WUES7.5X13FSENT	L60250
#2 Pozidrive				
20mm	Nickel	1,000	WUES5X20FSZNH	L60400
25mm	Nickel	1,000	WUES5X25FSZNH	L60500



#2 Pozidrive

**Flat Head, #2 Phillips or
Square Drive, 7.5mm Head Diameter**



- Fine thread
- Box quantities as shown below
- Sold by the box



#2 Square Drive

Length	Drive Type	Finish	Box Qty	Item #	Box Qty	Item #
7.5mm - 7.8mm head for Grass® brand drawer slides						
13mm	Square	Nickel	1,000	QS010590	10,000	QS010589
7.0mm - 7.3mm head for all other european slides						
13mm	Pozi	Nickel	1,000	QS006020	10,000	QS000227
18mm	Pozi	Nickel	-	-	5,000	QS011737
25mm	Pozi	Nickel	-	-	5,000	QS006021

CONFIRMAT & CONNECTING SCREWS

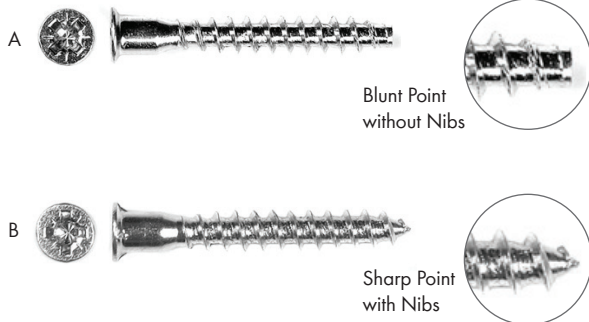

Confirmat Screws, Pozidrive

- Designed for use in case assembly
- Pilot hole diameter 5.4mm, shank dia. 7mm, and Pozidrive head dia.10mm
- 5mm use #2 Pozidrive bits; 7mm use #3 Pozidrive bits
- Box quantities as shown below
- Sold by the box



	Size	Finish	Thread	Box Qty	Item #	Quick Code	Bulk Qty	Item #	Quick Code
Blunt Point Without Nibs									
A	7 x 50mm	Zinc	Coarse	100	WUDS7X50FSZZH	L70100	1000	WUDS7X50FSZZT	L70200
	7 x 50mm	Zinc	Coarse	-	-	-	2000	QS000225	-
	7 x 50mm	Zinc	Fine	-	-	-	2000	QS05502F	-
Blunt Point With Nibs									
	7 x 50mm w/ Covercap Hole	Zinc	Coarse	-	-	-	2000	QS05361C	-
Sharp Point With Nibs									
B	5 x 50mm w/ Covercap Hole	Zinc	Fine	-	-	-	4000	QS013720	-
	7 x 50mm	Zinc	Coarse	-	-	-	1000	WUDS7X50FSZZNT	L70400
	7 x 50mm	Zinc	Coarse	-	-	-	2000	QS05502C	-
Sharp Point Without Nibs									
-	7 x 50mm	Zinc	Coarse	100	WUDS7X50FSZT	L70405	1000	WUDS7X50FSZH	L70310

ASSOCIATED ITEM: **Item #:** QS012793 **5-7-10MM Confirmat Step Drill Bit High Speed Steel**

- Used to Drill Holes to Use Confirmat Screws for European Cabinet Construction Method.



Connecting Screws, 5mm Bore

- Ribbed to prevent rotation while tightening
- Male and female components sold separately
- Combi slot head, for 19 mm Panels



Item #	Component	Size
WDT1215	Male	M4 x 15mm
WDT1222	Female	5 x 35mm M4



FOR BITS & BIT HOLDERS
See pages P-36 to P-38

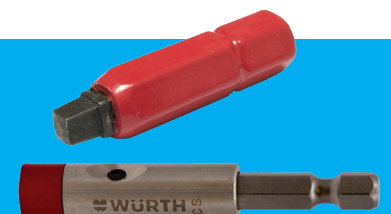

A BITS & ACCESSORIES

B
C
D
E
F
G
H
I
J
K
L
M
N
O
P
Q
R
S
T
U
V
W
X
Y



- Assorted sizes Phillips, Square and Pozi bits

Drive & Insert Bits



Item #	Brand	Magnetic	Screw Size	Overall Length	Sold In
Phillips Drive Bits					
WR0614176274	Würth	No	#1	1"	1 each
WR0614176461	Würth	No	#2	1"	1 each
WU92210	Würth	No	#2	1"	1 each
WU92220	Würth	No	#2	2"	1 each
WU92230	Würth	No	#2	2-3/4"	1 each
QS12692P	Quickscrews	Yes	#2	3-1/2"	1 pack of 10
QS12694P	Quickscrews	Yes	#2	6"	1 pack of 10
WR0614176648	Würth	No	#3	1"	1 each
Phillips Drive Bits - Reduced Shank					
QS11759P	Quickscrews	No	#2	1"	1 pack of 10
QS11759B	Quickscrews	No	#2	1"	1 Pack of 100
Pozi Drive Bits					
WR0614176652	Würth	No	#2	1"	10 each
WR0614176653	Würth	No	#3	1"	1 each
Square Drive Bits					
LCTBS2X1RS	Würth	No	#2	1"	1 each
QS12695P	Quickscrews	Yes	#2	1-15/16"	1 pack of 10
WU90220	Würth	No	#2	2"	1 each
FCPHSQUARE2-5S	FastCap	No	#2	2"	1 pack of 5
QS12696P	Quickscrews	Yes	#2	2-3/4"	1 pack of 10
LCTBS2X3RS	Würth	No	#2	3"	1 each
QS12697P	Quickscrews	Yes	#2	3-1/2"	1 pack of 10
WU90240	Würth	No	#2	4"	1 each
LCTBS2X6RS	Würth	No	#2	6"	1 each
KRD6X2	Kreg	No	#2	6"	1 set of 2
FCPH6SQDRIVE	FastCap	No	#2	6"	1 each
QS12698P	Quickscrews	Yes	#2	6"	1 pack of 10
Torx Drive Bits					
FCPHTORXT20-2IN	FastCap	No	T20	2"	1 pack of 5
FCPHTORXT20-6IN	FastCap	No	T20	6"	1 each

Painted Square Drive Bits

- Makes it easy to identify the right bit (tip of bit is not painted)
- Sold by the each



Item #	Color	Fits Screw Size	Overall Length
WU91210	Red	#2	1"
WU91220	Red	#2	2"
WU91230	Red	#2	3"
WU91260	Red	#2	6"



BITS & ACCESSORIES

A
B
C
D
E
F
G
H
I
J
K
L
M
N
O
P
Q
R
S
T
U
V
W
X
Y



AW® ASSY DRIVE Bits

- For use with ASSY drive screws
- Sold by the each



Item #	Fits Screw Size	Overall Length
WRAW10	#10 Purple	1"
WRAW20	#20 Orange	1"
WRAW20-4	#20 Orange	4"
WRAW20-6	#20 Orange	6"
WRAW25	#25 Green	1"

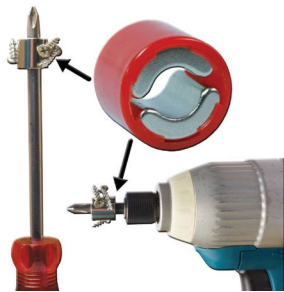

Bit Magnet

- Slide over the base of a 1" insert bit, 6" extended bit, or anything in between and the magnetic transfer picks up multiple screws with ease
- Sold by the each



Item #
FCTIPMAG



Insert Bit Holder, Magnetic

- High energy magnet helps alleviate the problem of lost bits
- Sold by the each



Item #	Overall Length	Brand
BO40831	2-1/8"	Bosch
WR0614176702	3"	Wurth

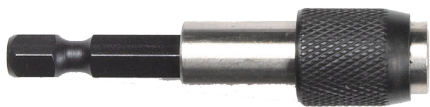

Insert Bit Holder with Quick Change Chuck

- A slight forward motion of the locking sleeve unlocks the bit for a quick change
- Sold by the each



Item #	Overall Length	Brand
Non-Magnetic		
WR0614176711	2"	Wurth

Item #	Overall Length	Brand
Magnetic		
WU99010	2-1/4"	Wurth
WR614176708	3"	Wurth



Insert Bit Holder, Magnetic, One Touch Release

- Soft push on the button, the bit will shoot forward due to the internal spring for easy removal
- Stainless steel housing
- Sold by the each



Item #
WR0614176638

A BITS & ACCESSORIES/TITE-JOINTS

B
C
D
E
F
G
H
I
J
K
L
M
N
O
P
Q
R
S
T
U
V
W
X
Y

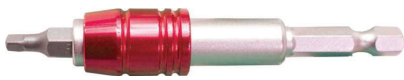

Bit not included

TaperLock® Bit Holder



- Unique patented design uses a tapered spindle to firmly hold any bit in place
- The harder you pull, the tighter it gets
- Also features a one-touch auto-lock for easy release of the bit with one hand

Item #
FCTAPERLOCK



Right Angle Drill Attachment, Magnetic, 1/4" Bit Mount with Quick Change Chuck



- Suitable for use with electric drills and battery operated driver drills
- Specially hardened steel enables maximum torque, with a maximum speed of 2,000 RPM's
- Secure hold and 360° step-free adjustable handle
- Compact design is perfectly suited for screwing in cramped and hard-to-reach places

Item #
WR06149000



Universal Bit Set, 90 Piece, Magnetic



- Includes standard drive styles and safety screws, 1/4" drive magnetic ratchet adapter and sturdy metal box
- Comes in foam insert to keep the bits nicely organized

Item #
WR0614250500



Flipbolt, Tool-less Draw Bolt



- 4-1/2" long
- Place Flipbolt in cutout (template available), hand tighten nut, Flipbolt tightens when lever is pushed
- Jig works with both sizes of Flipbolt

Item #	Description
FCFLIPBOLT-SHORT	FlipBolt, 3-1/2"
FCFLIPBOLT	FlipBolt, 4-1/2"
FCFLIPBOLTJIG	Flip Bolt Template

TITE-JOINTS

A
B
C
D
E
F
G
H
I
J
K
L
M
N
O
P
Q
R
S
T
U
V
W
X
Y

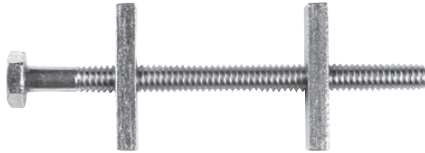

Economy Tite-Joint (Dog Bone) Fasteners

- Hex head
- Ideal for field joints in countertops
- Steel, bright zinc plated
- Box quantities as shown below
- Sold by the box



Item #	Brand	Bolt Size	Box Qty
WUMSDBH	Würth	3-1/2"	100
WUMSDBB	Würth	3-1/2"	500
QS005368	QuickScrews	4"	350
KV513ZC	KV	4"	100



Deluxe Tite-Joint (Dog Bone) Fasteners

- Designed for 3/4" thick substrate
- Center to center 2" to 3-1/2"



Item #	Description	Box Qty	Sold in Multiples of
KV516/25	Complete Tite Joint	25	1 each
KV516/100	Complete Tite Joint	100	100 each



Zipbolt™ Tite-Joint Fastener

- Integrated gearing system
- Tighten using a 4mm hex drive bit in a drill, hand driver, or Allen key
- Can be tightened in just 3 seconds using the driver bit in a drill
- Each box contains a 4mm hex drive bit
- Box quantities as shown below
- Sold by the box



Item #	Description	Box Qty
WUZIPBOLT	Zipbolt Fastener	60
WUZIP4MMBIT	4mm Hex Drive Bit	1

A COVERCAPS

B
C
D
E
F
G
H
I
J
K
L
M
N
O
P
Q
R
S
T
U
V
W
X
Y



Peel & Stick Plastic Covercaps, PVC



- PSA adhesive backed cover caps, adhesive strength increases as it cures
- Sold by the box

Item #	Description
FCAP91641PVC	PVC and Metallic Sampler Box

* White also available in bulk box of 26,500 caps -

Item #: FCSP916BULKWH

Style	Dia.	Color/Species	Mini Box Qty	Item #	Standard Box Qty	Item #
Solid Color	9/16"	Almond	265	FCMB916AL	1,060	FCSP916AL
Solid Color	11/16"	Almond	-	-	720	FCSP18MMAL
Solid Color	9/16"	Antique White	265	FCMB916AW	1,060	FCSP916AW
Solid Color	9/16"	Black	265	FCMB916BL	1,060	FCSP916BL
Solid Color	11/16"	Black	-	-	720	FCSP18MMBL
Solid Color	9/16"	Fog Gray	265	FCMB916DG	1,060	FCSP916DG
Solid Color	11/16"	Fog Gray	-	-	720	FCSP18MMDG
Solid Color	9/16"	Folkstone	265	FCMB916LG	1,060	FCSP916LG
Solid Color	11/16"	Folkstone	-	-	720	FCSP18MMLG
Solid Color	3/8"	White	-	-	1,800	FCSP3/8WH
Solid Color	9/16"*	White	265	FCMB916WH	1,060	FCSP916WH
Solid Color	11/16"	White	180	FCMB18MMWH	720	FCSP18MMWH
Solid Color	1"	White	100	FCMB1WH	400	FCSP1WH
Solid Color	1-5/8"	White	30	FCMB15/8WH	-	-
Woodgrain	9/16"	American Maple	265	FCMB916AM	1,060	FCWP916AM
Woodgrain	9/16"	Autumn Cherry	265	FCMB916AC	-	-
Woodgrain	9/16"	Beech	265	FCMB916BE	-	-
Woodgrain	9/16"	Clear Maple	265	FCMB916CM	-	-
Woodgrain	9/16"	Dark Cherry	265	FCMB916DC	-	-
Woodgrain	9/16"	Dark Mahogany	265	FCMB916DM	-	-
Woodgrain	9/16"	Golden Cherry	265	FCMB916GC	-	-
Woodgrain	9/16"	Golden Oak	265	FCMB916GO	-	-
Woodgrain	9/16"	Hardrock Maple	265	FCMB916HM	1,060	FCWP916HM
Woodgrain	11/16"	Hardrock Maple	-	-	720	FCWP18MMHM
Woodgrain	9/16"	Imperial Walnut	265	FCMB916IW	-	-
Woodgrain	9/16"	Knotty Pine	265	FCMB916KP	-	-
Woodgrain	9/16"	Light Maple	265	FCMB916LM	1,060	FCWP916LM
Woodgrain	9/16"	Light Oak	265	FCMB916LO	-	-
Woodgrain	9/16"	Mahogany on Walnut	265	FCMB916MW	-	-
Woodgrain	9/16"	Manitoba Maple	265	FCMB916MM	-	-
Woodgrain	9/16"	Medium Cherry	265	FCMB916MC	-	-
Woodgrain	9/16"	Natural Cherry	265	FCMB916NC	1,060	FCWP916NC
Woodgrain	9/16"	Presidential Walnut	265	FCMB916PW	1,060	FCWP916PW
Woodgrain	9/16"	Red Mahogany	-	-	1,060	FCWP916RM
Woodgrain	9/16"	Renaissance Oak	265	FCMB916RN	-	-
Woodgrain	9/16"	Select Cherry	265	FCMB916SC	-	-

COVERCAPS

A
B
C
D
E
F
G
H
I
J
K
L
M
N
O
P
Q
R
S
T
U
V
W
X
Y

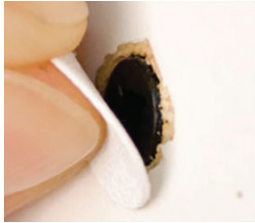

Peel & Stick Covercaps, Real Wood



- PSA adhesive on back of each cover cap, increases in strength as it cures
- Unfinished wood caps can be sanded, stained and finished
- Prefinished real wood cover caps are finished with clear, non-yellowing laquer
- Sold by the box

Sampler Boxes	
FCAW916RW	Real Wood, Unfinished
FCPW916AW	Real Wood, Prefinished

NOTE: Image is PVC, Caps listed below are real wood.

Style	Diameter	Species	Mini Box Qty	Item #	Standard Box Qty	Item #
Prefinished Wood	9/16"	Ash	-	-	1,040	FCPW916AS
Prefinished Wood	9/16"	Birch	260	FCMB916PWB	1,040	FCPW916WB
Prefinished Wood	9/16"	Maple	260	FCMB916PMP	1,040	FCPW916MP
Prefinished Wood	9/16"	Walnut	260	FCMB916PWA	1,040	FCPW916WA
Prefinished Wood	9/16"	White Oak	260	FCMB916PWO	1,040	FCPW916WO
Unfinished Wood	9/16"	Red Oak	260	FCMB916PRO	-	-
Unfinished Wood	9/16"	Alder	260	FCMB916AD	1,040	FCSW916AD
Unfinished Wood	9/16"	Cherry	260	FCMB916CH	1,040	FCSW916CH
Unfinished Wood	9/16"	Hickory	260	FCMB916HC	-	-
Unfinished Wood	9/16"	Mahogany	260	FCMB916MG	-	-
Unfinished Wood	9/16"	Maple	260	FCMB916MP	1,040	FCSW916MP
Unfinished Wood	9/16"	Natural Birch	260	FCMB916NB	1,040	FCSW916NB
Unfinished Wood	9/16"	Red Oak	260	FCMB916RO	1,040	FCSW916RO
Unfinished Wood	9/16"	VG Fir	260	FCMB916VF	-	-
Unfinished Wood	9/16"	Walnut	260	FCMB916WA	1,040	FCSW916WA
Unfinished Wood	9/16"	White Birch	260	FCMB916WB	1,040	FCSW916WB
Unfinished Wood	9/16"	White Oak	260	FCMB916WO	1,040	FCSW916WO

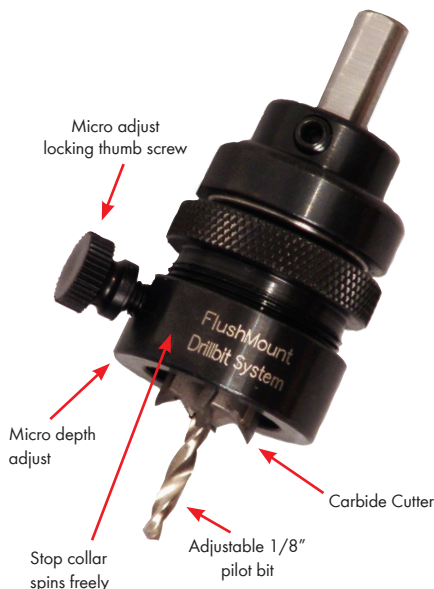

Micro Flushmount Drill Bit System, For Fastcap Covercaps



- Unique ball bearing stop collar that controls the recess depth the drill creates and allows the stop collar to stop spinning when it comes in contact with the surface you are drilling
- Both pilot bit (1/8") and countersink bit (9/16") are adjustable
- 9/16" countersink allows you to perfectly flush screws and covercaps
- Micro adjust locking thumb screw

Item #	Description
FCDBC916MICRO	Flushmount Bit, 9/16"
FCDB916-DRILL	Replacement Inner Bit
FCDB38	Carbide Cutter, 3/8"
FCDB916	Carbide Cutter, 9/16"
FCDB18MM	Carbide Cutter, 18mm

A COVERCAPS

B
C
D
E
F
G
H
I
J
K
L
M
N
O
P
Q
R
S
T
U
V
W
X
Y



FCPUNCHSET

Custom Color Covercaps Tool



- Punch your own custom color Fastcap cover caps
- For use punching .018 to .022 thick edgbanding and veneer
- Not recommended to use punching plastic laminate
- Ratcheting cutter and built in ejector pin

Item #	Includes
FC916PUNCH	Hard shell case; 1" x 50' SpeedTape; 3/8", 9/16" and 18mm die, Hole Punch Tool, PowerHead Screws
FCPUNCHSET	All of the above, plus FlushMount Drill Bit System
FCPUNCHPRO	All of the above, plus 3/8" and 18mm Carbide Cutters



Plastic Screw Covercaps



- Knock in cover caps for #6 & #8 phillips drive screws
- Sold by the 1,000

Item #	Color
TI1020-AL	Almond
TI1020-BK	Black
TI1020-DB	Dark Brown
TI1020-GR	Grey
TI1020-LB	Light Brown
TI1020-MH	Mahogany
TI1020-WH	White



Finishing Washer



- Provides a clean, finished look for flat head screws
- Box quantities as shown below
- Sold by the box

Fits Screw Size	Finish	Material	Box 100 Item #	Quick Code	Box 1,000 Item #	Quick Code
#6	Nickel	Steel	-	-	WUMS6-WASHER-NLK	L49025
#8	Black	Steel	-	-	WUMS8-WASHER-BLK	L49175
#8	Nickel	Steel	WUMS8-WASHERNH	L49100	WUMS8-WASHERNT	L49125
#10	Nickel	Steel	WUMS10-WASHERNH	L49300	WUMS10-WASHER-NKL	L49400

POCKET-HOLE PLUGS/SPECIALTY COVERCAPS



Pocket-Hole Plugs

- Use when pocket-holes won't be hidden on the backside of a project or for decorative use
- 50 plugs per pack
- Sold by the pack



Item #	Material	Color/Species
KRCAP-WHT-50	Plastic	White
KRP-MA	Solid Wood	Maple
KRP-OAK-50	Solid Wood	Oak
KRP-PIN-50	Solid Wood	Pine
KRP-PNT-50	Solid Wood	Paint Grade

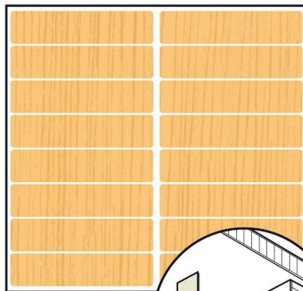

Covercaps For Pocket Cutter Holes Self-Adhesive PVC



- Designed for covering holes bored by pocket hole cutters
- Overall size: 2-1/2" L x 9/16" W
- Sold by the box (16 caps per sheet, 20 sheets per box)

Material	Color	Item #	Color	Item #
PVC	Almond	FCSPCCAL	Fog Gray	FCSPCCDG
PVC	Antique White	FCSPCCAW	Folkstone	FCSPCCLG
PVC	Black	FCSPCCBL	White	FCSPCCWH

NOTE:
Representation only;
caps will be as noted
on table

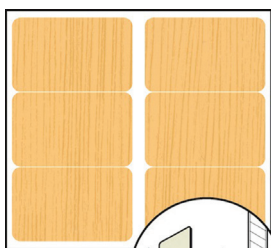
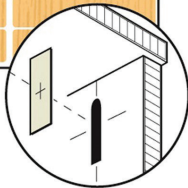

Covercaps For 35mm Hinges, Self-Adhesive PVC



- Designed to cover unused or misplaced holes bored in doors for European hinges
- Covercap measures 1-9/16" Wide by 2-1/2" Long
- Material is .020" thick PVC, White finish
- Sold by the box

Item #	Material	Color	Caps per Sheet	Sheets per Box
FCMBH25WH	PVC	White	6	5
FCSPH25WH	PVC	White	6	20

NOTE:
Representation only;
caps will be White

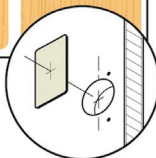

Hinge Hole Repair Kits

- Designed to quickly repair missed drill holes for cabinet door hinges
- Standard packet contains (2) 35mm and (4) 8mm plugs, a glue swab, and instructions
- High quality solid hardwood
- For 2 hinge door repair
- True face grain
- Tapered for easy installation



Item #	Color
KO358A	Alder
KO358C	Cherry
KO358M	Maple
KO358O	Red Oak

A SPECIALTY COVERCAPS

B
C
D
E
F
G
H
I
J
K
L
M
N
O
P
Q
R
S
T
U
V
W
X
Y

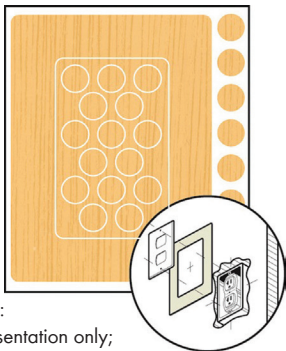

NOTE:
Representation only;
caps will be White

Electrical Box Trim, Self-Adhesive PVC



- Overall size: 4-1/8"W x 5-9/16"H
- Designed to trim the cutout for a standard size (2-1/4" wide x 3-3/4" high) plastic electrical box
- Sheets contains (1) electrical box trim ring and (23) 9/16" diameter white Fastcap cover caps
- Sold by the box

Item #	Material	Color	Sheets per Box
FCMBE1DG	PVC	Fog Gray	5
FCMBE1WH	PVC	White	5
FCSPE1WH	PVC	White	20

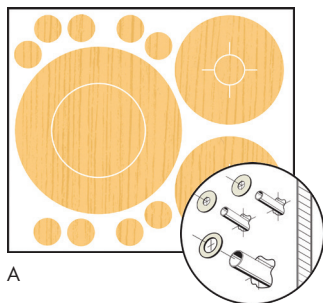

A

Plumbing Covercaps. PVC



- PSA adhesive backed cover caps, adhesive strength increases as it cures
- Sold by the box

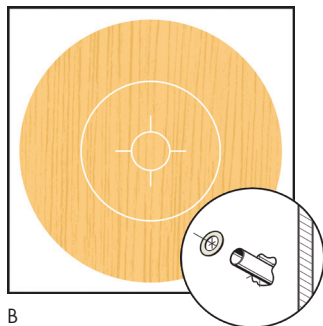

B

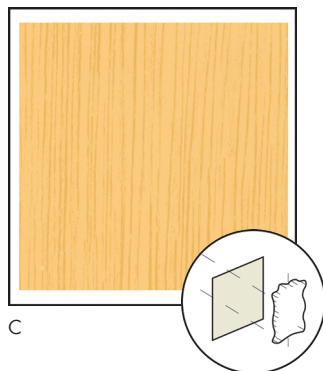

C

	Each Sheet Contains	Color	MiniBox Item #	Sheets per Box	Standard Pack Item #	Sheets per Box
A	(2) 1/2" Supply Line Covercaps (1) 1-1/2" Waste Line Covercap	Almond	-	-	FCSP1AL	20
		Antique White	-	-	FCSP1AW	20
		White	-	-	FCSP1WH	20
B	(1) 1/2" Supply Line Covercap (1) 2-7/16" Waste Line Covercap	HardRock Maple	FCMBP3HM	5	-	-
		White	FCMBP3WH	5	FCSP3WH	20
		HardRock Maple	-	-	FCWPP4HM	20
C	(1) 5" x 5" Covercap	White	-	-	FCSP4WH	20
		HardRock Maple	FCMBP5HM	5	FCWPP5HM	20
		White	FCMBP5WH	5	FCSP5WH	20

MIRROR/BACKSPLASH CLIPS

A
B
C
D
E
F
G
H
I
J
K
L
M
N
O
P
Q
R
S
T
U
V
W
X
Y

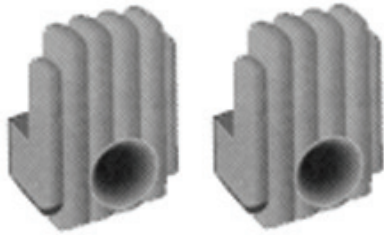

Plastic Mirror Clips, Clear

- Use to attach mirrors to walls or cabinets
- Clear for use against any color
- Screws included
- Sold in full boxes only



Item #	For Material Thickness	Box Qty
KV6094-PLAS	1/8"	100
KV6092-PLAS	1/4"	150



Smart Clip® Backsplash Fasteners



Installing the Smart Clip®:

1. Rout the laminated backsplash.
 2. After measuring and drilling 12" intervals on backsplash, install screws (included) into the bottom of the backsplash.
 3. Install the Smart Clip® on the countertop, butting the wall, using the screws provided.
 4. Run a bead of caulk along the line of Smart Clips®, and drive the backsplash into position.
- Easy to use, install in minutes, are waterproof, and allow formfitting the backsplash of a countertop to nearly any wall surface
 - Eliminates scribing, mastics, metals, and front caulking
 - Sold by the each, available any quantity

Item #	Description	Box Qty
DKCLIP	Smart Clip®	250
Accessories		
DKRB	Router Bit	1
DKSDG	Depth Gauge	1
DKSB	Spacing Bar	1



Keyhole Plates

- Used for assembling chairs, beds, cabinets, etc
- Countersunk hole for #6 flat head screws; Rigid connection with #10 round head screws (no screws included)
- .095 gauge cold rolled steel, zinc plated



Item #	Size
SY67S	1-5/8"L x 9/16"W

A MISCELLANEOUS FASTENERS

B
C
D
E
F
G
H
I
J
K
L
M
N
O
P
Q
R
S
T
U
V
W
X
Y

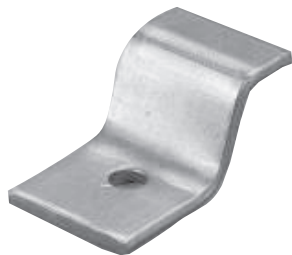

Top Fasteners, Steel

- Ideal for connecting tops made of solid wood where expansion and contraction may be a problem
- The "leg" of the clip "floats" in a saw kerf allowing the top to breathe and not crack
- Uses #5 Flathead screws (not included)



Item #	Gauge Steel
KV323	14



Desk Top Fasteners

- Ideal for mounting tops to legs or table bases
- Screws not included



Item #	Gauge Steel	Length	Width	Finish
KV1547-STL	12	1-1/4"	3/4"	Steel
KV1548-ZC	18	1-1/4"	3/4"	Zinc



Mending Plates

- Zinc plated rust resistant steel
- Countersunk screw holes
- Screws not included
- Sold by the each



Item #	Size	Gauge	Recommended Screw Size	# Screw Holes
FE225-3	3" L x 3/4" W	14	#8	4
FE225-4	4" L x 3/4" W	14	#8	4



Plastic Vertical Divider Clip

- Holds vertical dividers in place
- Not for horizontal shelf applications
- Bore hole: 5mm diameter
- Sold in unit of measure as noted below



Item #	Description	Finish	Unit of Measure	Qty Per Bag
BA1941-CLP	Vertical Divider Clip	Clear	Bag	50

BRACES



Corner Chair Braces

- Uses 3/4" x #10 flathead wood screws
- Stamped steel, zinc plated finish
- Screws not included (3/4" x 10 flathead)
- Sold by the each



Item#	Size	Box Qty
KV341ZC	1" L x 1" W	100
KV342-ZC	2" L x 2" W	100



Corner Braces

- Zinc plated rust resistant steel
- Sold by the each
- Screws not included



Item #	Size	Gauge	Recommended Screw Size	# Screw Holes
FE226-1	1" x 1"	15	#8	2
FE226-1.5	1.5" x 1.5"	15	#8	4
FE226-2	2" x 2"	14	#8	4
FE226-3	3" x 3"	12	#8	4
FE226-4	4" x 4"	11	#8	4

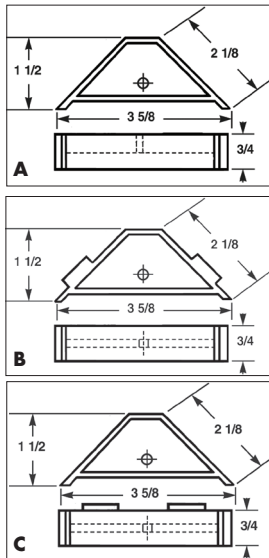

Corner Braces, Plastic Glue Boxes

- Made of high impact, specially compounded plastic material
- Can be stapled through without shattering and will also accept glue
- Off-center screwholes for easier screwgun access into corner of the cabinet
- Braces are 3-5/8" L and 3/4" D



- **A. Has no tabs; B. Has tabs extending out; C. Has tabs projecting up**
- Screws not included
- Sold by the each

Item #	Color	Box Qty
A HGH441E1400	Translucent	1,400
B HGH443E1300	Translucent	1,300
C HGH445E1200	Translucent	1,200



Corner Braces

- Made of plastic
- Sold in boxes of 1,000 pieces



Item #	Description	Size	Finish	Box Qty
BA1680-62	Corner Brace	1-1/4" x 1-1/4" x 3/4"	White	1,000
BA1685CL-62	Corner Brace	1-1/8" x 1-1/8" x 1-1/8"	Clear	1,000
BA1693-62WH	Corner Brace	2-1/2" x 2-1/2" x 3/4"	White	1,000

A
B
C
D
E
F
G
H
I
J
K
L
M
N
O
P
Q
R
S
T
U
V
W
X
Y

A INTERLOCKING PANEL ASSEMBLY HARDWARE

B
C
D
E
F
G
H
I
J
K
L
M
N
O
P
Q
R
S
T
U
V
W
X
Y



“Keku” Push-In Fittings

- Designed for fastening panels to frames
- Components to be mounted are pushed on from the front eliminating the need for free space at the top or side as required by suspension fittings
- Panel element locks into the frame element as it is pushed home
- Fits 32mm system

NOTE: Order male and female separately. Sold by the each.

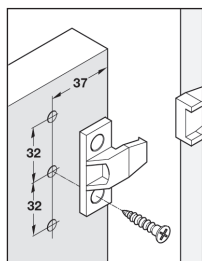

Item #	Type
HA262.50.368	Male
HA262.50.359	Female

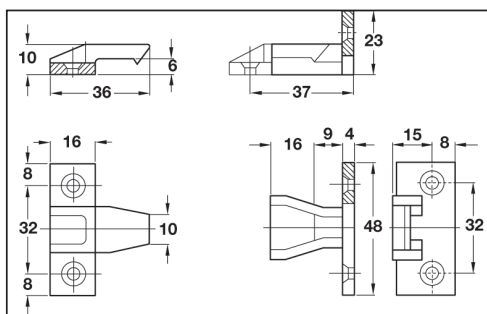

“Keku” Suspension Fittings

- Pre-assembly of sub-frames and cabinet components such as speaker fronts, wainscoting, radiator covers or wherever access is needed after installation
- System consists of a frame and panel element, both made out of a nylon
- If required, suspended panels can be simply released at anytime without special tools
- Fits 32mm systems

NOTE: Order male and female separately. Sold by the each.

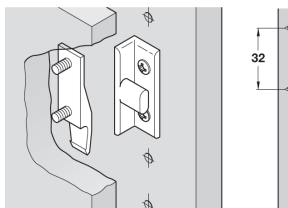

Item #	Type
HA262.49.356	Male
HA262.49.365	Female

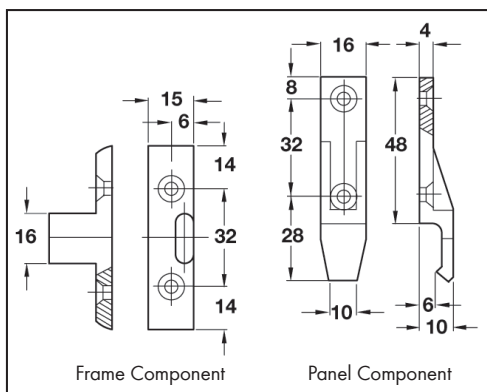

POST HANGERS/RETAINING CLIPS



Surface Mounted Post Hangers



- For board widths 4" to 7"; for larger widths, 2 units on each corner may be used for increased rigidity
- Surface mounted brackets require no mortising or machining
- Takes #6 flathead screws (not included)
- Sold by the set of 4 males and 4 females

Item #	Length
HA271.05.906	3-7/8"

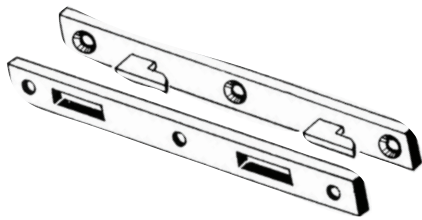

Post Hangers



- For beds, booths, removable partitions, shelf brackets, etc.
- Screws not included (recommended 3/4" x 8 flathead)
- Sold by the set of 4 males and 4 females

Item #	Length	Width
SY74-4	4"	11/16"
SY74-5	5"	11/16"
SY74-6	6"	11/16"

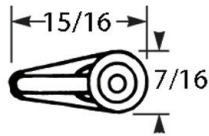

Glass & Panel Plastic Retaining Clips



- Holds panels in place and prevents rattling by maintaining a soft pressure against the panel or glass
- Uses #5 flat head or oval head screw
- Sold by the each

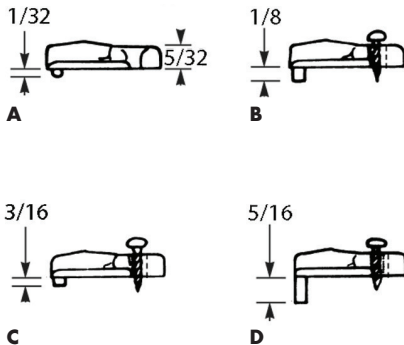

	Clear Item #	Tan Item #	Walnut Item #	Application Type
A	HGH242CL1000	HGH242T1000	-	Flush
B	HGH261CL1000	-	HGH261WAL1000	1/8" Inset
C	HGH262CL1000	-	-	3/16" Inset
D	HGH264CL1000	-	-	5/16" Inset



Plastic Screen Clip



- Flush mount
- Sold in unit of measure as noted below

Item #	Description	Finish	Unit of Measure
BA1803-CL	Screen Clip	Clear	Hundred

A
B
C
D
E
F
G
H
I
J
K
L
M
N
O
P
Q
R
S
T
U
V
W
X
Y

A Z-CLIPS / PANEL HANGING SYSTEM

B
C
D
E
F
G
H
I
J
K
L
M
N
O
P
Q
R
S
T
U
V
W
X
Y



Z-Clips, 5403 Series

- Made of aluminum
- 2 interlocking aluminum clips; one attaches to the wall (Long Wall Clip) and the other (Short Hang Clip) attaches to a panel or cabinet
- Sold per each



Item #	Description	"A" Size	"B" Size	Overall Size	Holes Per Clip
PR5403-AM	Short Hang Clip	0.375"	0.25"	1.375" x 2"	2
PR5403-72AM	Long Wall Clip	0.375"	0.25"	1.375" x 72"	-



Z-Clips, 5337 Series

- Made of aluminum
- 2 interlocking aluminum clips; one attaches to the wall (Long Wall Clip) and the other (Short Hang Clip) attaches to a panel or cabinet
- Sold per each



Item #	Description	"A" Size	"B" Size	Overall Size	Holes Per Clip
PR5337-AM	Short Hang Clip	0.625"	0.175"	1.875" x 2"	2
PR5337-72AM	Long Wall Clip	0.625"	0.175"	1.875" x 72"	-

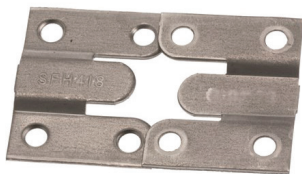

Interlocking Panel Assembly Hardware Flushmount Hangers



- For wall-panels, wall-hung cabinets, mirrors, bed headboards, and displays
- Two interchangeable interlocking pieces mate perfectly to provide secure fastening in only 1/8" assembled thickness
- Made of .062" gauge steel, zinc plated
- Four screwholes are countersunk for #6 flat head screws (not included)
- Available any quantity of sets

Item #	Size	Box Qty
SYK418Z	1-1/2"W x 1-3/4"H	500 sets

WALL PANEL BRACKET / ANCHORS

A
B
C
D
E
F
G
H
I
J
K
L
M
N
O
P
Q
R
S
T
U
V
W
X
Y



**Fastmount Panel Mounting System
Very Low Profile Clip Set**



- Perfect for mounting removable, thin wall panels and facings
- No special installation tools are required, designed to be installed by screw or adhesive
- Set includes: (1) female clip, (1) male clip & (1) stainless steel screw
- Sold per set

Item #	Dimensions	Pull Out Force
SGVL-03	1.102"Dia. X 0.299"H	11 lbs.



Wall Panel Bracket



- Hanging wall panels just got a whole lot easier and completely invisible!
- All you need to do is cut a 2" x 2" hole in the sheetrock over a stud, install this Wall Panel bracket, route into the back of your panel, and hang it

Item #	Weight Capacity
SHBWP-3	75 lb

NOTE: Mfr recommends using construction adhesive between panel and sheetrock for added stability.

**For dimensional line drawing,
see our website.**



Zinc

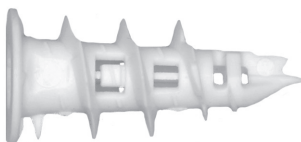

Nylon

Drywall Anchor, Multi-Drive



- Install into 3/8" to 1" wallboard
- Patented drive can be installed with Pozi, AW or Torx bits
- Minimal space requirement behind sheet (only 15mm)
- Use with sheet metal or drywall screws - screws are removable (not included)
- Sold in full boxes of 200 only

Item #	Material	Length x Gauge
WR0903252	Zinc	1-3/8" x 6
WR0903251	Nylon	1-3/8" x 6

A DOWEL RODS

B
C
D
E
F
G
H
I
J
K
L
M
N
O
P
Q
R
S
T
U
V
W
X
Y



Dowel Rods

- Dowel rods sold by the each





Diameter	36" Length Item #	UM	48" Length Item #	UM
1/4"	EXDR-14X36	EA	EXDR-14X48	EA
1/2"	EXDR-12X36	EA	EXDR-12X48	EA
3/8"	EXDR-38X36	EA	EXDR-38X48	EA
5/8"	EXDR-58X36	EA	EXDR-58X48	EA
3/4"	-	-	EXDR-34X48	EA
1"	EXDR-100X36	EA	EXDR-100X48	EA



Dowel Pins

- Dowel pins sold by the HU (100) or BX (box) as noted below



	Size	Item #	UM	Box Qty	Item #	UM	Box Qty
MULTI GROOVE, METRIC 	5mm x 25mm	EXDPMG-05X25-B	HU	-	-	-	-
	8mm x 30mm	EXDPMG-08X30-M	BX	1,000	EXDPMG-08X30-B	BX	19,200
	8mm x 32mm	EXDPMG-08X32-M	BX	1,000	EXDPMG-08X32-B	BX	17,800
	8mm x 35mm	EXDPMG-08X35-M	BX	1,000	EXDPMG-08X35-B	BX	16,400
	8mm x 38mm	EXDPMG-08X38-M	BX	1,000	EXDPMG-08X38-B	HU	-
	8mm x 50mm	-	-	-	EXDPMG-08X50-B	BX	12,000
	10mm x 50mm	-	-	-	EXDPMG-10X50-B	BX	13,000
MULTI GROOVE, STANDARD 	1/4" x 1-1/2"	EXDPMG-14X112-B	HU	-	-	-	-
	3/8" x 1-1/2"	EXDPMG-38X112-H	BX	100	EXDPMG-38X112-B	BX	13,000
	3/8" x 1-3/4"	EXDPMG-38X134-B	HU	-	-	-	-
	3/8" x 2"	EXDPMG-38X200-H	BX	100	EXDPMG-38X200-B	BX	13,000
	3/8" x 2-1/2"	EXDPMG-38X212-H	BX	100	-	-	-
	1/2" x 2-1/2"	EXDPMG-12X212-B	HU	-	-	-	-
	1/2" x 3-1/2"	EXDPMG-12X312-B	HU	-	-	-	-
	1/2" x 4"	EXDPMG-12X400-H	BX	100	EXDPMG-12X400-B	BX	3,400
MULTI GROOVE, PREGLUED, METRIC & STANDARD 	6mm x 25mm	EXDPMGP-06X25-B	HU	-	-	-	-
	8mm x 30mm	-	-	-	EXDPMGP08X30-B	BX	20,000
	8mm x 32mm	-	-	-	EXDPMGP08X32-B	BX	20,000
	8mm x 35mm	-	-	-	EXDPMGP08X35-B	BX	20,000
	5/16" X 30mm	-	-	-	EXDPMGP-516X30-B	BX	20,000
SPIRAL DOWEL PINS, STANDARD 	3/8" x 1-1/2"	EXDPS-38X112-B	HU	-	-	-	-
	3/8" x 1-3/4"	EXDPS-38X134-B	HU	-	-	-	-
	3/8" x 2"	EXDPS-38X200-B	HU	-	-	-	-
	7/16" x 2"	EXDPS-716X200-B	HU	-	-	-	-
	1/2" x 2"	EXDPS-12X200-B	HU	-	-	-	-

BISCUITS

A
B
C
D
E
F
G
H
I
J
K
L
M
N
O
P
Q
R
S
T
U
V
W
X
Y



Standard Compressed Beech Wood Biscuits

- Flat ends so surplus glue remains inside the groove
- Sold by the 1,000



PORTER CABLE

Biscuit Size	Lamello Item #	Porter Cable Item #
H9 Face Frame	CS144009	-
#0	CS144000	-
#10	CS144010	PCB5552
#20	CS144020	PCB5553



Plastic Biscuits, C-20 Plastic

- Made of translucent C-20 plastic, environmentally friendly polypropylene
- For joining solid surface materials
- No glue required
- Sold by the box



Item #	Biscuit Size	Dimensions	Box Qty
CS156110	C-20 Plastic	23 mm W x 60mm L	250



Tenso P-14 Connection Fittings

- Self-clamping connector with three functions: alignment, clamping and connecting
- High level of clamping force allows work pieces to be glued without the need for screw clamps or pressure
- Additional option of preloading the connector prior to glue applications enables use for all angles and miters and which reduces the amount of force when connecting the workpieces
- Requires use of Zeta P2 Joiner
- Sold by the box



Item #	Description	Box Qty
CS145425	P-14 Tenso Fittings	300 Sets



Clamex P-14 Detachable Fittings

- Detachable connector with very small opening
- Extremely fast insertion of the connectors without tools
- Versatility for all angles and joining situations
- Sold by the box



Item #	Key Opening Size	Box Qty
CS145346	6mm	300 Sets
CS145356	6mm	1,000 Sets

A TITUS SYSTEM FITTINGS

B

C

D

E

F

G

H

I

J

K

L

M

N

O

P

Q

R

S

T

U

V

W

X

Y



System 6 Quickfit Dowels

- Suitable for use with all Titus 20mm dia. and 25mm dia. System 6 housings
- Standard screw-in dowel for KD (knock-down) fittings
- Threaded for 5mm system holes
- Dowels feature an integral skirt which acts as a positive stop during insertion
- Sold in unit of measure as noted below

Titus

Item #	Drilling Length for Dowel Thread	Diameter	Unit of Measure
T106401ZN	9mm	5mm	Each
T106402ZN	8mm	5mm	Each
T106406ZN	11.5mm	5mm	Each



System 6 Quickfit Dowel

- Suitable for use with all Titus 20mm dia. and 25mm dia. System 6 housings
- Can be removed without damage to panel surface
- Plastic expanding sleeve for a secure hold
- Threaded for 5mm system holes
- Depth collar stop for accurate insertion
- Sold in unit of measure as noted below

Titus

Item #	Drilling Length for Dowel Thread	Diameter	Unit of Measure
T106408YA	12.5mm	5mm	Each



System 6 Quickfit Double-Ended Dowel

- Suitable for use with all Titus 20mm dia. and 25mm dia. System 6 housings
- Double dowel slides through center panel to lock in shelves on both sides
- Threaded for 5mm system holes
- Sold in unit of measure as noted below

Titus

Item #	Panel Thickness	Larger End Diameter	Smaller End Diameter	Unit of Measure
T106416ZN	19mm	5.8mm	4.8mm	Each

TITUS SYSTEM FITTINGS

A
B
C
D
E
F
G
H
I
J
K
L
M
N
O
P
Q
R
S
T
U
V
W
X
Y

Titus



System 6 Cams, Knock-In Housing Non-Outrigger Drop-On, 20mm Dia., Plastic

- Drop on cams feature a slight lip on the inside to help secure the top shelf until screw is set
- Ideal for use in high volume production
- Can be machine inserted or knocked in with a hammer
- Minimum drilling requirements; no edge boring required
- Linear cam design for constant tightening loads when driving
- Locking feature provides a strong vibration proof connection
- Compatible with all screw-in and Quickfit System 6 dowels
- Sold in unit of measure as noted below

Item #	For Panel Thickness	Drilling Depth	Color	Unit of Measure
TIO06387BN	18/19mm	14mm	Brown	Each
TIO6387-BK	18/19mm	14mm	Black	Each
TIO6387WA	18/19mm	14mm	White	Each

Titus



System 6 Cam, Knock-In Housing Non-Outrigger Drop-On, 20mm Dia., Zinc

- Drop on cams feature a slight lip on the inside to help secure the top shelf until screw is set
- Ideal for use in high volume production
- Can be machine inserted or knocked in with a hammer
- Minimum drilling requirements; no edge boring required
- Linear cam design for constant tightening loads when driving
- Locking feature provides a strong vibration proof connection
- Compatible with all screw-in and Quickfit System 6 dowels
- Sold in unit of measure as noted below

Item #	For Panel Thickness	Drilling Depth	Finish	Unit of Measure
TIO6449NI	18/19mm	14mm	Nickel Plated	Each

Titus



System 6 Cams, Knock-In Housing W/Outrigger Drop-On, 20mm Dia., Plastic

- Drop on cams feature a slight lip on the inside to help secure the top shelf until screw is set
- Ideal for use in high volume production
- Can be machine inserted or knocked in with a hammer
- Minimum drilling requirements; no edge boring required
- Linear cam design for constant tightening loads when driving
- Compatible with all screw-in and Quickfit System 6 dowels
- Sold in unit of measure as noted below

Item #	For Panel Thickness	Drilling Depth	Color	Unit of Measure
TIO06397-BK	18/19mm	14mm	Black	Each
TIO06397SV	18/19mm	14mm	Silver	Each
TIO06397WH	18/19mm	14mm	White	Each

A TITUS SYSTEM FITTINGS

B

C

D

E

F

G

H

I

J

K

L

M

N

O

P

Q

R

S

T

U

V

W

X

Y

System 1 Fitting For Rigid Assembly System

- Special self-locking, pozi drive connection screw features two different sized threads; one at 8mm diameter at the head of the screw, the other at 5mm diameter on the shaft
- Used to join two 15 or 16mm panels
- Gripping action of two different screw thread pitches working in opposition ensures the two panels remain firmly locked into position
- Sold in unit of measure as noted below

Titus

Item #	Description	Unit of Measure
TI00180ZN	Double locking carcass screw, #6 x 42mm	Thousand

System 5 Quickfit TL Dowel

- Suitable for use with all Cam2000 series cams
- Sold in unit of measure as noted below

Titus

Item #	Drilling Diameter	Drilling Distance	Unit of Measure
TI05441YA	8mm dowel thread	24mm	Hundred

System 5 Quickfit P2F Dowel

- Suitable for use with all Cam2000 series cams
- Sold in unit of measure as noted below

Titus

Item #	Drilling Diameter	Drilling Distance	Unit of Measure
TI05570YA	10mm dowel thread	24mm	Hundred

System 5 Quickfit Combi Dowel

- Suitable for use with all Cam2000 series cams
- Sold in unit of measure as noted below

Titus

Item #	Drilling Diameter	Drilling Distance	Unit of Measure	Box Qty
TI09424.885.001	6mm dowel thread	34mm	Box	2,000

System 5 Cams, Cam2000 Series

- Cam Diameter: 15mm
- Made of Zinc
- Sold in unit of measure as noted below

Titus

Item #	Panel Thickness	Drilling Depth	Drilling for Dowel	Unit of Measure
TI05653ZN	12/13mm	10.9mm	6-6.5mm	Each
TI05656ZN	18/19mm	14mm	9-9.5mm	Hundred