

**SECTION T - TABLE OF CONTENTS**

**Section T Contents:**

**C.A. TECHNOLOGIES**

Pressure Reduced Guns ..... 2  
 HVLP Guns..... 3  
 Mini and Glaze Guns..... 4  
 Conventional Guns..... 5  
 Adhesive Spray Gun and Gun  
 Cleaning Kit..... 6  
 Gun Cups and Accessories ..... 7  
 Tanks & Accessories..... 8  
 Air Assist Airless..... 9-12

**SAMES-KREMLIN**

Manual Spray Guns ..... 13-15  
 Manual Spray Gun Set Ups..... 16  
 Glue Gun Setup ..... 16  
 Spray Gun Accessories..... 17  
 Tanks & Accessories..... 18  
 Airmix® Guns ..... 19  
 Airmix® Systems..... 20-22  
 Airmix® Accessories ..... 23

**3M™ GUNS AND PPS™**

Accuspray™ ONE Gun, Legacy  
 Version 1.0 ..... 24  
 PPS™ Accessories, Legacy Version 1.0..... 25  
 Accuspray™ ONE Gun, Version 2.0..... 26  
 Performance Gun, Version 2.0..... 27-28  
 PPS™ Accessories, Version 2.0 ..... 29-30  
 Spray Booth Accessories ..... 30-32

A  
B  
C  
D  
E  
F  
G  
H  
I  
J  
K  
L  
M  
N  
O  
P  
Q  
R  
S  
T  
U  
V  
W  
X  
Y

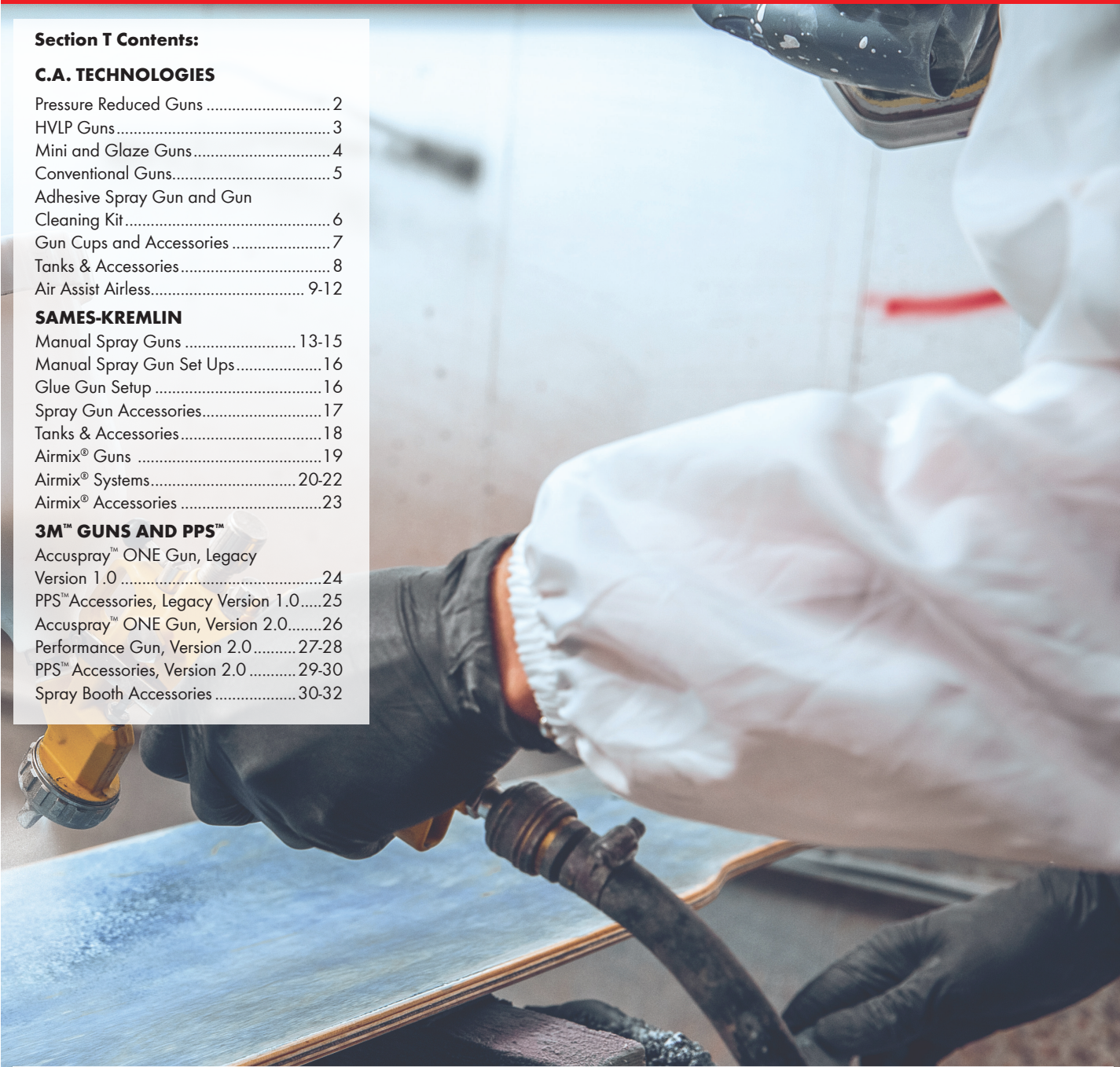

**A PRESSURE REDUCED GUNS**



CATCPR-G-W-PPS

**CPR-G Pressure Reduced, Fine Finish**



- Combines the transfer efficiency of HVLP with the speed and finish quality of conventional air spray
- Stainless steel fluid passages
- Needle/nozzle setups: 1.0 mm, 1.3mm, 1.5mm and 1.7mm
- Air Caps: CPR2101 (11 cfm) and HVLP1301 (13.5 cfm) @ 29 psi
- Nozzle requires 11 cfm at 29 psi recommended inlet pressure

**Specifications:**

- Air Inlet: 1/4" NPS (m)
- Fluid Inlet: 16m x 1.5
- Weight: 20 oz

Item #	Includes:
CATCPR-G-W	CPR-G gun, 4 needle/nozzle setups, 2 air caps, 1 qt aluminum cup and case
CATCPR-G-W-PPS	CPR-G gun, 4 needle/nozzle setups, 2 air caps, Medium PPS cup and 3 lids/liners, case
CAT10-105	Gun Repair Kit



**CPR Pressure Reduced Techline (Fine Finish)**



- Economy version of the compliant spray technology
- Can be used to spray a wide range of coatings
- Needle/nozzle setups: 0.8mm, 1.3mm and 1.7mm
- Air Caps: CPR2101 (11 cfm) and HVLP1301 (13.5 cfm) @ 29 psi
- Plated Brass passages and non-replaceable head insert

**Specifications:**

- Air Inlet: 1/4" NPS (m)
- Fluid Inlet: 16m x 1.5
- Weight: 15 oz

Item #	Includes:
CATCPR-T3	Techline T3 gun, 3 needle/nozzle setups, 2 air caps, 1 qt. plastic cup, wrench, cleaning kit

**HVLP GUNS**



**Lynx 300 HVLP**

**C.A. Technologies**

- Fine finish HVLP air spray gun for achieving the ultimate in fine atomization
- Designed for production use
- Self adjusting needle, packing, air adjusting valve, lightweight and rugged construction
- Standard with all stainless steel fluid passages
- Patented 12-point plenum design delivers smaller and more uniform material particles for an even, smooth finish
- Complies with all environmental regulations for HVLP

**Specifications:**

- Air Inlet: 1/4" NPS (m)
- Fluid Inlet: 3/8" NPS (m)
- Weight: 20 oz.

Item #	Includes:
CATL300H	L300H gun with 1 needle/nozzle setup (1.3mm nozzle and 23-1013 air cap)
CAT10-106	Lynx Repair Kit



CATCPJ100H-W

**Jaguar J100H, General Purpose**

**C.A. Technologies**

- General purpose gravity feed gun intended for wood finishing
- Needle/Nozzle Setups: 1.0mm, 1.4mm, 1.5mm and 1.7mm
- Air Caps: 1090 (6cfm) and 1093 (10 cfm)
- Featuring stainless steel fluid passages, low volume nozzles for small HP compressor use and self-adjusting needle packing
- Complies with all HVLP environmental regulations

**Specifications:**

- Air Inlet: 1/4" NPS (m)
- Fluid Inlet: 16m x 1.5
- Weight: 25 oz

Item #	Includes:
CATCPJ100H-W	J100H gun, 4 needle/nozzle setups, 2 air caps, 1 qt aluminum gravity cup and case
CATCPJ100H-W-PPS	J100H gun, 4 needle/nozzle setups, 2 air caps, Medium PPS cup and 3 lids/liners, case
CAT10-105	Gun Repair Kit

A  
B  
C  
D  
E  
F  
G  
H  
I  
J  
K  
L  
M  
N  
O  
P  
Q  
R  
S  
T  
U  
V  
W  
X  
Y

**A MINI & GLAZE GUNS**

B  
C  
D  
E  
F  
G  
H  
I  
J  
K  
L  
M  
N  
O  
P  
Q  
R  
S  
T  
U  
V  
W  
X  
Y



CATCA-T2-GLAZE

**Precision Mini T2 and T2 Glaze**

The T2 mini portable gravity spray gun is designed for all your professional grade touch up needs. With its HVLP compliance and low air consumption of 4 CFM, this spray gun is ideal for any touch up situation.

- Great atomization for spray stain, no more spray and wipe
- 4 CFM air requirements for use with most small compressors
- Small and compact with minimal moving parts
- Pattern control is easily adjusted by your thumb
- 4 inch spray pattern, ideal for touch up jobs
- No air needed when applying glaze



Item #	Includes:
CATCA-T2	CA-T2 gun, 0.8 mm, 1.2mm and 1.3mm needle & nozzle, 150ml aluminum cup and 125ml plastic cup, brush, wrench, and case
CATCA-T2-GLAZE	CA-T2-GLAZE gun, Glaze tip & needle, 1.2mm and 1.3mm needle & nozzle, 150ml aluminum cup and 125ml plastic cup, brush, wrench, and case
CATCA60-T2-30-10-G	1.0mm glaze nozzle only
CATCA60-T2-30-08	0.8mm needle & nozzle
CATCA60-T2-30-10	1.0mm needle & nozzle
CATCA60-T2-30-12	1.2mm needle & nozzle
CATCA60-T2-30-13	1.3mm needle & nozzle
CATCA60-T2-10	T2 Repair Kit, springs & seal
CATCA91-573	T2 Adapter for 3M™ PPS™
CAT51-406	150ml Aluminum cup
CAT51-407	125ml Plastic cup
CAT51-408	450ml Aluminum cup

**Glazing Made Easy**

**Easily apply glaze** into profiles

- No air needed
- No more spray and wipe

**Easily apply spray stain** onto your piece

- Great atomization for spray stain
- No more spray and wipe

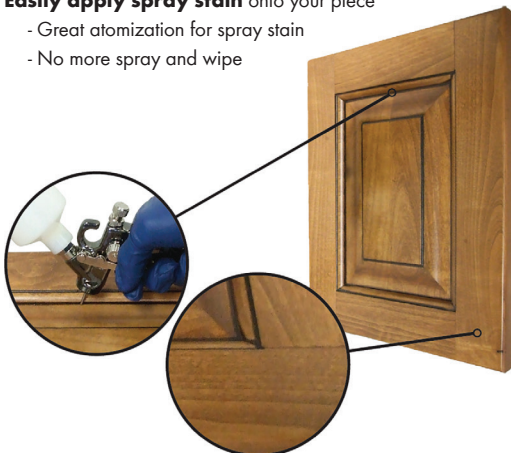

**CONVENTIONAL GUNS**



**Lynx 100C (General Purpose), Pressure**



- Economy version of the compliant spray technology
- Can be used to spray a wide range of coatings
- Stainless steel fluid passages
- Plated brass passages and non-replaceable head insert

**Specifications:**

- Air Inlet: 1/4" NPS (m)
- Fluid Inlet: 16m x 1.5
- Weight: 15 oz.

Item #	Includes:
CAT100C-12-2263	L100C gun with 1 needle/nozzle setup (1.2mm nozzle and 21-2263 pressure air cap)



**Lynx 300 Conventional**



- Designed for production use, perfect for any fine finish application
- Self-adjusting needle and air valve packing, air adjusting valve, lightweight and rugged construction
- Comes standard with stainless steel fluid passages
- Patented 12-point plenum design delivers smaller and more uniform material particles for an even, smooth finish

**Specifications:**

- Air Inlet: 1/4" NPS (m)
- Fluid Inlet: 3/8" NPS (m)
- Weight: 20 oz.

Item #	Includes:
CATL300C	L300C gun with 1 needle/nozzle setup (1.3mm nozzle and 23-2013 air cap)
CAT10-106	Lynx Repair Kit



**Tomahawk (General Purpose), Pressure**



- Lightweight, ergonomically designed and price competitive high quality production spray gun
- Designed for those who want a conventional gun for spraying a wide range of coatings from glue to fine finish
- Stainless steel fluid inlet and head

**Specifications:**

- Air Inlet: 1/4" NPS (m)
- Fluid Inlet: 3/8" NPS (m)
- Weight: 15 oz.

Item #	Includes:
CATTG100C-12-2263	TG100C gun with 1 needle/nozzle setup (1.2mm nozzle and 21-2263 pressure air cap)

A  
B  
C  
D  
E  
F  
G  
H  
I  
J  
K  
L  
M  
N  
O  
P  
Q  
R  
S  
T  
U  
V  
W  
X  
Y

**A ADHESIVE SPRAY GUN**



**Panther, Solvent Based Glues/Adhesives**



- Standard Solvent Based setup: 1.8 x 2266-3T
- General purpose conventional air spray gun designed for glue / adhesive applications
- Body and air cap are Teflon anodized for easy clean-up and longer life
- Self-adjusting needle packing, inexpensive nozzle replacement and rugged construction
- All stainless steel fluid passages and Teflon anodized body and air cap

**Specifications:**

- Air Inlet: 1/4" NPS (m)
- Fluid Inlet: 3/8" NPS (m)
- Weight: 20 oz

Item #	Includes:
CATP100G-18-22663T	Panther gun with 1 needle/nozzle setup
CAT10-110	Panther Repair Kit

B  
C  
D  
E  
F  
G  
H  
I  
J  
K  
L  
M  
N  
O  
P  
Q  
R  
S  
T  
U  
V  
W  
X  
Y



**Gun Cleaning Kit**



- Standard gun cleaning kit

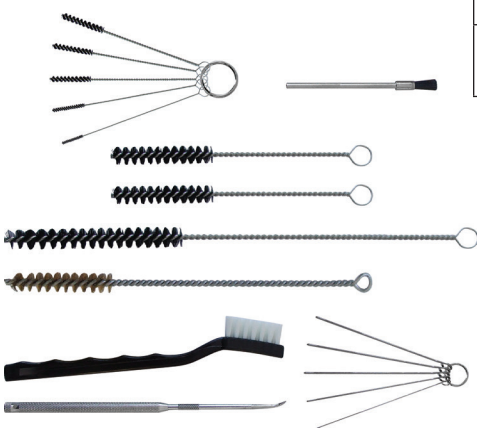

Item #	Includes:
CAT10-500	6 picks on ring, 1 detail brush, 3 round bristle brushes, 1 large round bristle brush, 1 gun brush, 5 small round brushes, 1 pick

**GUN CUPS & ACCESSORIES**



**Siphon Cup, No Drip, 1 Quart**

- Drip proof and made of aluminum alloy



Item #	Includes:
CAT51-301	Siphon Cup, 1 Quart
CAT51-321	Replacement Gasket



**Gravity Cups**

- Cups for CA Technologies gravity guns
- Both cups have no drip feature in lid



Item #	Description
CAT51-400	Plastic Gravity Cup, 1 Quart
CAT51-401	Aluminum Gravity Cup, 700 ml
CAT51-413	Replacement Lid, Plastic cup
CAT51-418	Replacement Lid, Aluminum cup

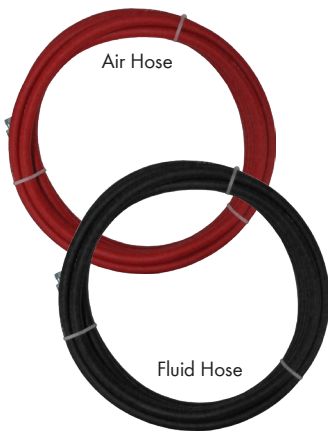

**Low Pressure Hoses**

**Air Hose Specifications:**

- Temperature range is -20°F to +190°F
- Textile reinforced
- Smooth red synthetic rubber casing
- Oil resistant
- 200 PSI working pressure

**Fluid Hose Specifications:**

- Temperature range is 0°F to 190°F
- Tube: Nylon 11 (silicone-free)
- Braided high strength synthetic yarn
- Smooth black synthetic rubber casing
- 750 PSI working pressure



Item #	Type	Description
CAT53-112-25	Air	5/16" ID with 1/4" NPS fittings, 25' length
CAT53-213-25	Fluid	1/4" ID with 3/8" NPS fittings, 25' length
CAT53-215-25	Fluid	3/8" ID with 3/8" NPS fittings, 25' length

**High Flow Quick Disconnect Couplings**

- For HVLP applications

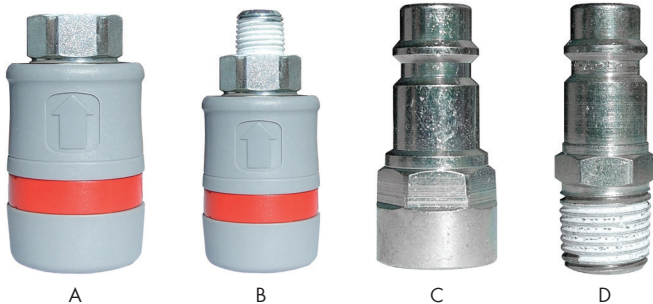

	Item #	Description
A	CAT53-570	1/4" Female Body
B	CAT53-571	1/4" Male Body
C	CAT53-572	1/4" Female Stem
D	CAT53-573	1/4" Male Stem

A  
B  
C  
D  
E  
F  
G  
H  
I  
J  
K  
L  
M  
N  
O  
P  
Q  
R  
S  
T  
U  
V  
W  
X  
Y

**A TANKS & LINERS**



**2.5 Gallon Pressure Tanks**



- The CA Technologies 2.5 Gallon tanks come with 2 regulators, with or without agitation
- Flat bottom tanks for ease of setting 1 quart or 1 gallon can inside
- All tanks come with wheels for easy maneuverability

Item #	Description	Application
CAT51-202	Teflon coated 2.5 gal. tank with 2 regulators	Solvent based stains, top-coats, primers and adhesives
CAT51-204	Teflon coated 2.5 gal. tank with 2 regulators and agitation	
CAT51-220	Replacement Gasket	-

B  
C  
D  
E  
F  
G  
H  
I  
J  
K  
L  
M  
N  
O  
P  
Q  
R  
S  
T  
U  
V  
W  
X  
Y



**5 Gallon Pressure Tanks  
No Agitation**



- Flat bottom tanks allow for ease of setting 5 gallon cans inside
- Tank comes with wheels for easy maneuverability

Item #	Description	Application
CAT51-504	Heavy gauge steel with baked on enamel, 5 Gal. Tank with 2 regulators, air agitation	Solvent Based Stains, Top coats, Primers and Adhesives
CAT51-508	Heavy gauge steel with baked on enamel, 5 Gal. Tank with 2 Regulators, No agitation	Solvent Based Stains, Top-coats, Primers and Adhesives

CAT51-508



**Tank Liners**



- Sold in full boxes only

Item #	Description	Box Qty
<b>C.A. Technologies Tank Liners</b>		
CAT51-261-12	2.5 Gallon Tank Liners	12
CAT51-261-60	2.5 Gallon Tank Liners	60



**AIR ASSIST AIRLESS GENERAL INFORMATION**

**Air Assist Airless units – for the finest finish & highest transfer efficiency!**

**C.A. Technologies**



The **Bobcat Air Assist Airless** gun is designed for production wood and metal finishing. Features include lightweight design, stainless steel fluid passages and an integrated fluid filter. The handle is ergonomically designed to reduce fatigue and fit comfortably in any size hand. The trigger pull has been designed to be ultra-light resulting in less muscle strain and operator fatigue. An innovative trigger safety has also been integrated into the gun to provide optimum safety. The Bobcat’s superior atomization is achieved with the precise geometry of the airless tip and HVLP air cap, giving you the finest finish possible.

- Fine finish soft spray
- Ergonomic design
- Made in America
- Handgun integrated fluid filter
- 100% Stainless steel fluid passages

**17oz Gun Weight**

The **Cougar Air Assist Airless** is a fine finish gun for production wood or metal fine finish spraying. Features include all stainless steel fluid passages, ergonomic design, integrated fluid filter and easy trigger pull. Superfine soft atomization is achieved with precise geometry of airless fluid tip and low volume aircap that mix at the locus of atomization. Delivers desired finishes at production speeds. Pump (below) and gun system can be operated with a 1.5 HP compressor.

- Fine finish soft spray
- Smooth Fluid Flow Path
- Made in America
- Handgun integrated fluid filter
- 100% Stainless steel fluid passages

**23oz Gun Weight**

**For Bobcat & Cougar setups,  
See next 2 pages**

A  
B  
C  
D  
E  
F  
G  
H  
I  
J  
K  
L  
M  
N  
O  
P  
Q  
R  
S  
T  
U  
V  
W  
X  
Y

**AIR ASSIST AIRLESS OUTFITS**

A  
B  
C  
D  
E  
F  
G  
H  
I  
J  
K  
L  
M  
N  
O  
P  
Q  
R  
S  
T  
U  
V  
W  
X  
Y



**Bobcat Air Assist Airless Gun**



- Lightweight design, stainless steel fluid passages and an integrated fluid filter
- Handle is ergonomically designed to reduce fatigue and fit comfortably in any size hand
- Trigger pull is designed to be ultra light, resulting in less strain and operator fatigue
- Innovative trigger safety has been integrated into the gun to provide optimum safety
- Superior atomization is achieved with the precise geometry of the airless tip and HVLP air cap, giving you the finest finish possible
- Gun weight 17 oz

**Get the finest finish available!**

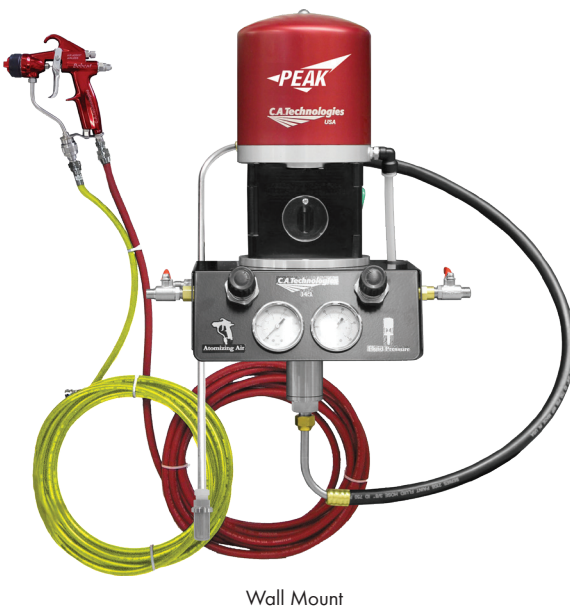

Item #	Style	Includes
<b>Air Assist Airless Outfit, Solvent Based Materials</b>		
CATOB14-C5-411	Cart Mount	Bobcat gun, 5 gallon pump and cart with 25' fluid and air hose, .411 tip
CATOB14-C5-513	Cart Mount	Bobcat gun, 5 gallon pump and cart with 25' fluid and air hose, .513 tip
CATOB14-W5-411	Wall Mount	Bobcat gun, wallmount 5 gal. pump and siphon hose, 1/8" fluid hose and 1/4" air hose, .411 tip
<b>Accessories</b>		
CATBOBCAT-411	Bobcat	Bobcat gun only, with .411 tip
CAT10-138	Bobcat	Gun Repair Kit
CAT10-137	Bobcat	Soft Seal Repair Kit
CAT10-116	AAA	Air Motor Repair Kit
CAT10-117	AAA	14:1 Fluid Section Repair Kit
CAT36-411	AAA	.411 Tip Assembly
CAT36-413	AAA	.413 Tip Assembly

**AIR ASSIST AIRLESS OUTFITS**



**Get the finest finish available!**

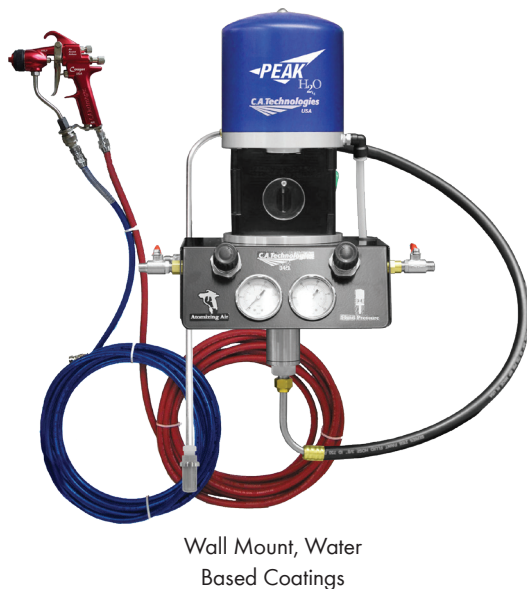

**Cougar Air Assist Airless Gun**



- Fine finish gun for production wood fine finish spraying
- All stainless steel fluid passages, ergonomic design, integrated fluid filter and easy trigger pull
- Superfine soft atomization is achieved with precise geometry of the airless fluid tip and low volume aircap
- Deliver desired finished at production speed
- Gun weight 23 oz

Item #	Style	Includes
<b>Air Assist Airless Outfit, Water Based Materials</b>		
CATH20OC14W512409	Wall Mount	Cougar gun, 5 gal. pump and siphon hose, 3/16" fluid hose and 1/4" air hose, .409 tip
CATH20OC14C512409F	Cart Mount	Cougar gun, 5 gallon pump and cart with 25' fluid and air hose, .409F Opti-tip
CATH20OC14W512409F	Wall Mount	Cougar gun, wallmount 5 gal. pump and siphon hose, 3/16" fluid hose and 1/4" air hose, .409F Opti-tip
<b>Air Assist Airless Outfit, Solvent Based Materials</b>		
CATOC14-C5-411	Cart Mount	Cougar gun, 5 gallon pump and cart with 25' fluid and air hose, .411 tip
CATOC14-C5-513	Cart Mount	Cougar gun, 5 gallon pump and cart with 25' fluid and air hose, .513 tip
CATOC14-W5-411	Wall Mount	Cougar gun, wallmount 5 gal. pump and siphon hose, 3/16" fluid hose and 1/4" air hose, .411 tip
CATOC14-W5-12-411	Wall Mount	Cougar gun, wallmount 5 gal. pump and siphon hose, 3/16" fluid hose and 1/4" air hose, .411 tip, 1/2" Inlet
CATOCW5-413	Wall Mount	Cougar gun, wallmount 5 gal. pump and siphon hose, 3/16" fluid hose and 1/4" air hose, .413 tip
<b>Accessories</b>		
CATCOUGAR-C411	Cougar	Cougar Gun only, with .411 tip
CAT10-113	Cougar	Gun Repair Kit
CAT10-116	AAA	Air Motor Repair Kit
CAT10-117	AAA	14:1 Fluid Section Repair Kit
CAT36-411	AAA	.411 Tip Assembly
CAT36-413	AAA	.413 Tip Assembly

A  
B  
C  
D  
E  
F  
G  
H  
I  
J  
K  
L  
M  
N  
O  
P  
Q  
R  
S  
T  
U  
V  
W  
X  
Y

**A AIR ASSIST AIRLESS ACCESSORIES**

**B AAA Accessories & Replacement Components**



• Check your owners manual / parts list before ordering

Item #	Description
CAT36-311	.311 Tip Assembly
CAT36-409	.409 Tip Assembly
CAT36-409F	.409 Opti Tip Assembly
CAT36-411F	.411 Opti Tip Assembly
CAT36-415	.415 Tip Assembly
CAT36-511	.511 Tip Assembly
CAT36-513	.513 Tip Assembly
CAT36-515	.515 Tip Assembly
CAT36-517	.517 Tip Assembly
CAT36-611	.611 Tip Assembly
CAT36-613	.613 Tip Assembly
CAT36-713	.713 Tip Assembly

Item #	Description
CAT26-101P	Air Cap Assembly
CAT66-103	Air Cap Adapter
CAT66-124	Filter Element, 60 Mesh
CAT66-125	Filter Element, 100 Mesh
CAT66-130	Needle/Ball Cartridge Assembly
CAT74-510	Siphon Hose Strainer Assembly, 3/8"
CAT74-511	Siphon Hose Strainer Assembly, 1/2" H20
CAT74-560	Replacement Inlet Strainer Screen
CAT74-561	Siphon Hose Strainer 3/8"
CAT98-8019	O-Ring for Air Cap Adaptor

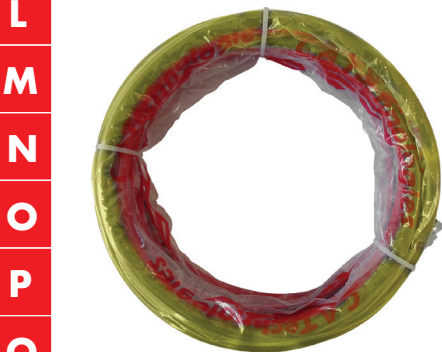

CAT53-404A

**High Pressure Hoses**



• For use with Air Assist Airless units

Item #	Type	Description
CAT53-402A	Fluid and Air	3/16" ID fluid hose with 1/4" connections & 1/4" ID air hose with 1/4" NPS Fittings, 25' length
CAT53-404A	Fluid and Air	1/8" ID fluid hose with 1/4" connections & 1/4" ID air hose with 1/4" NPS & 3/8" NPS Fittings, 25' length
CAT53-404-35A	Fluid and Air	1/8" ID fluid hose with 1/4" connections & 1/4" ID air hose with 1/4" NPS & 3/8" NPS Fittings, 35' length
CAT53-402	Fluid	3/16" ID, 1/4" connections, 25' length
CAT53-404	Fluid	1/8" ID, 1/4" connections, 25' length
CAT53-111-25	Air	1/4" ID, 1/4" NPS fittings on both ends, 25' length



CAT91-215



CAT91-36

**Air Assist Airless Maintenance**



Item #	Includes
CAT91-215	12 Pack Tip Cleaning Needles
CAT91-36	Throat Seal Lubricant

**MANUAL SPRAY GUNS**



**FStart Suction-Feed Spray Gun, Conventional**



The FStart S is the right conventional solution for hard to atomize coatings with an entry-level price.

- Accessible for beginners and professional painters
- Comfortable for all hands
- Easy cleaning

**Specifications:**

- Gun Body: Cast Aluminum
- Nozzle: Stainless steel
- Needle: Stainless steel
- Wetted Parts: Stainless steel / aluminum
- Weight: 14 oz. without cup, 26 oz. with cup
- Air Inlet: M 1/4" NPS
- Fluid Inlet: M 3/8" NPS

Item #	Includes:
KRE135.756.518	Gun, cup, gun wrench and 1.8mm nozzle



**FStart Gravity-Feed Spray Gun, Conventional & HVLP**



Multi-purpose economy gun, the FStart G is easy to use and guarantees a high quality finish.

- Great finish quality
- Great value
- Includes gravity cup
- Accessible for beginners and professional painters
- Comfortable for all hands
- Easy cleaning

**Specifications:**

- Gun Body: Cast Aluminum
- Nozzle: Stainless steel
- Needle: Stainless steel
- Wetted Parts: Stainless steel / aluminum
- Weight: 14 oz. without cup, 19 oz. with cup
- Air Inlet: M 1/4" NPS

Item #	Type	Includes:
KRE135.756.115	HVLP	Gun, cup, gun wrench and 1.5mm nozzle
KRE135.756.118	HVLP	Gun, cup, gun wrench and 1.8mm nozzle
KRE135.756.218	Conventional	Gun, cup, gun wrench and 1.8mm nozzle

A  
B  
C  
D  
E  
F  
G  
H  
I  
J  
K  
L  
M  
N  
O  
P  
Q  
R  
S  
T  
U  
V  
W  
X  
Y

**A MANUAL SPRAY GUNS**



**FPro Gravity-Feed Spray Gun,  
Conventional & HVLP**



Perfectly balanced, the FPro G spray gun provides a superior finish for all professional painters in industrial markets.

- Patented Vortex technology
- Includes anti-drip cup
- For all wood finishes

**Specifications:**

- Gun Body: Anodized Forged Aluminum
- Nozzle: Stainless steel
- Needle: Stainless steel
- Wetted Parts: Stainless steel
- Weight: 22 oz.
- Air Inlet: M 1/4" NPS

Item #	Type	Includes:
KRE136.794.318	Conventional	Gun, cup, gun wrench and 1.8mm nozzle
KRE136.797.418	HVLP	Gun, cup, gun wrench and 1.8mm nozzle

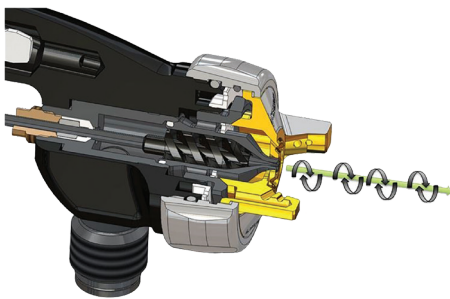

**Embedded Innovations:**

**VORTEX**



Produces a swirling effect to the paint allowing the paint to leave the nozzle under a helical-shape pattern to improve the homogeneity of the film build.

**MAG-TRIGGER**



Magnetic Assist Trigger for light trigger pull.

**MANUAL SPRAY GUNS**



**FStart Pressure-Feed Spray Gun, HVLP**



The FStart P is the right solution to spray low to medium viscosity material at a reduced price ensuring a good spray quality.

- Great finish quality
- Easy to service

**Specifications:**

- Gun Body: Cast Aluminum
- Nozzle: Stainless steel / aluminum
- Needle: Stainless steel
- Wetted Parts: Stainless steel / aluminum
- Weight: 15 oz.
- Air Inlet: M 1/4" NPS
- Fluid Inlet: M 3/8" NP

Wide range of nozzles available!

Item #	Includes:
KRE135.756.312	Gun, gun wrench and 1.2mm nozzle



**FPro P Pressure-Feed Spray Gun, LVLP & HVLP**



Perfectly balanced, the FPro P spray gun provides a superior finish for all painters.

- Includes patented Vortex and Restrictor technology
- Ergonomic design reduces painter fatigue
- Consistent, repeatable, high-quality finish
- Anodized Forged Aluminum

**Specifications:**

- Gun Body: Anodized Forged Aluminum
- Nozzle: Stainless steel
- Needle: Treated Stainless steel
- Wetted Parts: Stainless steel
- Weight: 17 oz.
- Air Inlet: M 1/4" NPS
- Fluid Inlet: M 3/8" NPS

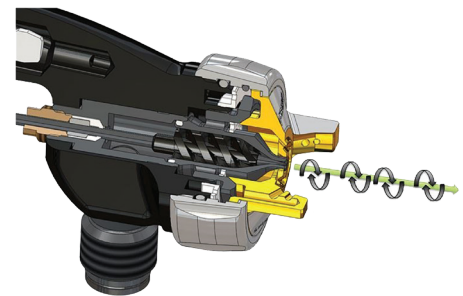

Item #	Type	Includes:
KRE135.770.512	LVLP	Gun, gun wrench and 1.2mm nozzle
KRE135.777.512	HVLP	Gun, gun wrench and 1.2mm nozzle

**Embedded Innovations:**

**VORTEX**



Produces a swirling effect to the paint allowing the paint to leave the nozzle under a helical-shape pattern to improve the homogeneity of the film build.

**RESTRICTOR**



Calibrates the flow rate to create a controlled pressure loss upstream allowing an increase in the working pressure for an enhanced Airspray experience.

A  
B  
C  
D  
E  
F  
G  
H  
I  
J  
K  
L  
M  
N  
O  
P  
Q  
R  
S  
T  
U  
V  
W  
X  
Y

**A MANUAL SPRAY GUN SET-UPS**

B  
C  
D  
E  
F  
G  
H  
I  
J  
K  
L  
M  
N  
O  
P  
Q  
R  
S  
T  
U  
V  
W  
X  
Y



**FStart HVLP Gun with 2.5-gal Pressure Tank**



The FStart is a multi-purpose economy gun that's easy to use and guarantees a high quality finish.

- Includes single regulated tank
- Includes 25ft hoses
- 1.2mm nozzle set up

**Gun Specifications:**

- Gun Body: Cast Aluminum
- Nozzle: Stainless steel / aluminum
- Needle: Stainless steel
- Wetted Parts: Stainless steel / aluminum
- Weight: 14 oz.
- Air Inlet: M 1/4" NPS
- Fluid Inlet: M 3/8" NPS

Item #	Includes:
KRE152.756.425	FStart P HVLP gun with 1.2mm nozzle and 2.5 gallon carbon steel tank with stainless fittings



**Glue Spray System, Single Regulator**



- Includes 2.5-gal pressure tank, FPro Gun, and 25ft hose set
- Tank is carbon steel with stainless fittings
- Ideal set up for both water based and solvent based contact adhesives
- High transfer efficiency up to 78%
- Optimized maintenance and easy disassembly

Item #
KRE668.222.015



**SPRAY GUN ACCESSORIES**

**FStart Needle and Nozzle Kits**



Item #	Type	Nozzle Size	Fluid Output (cc/min)
KRE131.756.118	HVLP	1.8mm	140
KRE131.756.218	CONV	1.8mm	200

**Gun Cleaning Kit**



Includes: 1/4" nylon brush, gun lubricant, tip cleaning needles, cleaning needle pin vise.

Item #
KRE668.000.395

**Air Hose**



- Thermoplastic Polyurethane hose is lightweight and flexible
- With 1/4" fittings

Item #	Diameter	Length	Color
KRE050.382.114	1/4"	25'	Black
KRE050.382.116	1/4"	50'	Black

**A TANKS & ACCESSORIES**

B  
C  
D  
E  
F  
G  
H  
I  
J  
K  
L  
M  
N  
O  
P  
Q  
R  
S  
T  
U  
V  
W  
X  
Y



KRE668.222.140

**Pressure Tank 2.5 Gal, Dual Regulators**



- Use with any Conventional, LVLP, or HVLP spray guns
- Carbon steel with stainless fittings
- Fluid and air pressure regulators
- Easy to use and easy maintenance
- Lube-free and high performing premium agitator (KRE668.222.150 only)

Item #	Agitator
KRE668.222.140	No
KRE668.222.150	Yes



KRE668.222.150



**Tank Liners, 2.5 gallon**



- Speed up clean up with these tank liners
- Sold in packs of 10

Item #
KRE668.222.032



**5 Gallon Pail Mount Agitator**



- 5 Gallon stainless steel agitator with cover and nylon blade
- Pneumatic motor
- 60 to 300 RPM
- Stainless steel construction

Item #
KRE668.668.806

**AIRMIX® GUNS**



**SFlow™ 275 Airless® Spray Gun**



The SFlow™ is an Airless® paint sprayer used for applying protective coatings. This gun delivers real product savings for industrial applications. The ergonomic design provides flexibility in extreme conditions and is ideal for handling high solid content paints and zinc-rich primers.

- Order tip separately
- Excellent for spray stains when used with SKILL™ Tip
- High transfer efficiency of 81%
- Good atomization quality
- Designed for heavy-duty industrial applications
- Maximum Fluid Pressure 4,000 psi

**Specifications:**

- Gun Body: Forged Aluminum
- Wetted Parts: Stainless steel, PTFE, carbide
- Weight: 21 oz.
- Fluid Inlet: M 1/4" NPS

Item #	Includes:
KRE135.740.200	Gun, filter and tip retainer (tip not included, see below)
KRE000.300.713	7 - 13 (.512) tip, .012 orifice, 10" pattern
KRE000.300.715	7 - 15 tip, .012 orifice, 10" pattern
KRE000.300.913	9 - 13 (.613 tip, .013 orifice, 10" pattern



A  
B  
C  
D  
E  
F  
G  
H  
I  
J  
K  
L  
M  
N  
O  
P  
Q  
R  
S  
T  
U  
V  
W  
X  
Y



**Xcite™ Airmix® Spray Gun, HVLP Compliant**



- The Xcite™ Airmix® manual spray gun delivers outstanding performance with unsurpassed finish quality
- Product savings & environmental protection due to high transfer efficiency (up to 86%)
- Unsurpassed atomization quality of spraying
- Ergonomically designed for outstanding performance

**Specifications:**

- Gun Body: Forged Aluminum
- Wetted Parts: Stainless steel, PTFE, carbide
- Weight: 18 oz.
- Air Inlet: M 1/4" NPS
- Fluid Inlet: M 1/2" JIC

Item #	Includes:
KRE668.720.100	Xcite™ 120 with swivel, air cap, and 09-114 tip



A  
B  
C  
D  
E  
F  
G  
H  
I  
J  
K  
L  
M  
N  
O  
P  
Q  
R  
S  
T  
U  
V  
W  
X  
Y

**AIRMIX® SYSTEMS**



Cart Mount

**10C18 Airmix® System**



The 10C18 Airmix professional paint sprayer is only available as a complete spraying package. It ensures constant and pulse-free delivery for a superior finish.

- Includes Xcite™ Gun, 25ft hoses and 5-gal siphon kit
- Up to 86% transfer efficiency
- Stainless steel fluid section
- Designed for long-lasting industrial use
- Fast color changes with minimum solvent consumption
- Built with minimal parts to minimize maintenance time and operation
- 10:1 pressure ratio (up to 1,000 psi fluid pressure)
- .28 gallons per minute flow rate

Item #	Type
KRE668.665.751	Wall Mount
KRE668.665.759	Cart Mount



**15C25 Wall-mount Airmix® System**



The compact Airmix® painting pump is the ideal partner for Airmix® spray guns, providing exceptional finish quality & high transfer efficiency.

- Includes Xcite™ gun, 25ft hose and 5- gal siphon kit
- Excellent finish quality
- Pump designed to work with all coatings including water borne and 2K (2 component)
- Single gun system
- Built with minimal parts
- Low cost of ownership
- 15:1 pressure rate (up to 1,500 fluid pressure)
- .4 gallons per minute flow rate

Item #
KRE668.141.000

**AIRMIX® SYSTEMS**

A  
B  
C  
D  
E  
F  
G  
H  
I  
J  
K  
L  
M  
N  
O  
P  
Q  
R  
S  
T  
U  
V  
W  
X  
Y



**15C50 Wall-Mount Airmix® System**



- Includes Superfilter, Xcite™ Gun, 25ft hose, and 5-gal siphon kit
- Capable of running 2 guns
- Pump designed to work with all coatings including water borne and 2K (2 component)
- Built with minimal parts
- Low cost of ownership
- 15:1 pressure ratio (up to 1,500 psi fluid pressure)
- .8 gallons per minute flow rate

<b>Item #</b>
KRE668.143.000



**16C240 Wall-Mount Airmix® Pump**



The 16C240 is a medium pressure/medium output paint pump. Recommended for 1 to 8 Airmix® gun operations.

- Includes Superfilter and 5-gal siphon
- Stainless steel fluid section
- 16:1 pressure ratio (up to 1,600 psi fluid pressure)
- 3.8 gallons per minute flow rate
- Perfect for flatline operations
- Long life packings

<b>Item #</b>
KRE151.797.200



**20C50 Wall-mount Airmix® System**



The 20C50 paint pump is the perfect pump for Airmix® applications with its exceptional performance.

- Includes Xcite™ Gun, Superfilter, 25ft hoses, and 5-gal siphon
- Will support 2 spray guns
- Excellent finish quality
- Up to 86% transfer efficiency
- Ideal for Airmix® applications
- High efficiency pump for maximum energy savings
- Optimized construction for simple & quick maintenance
- 20:1 pressure ratio (up to 2,000 psi fluid pressure)
- .8 gallons per minute flow rate

<b>Item #</b>
KRE668.773.100

**AIRMIX® SYSTEMS & ACCESSORIES**

A  
B  
C  
D  
E  
F  
G  
H  
I  
J  
K  
L  
M  
N  
O  
P  
Q  
R  
S  
T  
U  
V  
W  
X  
Y

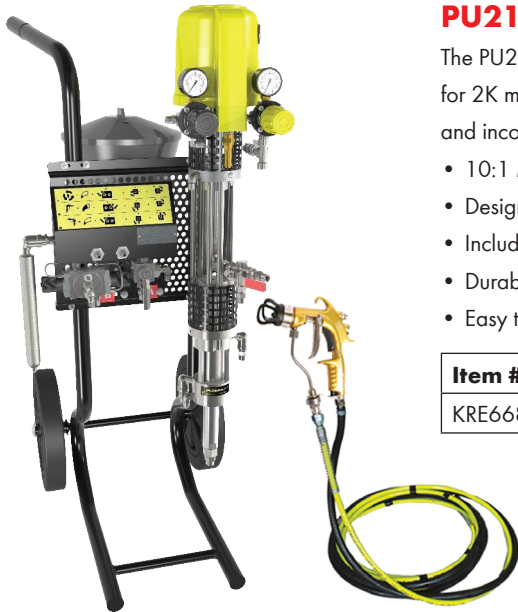

**PU2160F Airmix® 2K Mixing System**



The PU2160F mechanical meter mixing machine comes ready to use for 2K materials. It includes a metering pump (fixed ratio) for medium Airmix® pressures and incorporates the Flowmax® Bellows technology on the catalyst fluid section for total reliability.

- 10:1 Mix ratio
- Designed for conversion varnish application
- Includes Xcite™ Gun, 25ft hoses and 5-gal siphon kit
- Durable pump design
- Easy to operate

<b>Item #</b>
KRE668.586.101

**Reduce labor and waste from manual mixing**



**Cyclomix™ Micro 3+1PH**



The Plural Component Electronic Mixing & Dosing System allows the user to dose, mix & continuously deliver two-component paints.

- Mix conversion varnish on demand
- Supports 3 bases and 1 catalyst
- Reduce labor and waste created with manual mixing
- Significant material savings

**Contact your WLAC Sales Representative for a quote or more information**



**Airmix® Tips**



- Double groove spray tips are used with Airmix® gun models: ATX, AVX, MVX, and XCITE®

Item #	Tip Size	Degree	Orifice Size	Fan Pattern
KRE134.506.134	06 - 134 (.511)	55	0.011	10 - 11 inches
KRE134.506.094	06 - 094 (.411)	40	0.011	7 - 8 inches
KRE134.509.134	09 - 134 (.513)	55	0.013	10 - 11 inches
KRE134.509.154	09 - 154 (.613)	60	0.013	11 - 12 inches
KRE134.509.132	09 - 132 (.513)	55	0.013	10 - 11 inches
KRE134.509.094	09 - 094 (.413)	40	0.013	7 - 8 inches
KRE134.512.114	12 - 114 (.515)	50	0.015	8 - 10 inches
KRE134.512.094	12 - 094 (.415)	40	0.015	7 - 8 inches
KRE134.512.154	12 - 154 (.615)	60	0.015	11 - 13 inches
KRE134.509.114	09 - 114 (.513)	50	0.013	8 - 10 inches

**AIRMIX® ACCESSORIES**

A  
B  
C  
D  
E  
F  
G  
H  
I  
J  
K  
L  
M  
N  
O  
P  
Q  
R  
S  
T  
U  
V  
W  
X  
Y



**Airmix® Fluid Hoses**

- Treated Stainless Steel fittings
- With Spring



Item #	Diameter	Length	PSI	Color
KRE050.450.605	3/16"	25'	3,500	Green
KRE050.450.607	3/16"	50'	3,500	Green



**Airmix® Tip Cleaning Needles**

- Sold 12 per pack (order as 1)



Item #	For Nozzle Size
KRE000.094.000	≤ 0.9mm
KRE000.094.002	≥ 0.9mm



Microscreen



Tip Seals

**Airmix® Microscreens & O-Rings**

- Pack of 10



Item #	Description
KRE129.609.901	Microscreen, for tips #6 and smaller
KRE129.529.903	Tip Seals



**Airmix® Screen for Filter**

- Stainless steel screen for filter
- For gun fluid filter
- Sold by pack of 5



Item #	Description	Size
KRE129.609.908	#6	168 Micron (85 mesh)
KRE129.609.909	#12	280 Micron (60 mesh)

A

**ACCUSPRAY™ ONE, LEGACY VERSION 1.0 PPS™**

B

C

D

E

F

G

H

I

J

K

L

M

N

O

P

Q

R

S

T

U

V

W

X

Y



**Accuspray™ ONE Spray Gun Kit with PPS, Legacy 1.0**



- The Accuspray™ replaceable atomizing head spray gun eliminates spray gun maintenance kits
- Visually confirm the spray gun is clean and offers the performance of a brand new spray gun
- **Includes:** 1 each Accuspray™ ONE Spray Gun with color indicator rings, 4 Accuspray™ atomizing heads in sizes 1.2 mm, 1.3 mm, 1.4mm and 1.8mm, an airflow control valve, 5 each liners and lids (1 each w/ 125 micron filter, 4 each w/ 200 micron filter), 1 each standard size 22oz PPS™ hard cup and retaining ring, 1 mixing/measuring insert and an instruction manual

<b>Item #</b>
MGPPS-16580



**Accuspray™ ONE Replacement Spray Gun, Legacy 1.0**



- 3M™ Accuspray™ ONE Replacement Spray Gun, color indicator rings, nozzle indicator insert, and an airflow control valve
- No atomizing heads are included in this package

<b>Item #</b>
MGPPS-16579



**3M™ Accuspray™ Atomizing Heads, Legacy 1.0**



- Replaceable atomizing heads for use with 3M™ Accuspray™ Spray Guns with replaceable atomizing head technology
- Refill kits contain four atomizing heads

Item #	Color	Size
MH16609	Red Opaque	2.0mm
MH16611	Clear	1.8mm
MH16612	Orange	1.4mm
MH16614	Green	1.3mm
MH16615	Blue	1.2mm



**3M™ PPS™ Adapters, Legacy 1.0**



- 3M makes adapters to convert virtually any spray gun to PPS™
- If yours is not listed below, contact Customer Service with your gun information
- Sold by the each

Item #	Use With		
	CA Tech	Graco	SATAjet
MGPPS-16003	Jaguar, Techline	LT200, LT300	B, B NR-92, B NR-95



**PPS™ ACCESSORIES, LEGACY VERSION 1.0**



Regular Style



H/O Pressure Style

**3M™ PPS™ Cups & Collars, Legacy 1.0**



- Hard cup and collar set that supports and holds the flexible liners used in PPS™

Item #	Description	Box Qty
MGPPS-16115	PPS Cup and Collar, Mini, 6 oz	2 Cups & Collars
MGPPS-16001	PPS Cup and Collar, Standard, 22 oz	2 Cups & Collars
MGPPS-16023	PPS Cup and Collar, Large, 28 oz	1 Cup & Collar
MGPPS-16124	H/O Pressure PPS Cup and Collar, Large, 28 oz	1 Cup & Collar



**3M™ PPS™ Lid & Liner Kits, Legacy 1.0**



- Liners & lids with filters

Item #	Size	Lids per Kit	Liners Per Kit	Plugs per Kit
<b>With 125 Micron Filters</b>				
MGPPS-16300	Standard, 22 oz	50	50	20
<b>With 200 Micron Filters</b>				
MGPPS-16114	Mini, 6 oz	50	50	20
MGPPS-16112	Mid, 13.5 oz	50	50	20
MGPPS-16000	Standard, 22 oz	50	50	20
MGPPS-16024	Large, 28 oz	25	25	10



**3M™ PPS™ Liners, Legacy 1.0 and 2.0**



- Liners only for use with 3M PPS
- Ideal for industrial applications, several repetitive or batch applications
- Compatible with both PPS™Version, Legacy 1.0 and 2.0

Item #	Size	Box Quantity
MGPPS-16348	Mini, 6 oz	100
MGPPS-16350	Standard, 22 oz	100
MGPPS-16351	Large, 28 oz	100

A  
B  
C  
D  
E  
F  
G  
H  
I  
J  
K  
L  
M  
N  
O  
P  
Q  
R  
S  
T  
U  
V  
W  
X  
Y

**A ACCUSPRAY™ ONE, VERSION 2.0 PPS™**



**3M™ Accuspray™ ONE Pro Spray Gun Kits, Version 2.0**

The 3M™ Accuspray™ ONE Spray Gun System with Standard PPS™ Series 2.0 combines the simplicity and easy maintenance of our Accuspray™ spray gun with the material-saving, rapid clean-up convenience of PPS™ Series 2.0, the next generation, highest performing disposable spray cup system. Replaceable atomizing heads afford the performance of a new gun, on demand and at a fraction of the cost.

**Includes:**

**MGPPS-26578**

- Accuspray™ ONE Spray Gun
- Five replaceable atomizing heads in 2.0 mm (red), 1.8 mm (clear), 1.4 mm (orange), 1.3 mm (green) and 1.2 mm (blue) for spraying of primer, sealer, base and clear coat

**MGPPS-26580**

- Same as MGPPS-26578 plus: (1) Air Flow Control Valve, (1) 22 oz. Mixing Cup, (5) each Disposable Lids & Liners, Sealing Plugs

Item #	Description
MGPPS-26578	Gun and Head Kit
MGPPS-26580	Gun Starter Kit, no heads included

A  
B  
C  
D  
E  
F  
G  
H  
I  
J  
K  
L  
M  
N  
O  
P  
Q  
R  
S  
T  
U  
V  
W  
X  
Y



**3M™ Accuspray™ Atomizing Heads, Version 2.0**

- Designed specifically for use with PPS™ Series 2.0 – the next generation, highest performing disposable spray cup system
  - tomizing heads are available in a variety of sizes for spraying of primer, sealer, base and clear coat
  - All atomizing heads are interchangeable for use with Accuspray™ ONE Spray Gun
  - Size is presented clearly on each atomizing head for fast, accurate selection
  - Fast, simple head replacement affords the performance of a brand new spray gun on demand
  - See-through design makes it easy to see when the heads are clean
- Sold in: Full packs of 4 heads.

Item #	Color	Size
MGPPS-26612	Blue	1.2mm
MGPPS-26613	Green	1.3mm
MGPPS-26614	Orange	1.4mm
MGPPS-26618	Clear	1.8mm
MGPPS-26620	Red Opaque	2.0mm

**PERFORMANCE GUN, VERSION 2.0 PPS**



**3M™ PPS™ Performance Spray Gun System, Gravity, Version 2.0**



3M's first ever spray gun designed specifically to save you time while delivering top-of-the-line performance. Its integrated system includes quick-change replaceable atomizing heads and 3M™ PPS™ Series 2.0 Spray Cups, which makes for faster cleanup, changeovers and cycle times.

- Precision spray performance with high transfer efficiency (78%) and large, adjustable fan pattern
- Faster clean up and change overs that can help improve your cycle times
- Lightweight, impact resistant gun (8.4 oz) is made of nylon composite with stainless steel strands for durability
- Can be converted from gravity to pressure style by switching out heads and adding pressure whip
- Quick-change, replaceable atomizing heads connect directly to 3M™ PPS™ Series 2.0 Spray Cup System

**Includes:** 1 spray gun, 1 air control valve, 1 locking collar, 15 gravity atomizing heads, 1 3M™ PPS™ Series 2.0 mixing cup, 5 lids and liners, 3 sealing plugs.

<b>Item #</b>
MGPPS-26778



**3M™ PPS™ Performance Spray Gun System, Gravity / Pressure Version 2.0**



3M's first ever spray gun designed specifically to save you time while delivering top-of-the-line performance. Its integrated system includes quick-change replaceable atomizing heads and 3M™ PPS™ Series 2.0 Spray Cups, which makes for faster cleanup, changeovers and cycle times.

- Precision spray performance with high transfer efficiency (78%) and large, adjustable fan pattern
- Faster clean up and change overs that can help improve your cycle times
- Lightweight, impact resistant gun (8.4 oz) is made of nylon composite with stainless steel strands for durability
- Includes components required to use as either a pressure or gravity gun
- Quick-change, replaceable atomizing heads connect directly to 3M™ PPS™ Series 2.0 Spray Cup System

**Includes:** Spray gun, air control valve, pressure whip, pressure and gravity atomizing heads, PPS Series 2.0 lids, liners and plugs.

<b>Item #</b>
MG26878

A  
B  
C  
D  
E  
F  
G  
H  
I  
J  
K  
L  
M  
N  
O  
P  
Q  
R  
S  
T  
U  
V  
W  
X  
Y

**A PERFORMANCE GUN, VERSION 2.0 PPS**



**3M™ PPS™ Performance Spray Gun Version 2.0**



3M's first ever spray gun designed specifically to save you time while delivering top-of-the-line performance. Its integrated system includes quick-change replaceable atomizing heads and 3M™ PPS™ Series 2.0 Spray Cups, which makes for faster cleanup, changeovers and cycle times.

- Precision spray performance with high transfer efficiency (78%) and large, adjustable fan pattern
- Lightweight, impact resistant gun (8.4 oz) is made of nylon composite with stainless steel strands for durability
- Quickly converts between pressure-fed systems and gravity-fed 3M™ PPS™ Series 2.0 Spray Cup System

**Includes:** Spray gun and air control valve only.

<b>Item #</b>
MGPPS-26832

**J 3M™ Performance Atomizing Heads Version 2.0**



- Quick-change nozzles for spraying a wide range of coatings
- Like-new spray performance with each new atomizing head
- Use exclusively with the 3M™ Performance Spray Gun and 3M™ PPS™ Series 2.0 Spray Cup System

**Packing:**

**Gravity Heads:** 5 per pack. Variety pack contains 1 of each Gravity Head, 6 heads total.

**Pressure Heads:** 10 per pack. Variety pack contains 2 of each Pressure Head, 6 heads total.



Color	Size	Gravity Head Item #	Pressure Head Item #
Red	2.0mm	MG26720	-
Clear	1.8mm	MG26718	MGPPS-26818
Purple	1.6mm	MG26716	-
Orange	1.4mm	MG26714	MGPPS-26814
Green	1.3mm	MG26713	-
Blue	1.2mm	MG26712	-
Yellow	1.1mm	-	MGPPS-26811
Variety Pack	See above	MG26730	MGPPS-26830

**T 3M™ Performance Gun Accessories Version 2.0**



- Accessories for use with 3M™ Performance Gun, Version 2.0

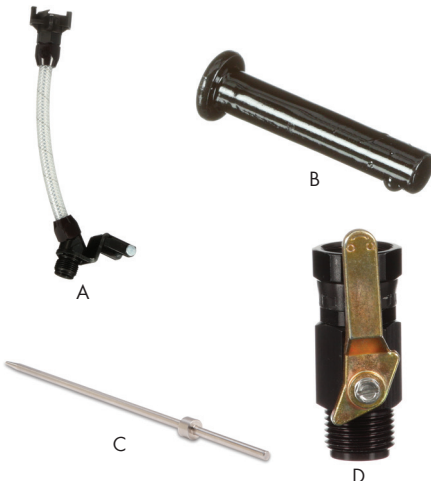

	Item #	Description
A	MGPPS-26833	Pressure Whip
B	MGPPS-26834	Pressure Whip Pin (4 pack)
C	MGPPS-26838	Spray Gun Needle, Stainless Steel
D	MGPPS-26839	Pressure Gun Ball Valve

## PPS™ ACCESSORIES, VERSION 2.0



### 3M™ PPS™ Cups, Version 2.0



- Hard cups designed specifically for 3M™ PPS™ Series 2.0
- Mix ratios built into every hard cup – no need for separate inserts
- Clear access window lets you firmly grasp the liner, making lid removal easier during tinting/refilling
- ‘Max Fill’ notation allows users to fit maximum amount of fluid in cup
- Designed for use with quarter-turn PPS™ Series 2.0 lid locking system for faster, easier assembly
- Sold by the box

Item #	Description	Box Qty
MGPPS-26115	PPS Cup only, Mini, 6 oz	2
MGPPS-26122	PPS Cup only, Midi, 13.5 oz	2
MGPPS-26001	PPS Cup only, Standard, 22 oz	2
MGPPS-26023	PPS Cup only, Large, 28 oz	2



### 3M™ PPS™ Cup, Lid & Liner Kits, Version 2.0



- 1 reusable paint cup, 50 lids, 50 liners and 32 sealing plugs
- With each lid you get an integrated quarter-turn locking collar, which helps eliminate cross-threading and paint buildup, and a built-in filter, commonly used for solvent-based paint coatings

Packing & Sold In: Full kits as shown below.

Size	Item # (with 125 Micron Filters)	Item # (with 200 Micron Filters)
Micro, 3 oz.	MGPPS-26328	MGPPS-26028
Mini, 6 oz.	MGPPS-26314	MGPPS-26114
Midi, 13.5 oz	MGPPS-26312	MGPPS-26112
Standard, 22 oz.	MGPPS-26301	MGPPS-26000
Large, 28 oz.	MGPPS-26325	MGPPS-26024



### 3M™ PPS™ Liners, Legacy 1.0 and 2.0



- Liners only for use with 3M PPS
- Ideal for industrial applications, several repetitive or batch applications
- Compatible with both PPS™Version, Legacy 1.0 and 2.0

Item #	Size	Box Quantity
MGPPS-16348	Mini, 6 oz	100
MGPPS-16350	Standard, 22 oz	100
MGPPS-16351	Large, 28 oz	100

**PPS™ ACCESSORIES, VERSION 2.0 & SPRAY BOOTH ACCESSORIES**

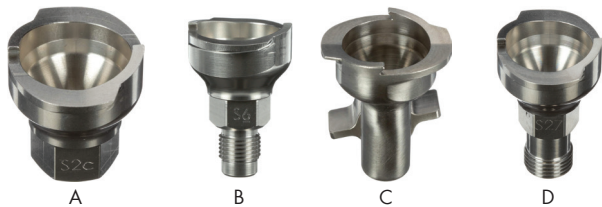

**3M™ PPS™ Adapters, Version 2.0**



- 3M makes adapters to convert virtually any spray gun to PPS™
- If yours is not listed below, contact Customer Service with your gun information
- Sold by the each

		Use With					
Item #	Binks	CA Tech	Graco	Kremlin	SATAjet	Iwata	
A	MGPPS-26003	-	Jaguar J100H, SLP, 100C, 300C, Techline T3	LT200, LT300	-	B, B NR-92, B NR-95	-
B	MGPPS-26007	-	-	-	M21-G, M22, Hi-G, S3G HPA	-	-
C	MGPPS-26054	95, 95 SL, 95 SLV, Mach 1, Mach 1SL, Mach 1 FeatherLite, 2001, 2001 SS, 2001 V, 7, SV-100 Siphon	Panther P100G	AirPro Siphon, FinishPro HVLP Edge	-	H	-
D	MGPPS-26119	BHV, SV-50 Pro Series	-	-	-	-	-
E	MGPPS-26103	-	-	-	-	-	LPSI, W101 Siphon, W200 Siphon, W77 Siphon & Pressure
F	MGPPS-26127	-	-	-	-	-	LPH-80 Mini



**3M™ Dirt Trap Protection Material**



- Non-woven surface protection material with adhesive backing
- Designed to protect surfaces while trapping dust, dirt, and paint overspray
- Applicators available Special Order

Item #	Size	Color	Application
MH36851	14" x 300'	White	Floors/Walls
MH36852	28" x 300'	White	Floors/Walls
MH36853	56" x 300'	White	Floors/Walls



**Spray Booth Floor Paper, Flame Retardant**



- 100 lb. flame retardant floor paper for spray booth floor applications
- Bright white color, excellent strength characteristics

Item #	Roll Size
CHE36KSFRP36X300	36"W x 300'L
CHE42KSFRP42X300	42"W x 300'L
CHE60KSFRP60X300	60"W x 300'L
CHE72SKFRP72X300	72"W x 300'L

**SPRAY BOOTH ACCESSORIES**

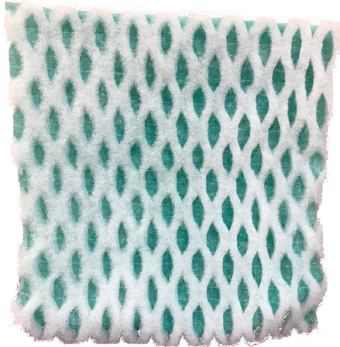

**Paint Pockets® Overspray Arrestors**



- Unique design holds up to five times more overspray than other filters
- Enables you to cut your filter changes by up to 80%
- The three dimensional “pockets” embedded in the front face more than double its surface area, allowing the arrestor to capture and hold very large quantities of overspray
- Sold by the box

Item #	Size	Color	Efficiency	Box Qty
PP-020-020-030	20" x 20"	White	99.84%	30
PP-020-025-040	20" x 25"	Green	99.43%	40
YPPP	20" x 20"	Green	99.43%	40



**Fiberglass Paint Arrestors  
Mono-Heavy Duty Applications**



- 2" thick white fiberglass media filter
- 98.7% efficiency rating
- Open weave design, protects depth loading
- 100 each per box. Sold in full boxes only

Item #	Size	Box Qty
CHEMP20252	20"H x 25"W x 2"Thick	100 each



**Duo Fiberglass Paint Arrestor Pads**



- Features a progressive density construction that meets the needs of the widest variety of finishing applications
- Designed to provide longevity, efficiency and economy for most painting applications at a 98.21% efficiency rating
- 100 each per box. Sold in full boxes only

Item #	Size
CHE2020100DP	20" x 20" x 2"
CHE2025100DP	20" x 25" x 2"

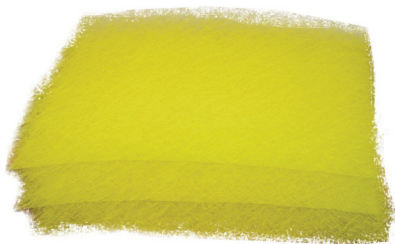

**Exhaust Media, FMP-18, 99.23% Efficiency**



- Applications: All coatings and finishes
- 2.5" thick, highly visible yellow fiberglass fiber
- Open weave design, promotes depth loading
- Unique fiber construction for increased area and air flow
- 100 each per box. Sold in full boxes only

Item #	Size
CHEFMP18-20202	20" x 20" x 2.5"
CHEFMP18-20252	20" x 25" x 2.5"

NOTE: Also available in pre-packaged blanket or roll goods - contact your sales rep or customer service for pricing and availability.

A  
B  
C  
D  
E  
F  
G  
H  
I  
J  
K  
L  
M  
N  
O  
P  
Q  
R  
S  
T  
U  
V  
W  
X  
Y

## A SPRAY BOOTH ACCESSORIES

B  
C  
D  
E  
F  
G  
H  
I  
J  
K  
L  
M  
N  
O  
P  
Q  
R  
S  
T  
U  
V  
W  
X  
Y



### Exhaust Media, N Poly (Poly Media)

#### 99.93% Efficiency

- Applications: General spray applications
- Good for both liquid and powder coating
- Enhanced efficiency compared to fiberglass
- 50 each per box. Sold in full boxes only



NOTE: Also available in pre-packaged blanket or roll goods – contact your sales rep or customer service for pricing and availability.

Item #	Size	Box Qty
CHENPOLY-20201	20" x 20" x 2"	50 each
CHENPOLY-20251	20" x 25" x 2"	50 each

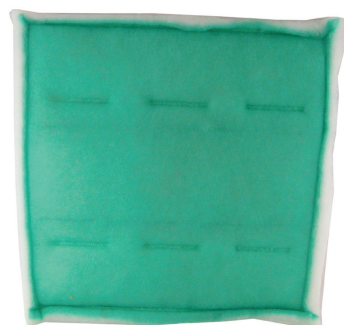

### Intake Media, Panel Filter

- Applications: Spray booth intake filter
- Polyester filter with internal frame
- Tackified polyester intake media for greater efficiency
- 20 each per box. Sold in full boxes only



Item #	Size	Box Qty
CHEPAFIF-20202	20" x 20" x 2"	20 each
CHEPAFIF-20252	20" x 25" x 2"	20 each



### Exhaust Media, Chemloft Poly, 99.98% Efficiency

- Applications: Wide range of coating applications
- 2" thick white filter media pad
- High loft for extended service life and efficiency
- Rapidly eliminates most by-pass challenges
- Serves as a liquid paint arrestor and powder coating pre-filter
- 25 each per box. Sold in full boxes only



NOTE: Also available in pre-packaged blanket or roll goods – contact your sales rep or customer service for pricing and availability.

Item #	Size	Box Qty
CHECLOFT-20202	20" x 20" x 2"	25 each
CHECLOFT-20252	20" x 25" x 2"	25 each