

Installation Instructions

721DW

Typical Installation

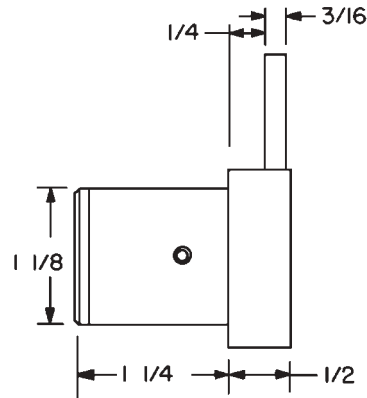
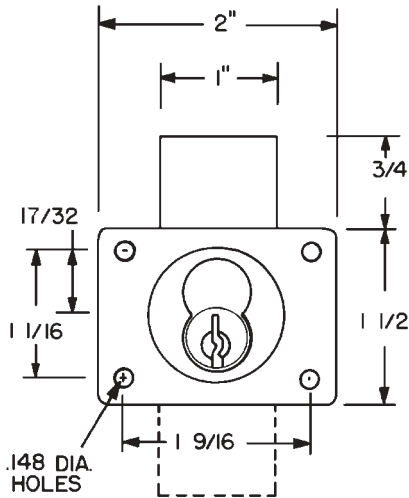
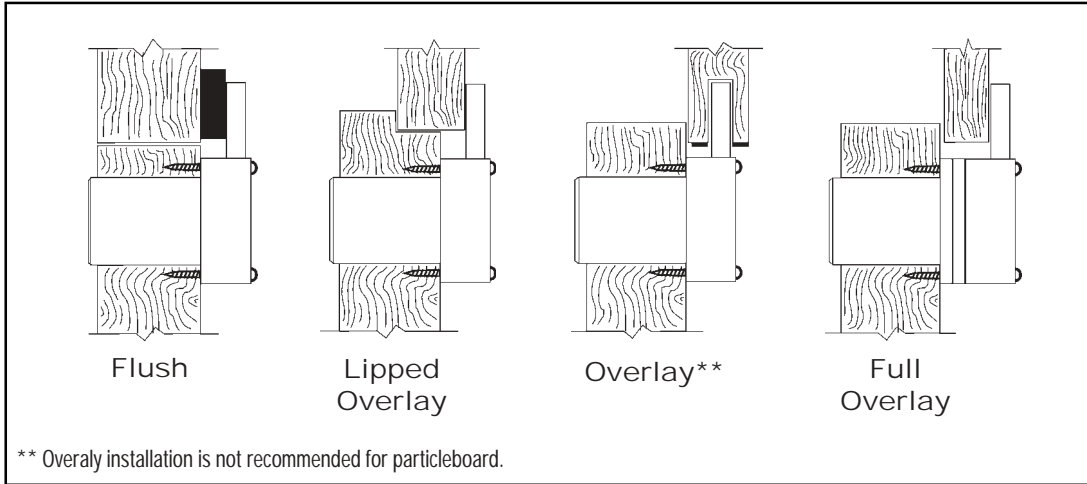

Use of spacers and strikes depends on application and material thickness.

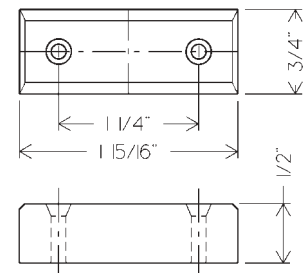

10-055 - 1/2" bar strike

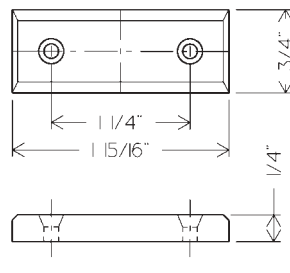

10-054 - 1/4" bar strike

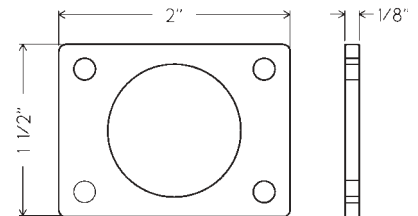

10-350 - 1/8" spacer

Title

Installation instructions for 721DW series cabinet lock

Series

721DW

Barrel Length

1-1/4"

Bolt type

Deadbolt

Mounting

Surface

Revision Date

06/2004

OLYMPUS
LOCK, INC.