

REDUCED DEPTH SINGLE 32 QT WASTE CONTAINER

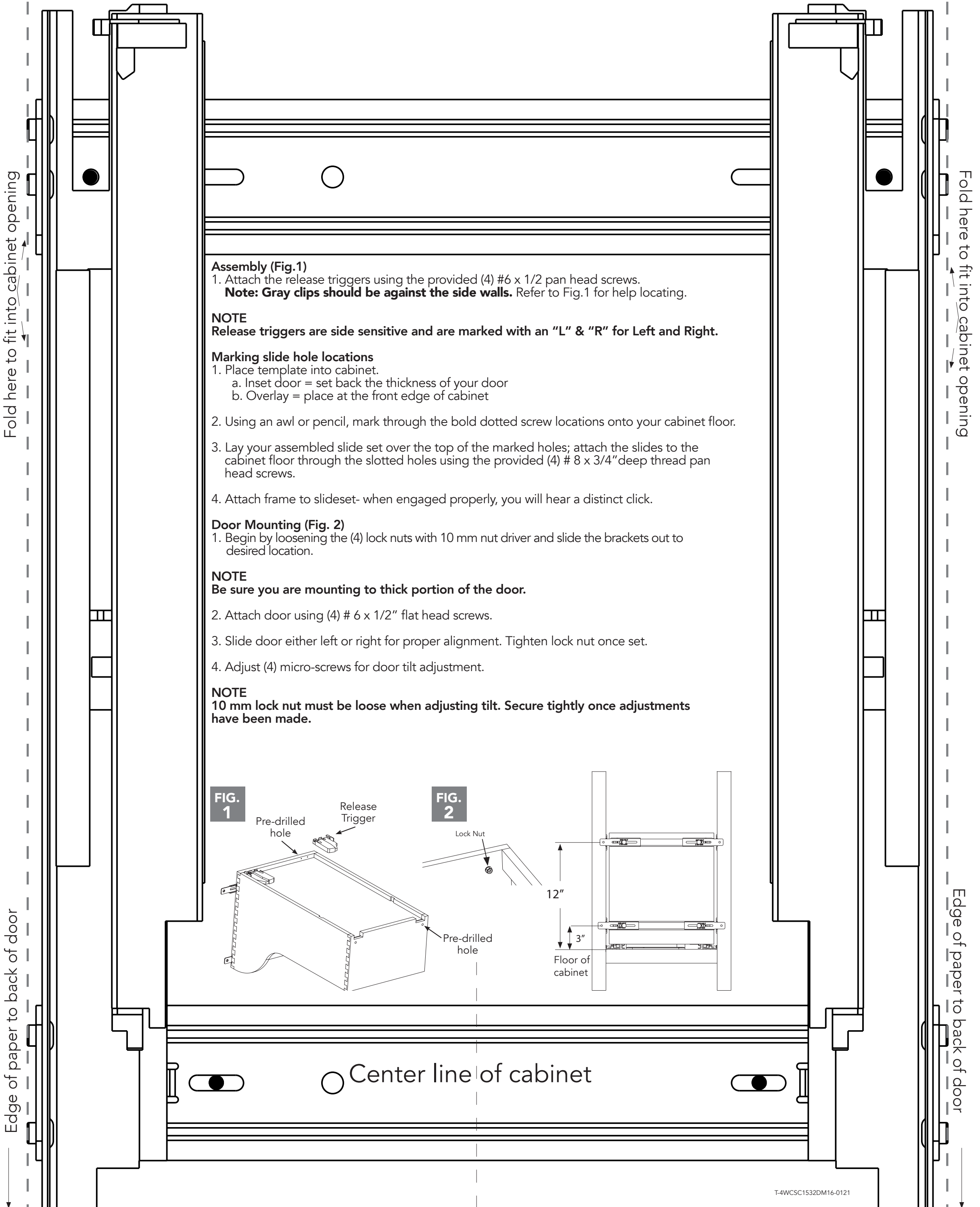

Assembly (Fig.1)

1. Attach the release triggers using the provided (4) #6 x 1/2 pan head screws.

Note: Gray clips should be against the side walls. Refer to Fig.1 for help locating.

NOTE

Release triggers are side sensitive and are marked with an "L" & "R" for Left and Right.

Marking slide hole locations

- Place template into cabinet.
 - Inset door = set back the thickness of your door
 - Overlay = place at the front edge of cabinet
- Using an awl or pencil, mark through the bold dotted screw locations onto your cabinet floor.
- Lay your assembled slide set over the top of the marked holes; attach the slides to the cabinet floor through the slotted holes using the provided (4) # 8 x 3/4" deep thread pan head screws.
- Attach frame to slideset- when engaged properly, you will hear a distinct click.

Door Mounting (Fig. 2)

1. Begin by loosening the (4) lock nuts with 10 mm nut driver and slide the brackets out to desired location.

NOTE

Be sure you are mounting to thick portion of the door.

- Attach door using (4) # 6 x 1/2" flat head screws.
- Slide door either left or right for proper alignment. Tighten lock nut once set.
- Adjust (4) micro-screws for door tilt adjustment.

NOTE

10 mm lock nut must be loose when adjusting tilt. Secure tightly once adjustments have been made.

