



PREMIERE CHROME LAZY SUSANS 20" REVOLVING D-SHAPE INSTALLATION INSTRUCTIONS

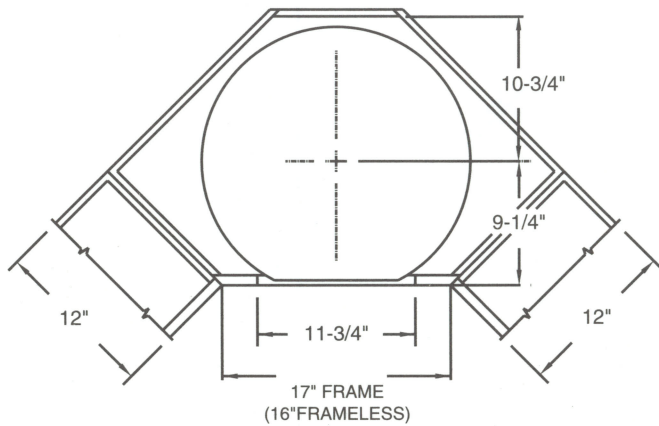

FIGURE 1

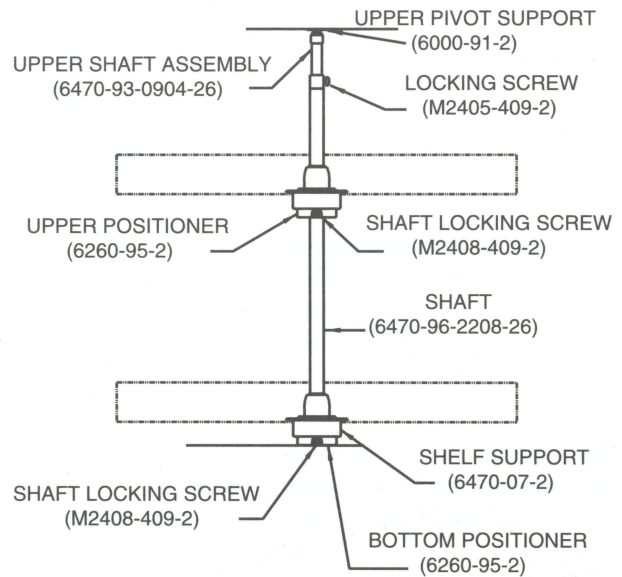

FIGURE 2

1. The dimensions shown in Figure 1. are minimum.
2. With bottom and upper pivot supports installed (see reverse side), begin assembling the shelves and the main shaft. Working from bottom up, inside the cabinet space, slide the upper shelf onto the shaft. Slide the upper positioner onto the shaft and temporarily tighten the screw with the positioner approximately 15" from the bottom of the shaft. Slide the bottom shelf onto the shaft.
3. Insert the upper shaft assembly into the top end of the shaft. Loosely install the lock screw. Insert the shaft/tray assembly into the bottom positioner. Extend the upper shaft assembly to engage the upper pivot support (See Figure 2).
4. Adjust the upper shelf position by grasping and supporting the upper shelf positioner assembly while loosening the locking screw. Rotate the positioner and shelf into alignment and securely tighten the locking screw.

INSTALLATION TEMPLATE
 ON REVERSE SIDE.

PREMIERE CHROME LAZY SUSANS
**20" REVOLVING
 D-SHAPE**
 INSTALLATION TEMPLATE

BOTTOM POSITIONER ASSEMBLY
 MOUNTING HOLE PATTERN

UPPER PIVOT SUPPORT
 MOUNTING HOLE PATTERN

NOTES:

1. Before drilling holes, make sure there will be adequate clearance at the back of the shelf assembly (see Figure 1, reverse side).
2. Use 1/8" drill for all pilot holes.
3. Using a square, from the front edge, locate the cabinet centerline perpendicular to it.
4. Place the template on the cabinet floor and align the template centerline with the cabinet centerline (at the front edge). Tape in position.
5. Spot the mounting hole locations with a nail or punch, remove the template, and then drill 1/8" (max) pilot holes.
6. Using (4) 3/4 x #8 oval hd. screws (P/N F1208-13-2), install the positioner base (P/N 6260-95-2), making sure the adjustment screw (P/N M2408-409-2), is facing to the front. See Figure 2 of instructions.
7. Using (4) 1/2 x #8 oval hd. screws (P/N F0808-13-2), repeat Steps (3 thru 5) at the top of the cabinet and install the upper pivot support (P/N 6000-91-2).

9-1/4"

CABINET
 CENTERLINE

PRINTED IN U.S.A.

I-5272-20

FRONT OUTSIDE EDGE OF CABINET